



**WHITEHORNS**

Buy. Sell. Let. Relax!

0114 268 8533  
info@whitehorns.com  
www.whitehorns.com

**1 Springfield Avenue, Millhouses**

Sheffield

Guide Price £425,000-£450,000



# 1 Springfield Avenue

Millhouses, Sheffield

An incredibly rare opportunity has arisen to purchase this lovely three bedroom, two bathroom, bay windowed, detached family home. Offered to the open market with the benefit of no upward chain and vacant possession, the property offers vast as yet unexplored potential to further extend to the loft side and rear (subject to planning) to create a forever family home. With off road parking to the front, wonder for rear garden and lovely views it's easy to say this property will be super popular with the growing family market and simply must be viewed to see the full potential on offer. Located on this well regarded residential road within the very heart of Millhouses number 1 enjoys excellent schooling catchments including Dodcroft juniors, Silverdale and Mercia secondary.

Council Tax band: D

Tenure: Freehold

- THREE BEDROOM TWO BATHROOM DETACHED FAMILY HOME
- INCREDIBLY RARE OPPORTUNITY TO MARKET
- HUGE POTENTIAL TO EXTEND TO THE SIDE LOFT AND REAR SUBJECT TO PLANNING
- FANTASTIC VIEWS TO THE FRONT
- EXCELLENT SCHOOLING CATCHMENTS INCLUDING DOBCROFT SILVERDALE AND MERCIA SECONDARY
- AVAILABLE WITH NO ONWARD CHAIN INVOLVED
- HEART OF ULTRA POPULAR MILLHOUSES SUBURB
- PERFECT FOR THE GROWING FAMILY LOOKING FOR A FOREVER FAMILY HOME









## Ground Floor

Approx. 53.9 sq. metres (579.7 sq. feet)

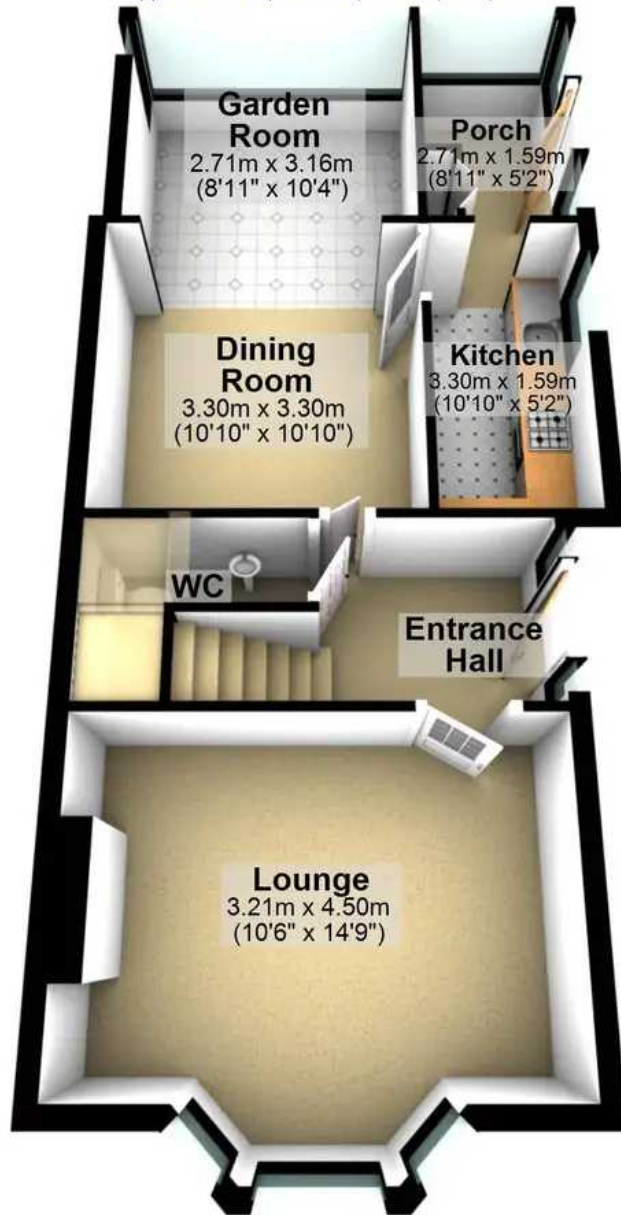

## First Floor

Approx. 39.9 sq. metres (429.4 sq. feet)

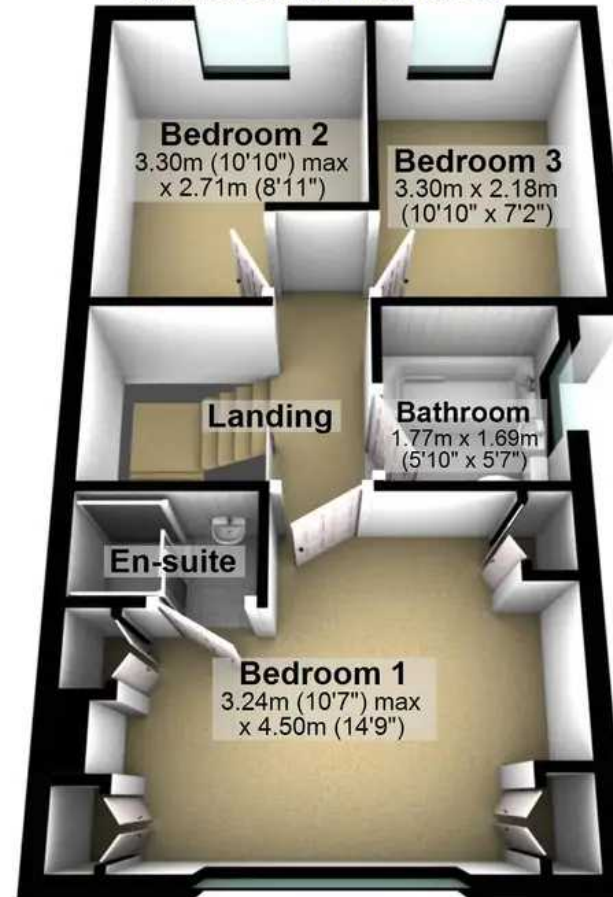

Total area: approx. 93.7 sq. metres (1009.1 sq. feet)

All measurements are approximate  
Plan produced using PlanUp.



**WHITEHORNES**

Buy. Sell. Let. Relax!

0114 268 8533  
info@whitehorns.com  
www.whitehorns.com