



WHITEHORNS

Buy. Sell. Let. Relax!

0114 268 8533
info@whitehorns.com
www.whitehorns.com



79 Lingfoot Crescent, Sheffield

Sheffield

Offers in Region of **£155,000**

79 Lingfoot Crescent

Sheffield, Sheffield

Situated in a desirable neighbourhood of Jordanthorpe, this three-bedroom mid-terraced property offers an ideal living space for first-time buyers or growing families alike. The accommodation spans across two floors totalling 1009 SQ FT, providing a spacious living area suitable for a variety of needs. In brief, this freehold property consists of a porch, well-appointed kitchen, cloakroom, lounge and dinner, 3 double bedrooms, family shower room and not to forget a key feature of this property is a stunning conservatory to the rear which opens on to a large, enclosed garden with decking. To the front is easy ample on street parking. This property is within the catchment area of reputable local schools, including Meadowhead Secondary School and King Ecgbert School, making it an ideal choice for families with children. Viewing is highly recommended to truly appreciate the features of this property.

Council Tax band: A

Tenure: Freehold

- THREE BEDROOMED MID TERRACED PROPERTY TOTALLING 1009 SQ FT
- IDEAL FOR FIRST TIME BUYERS OR GROWING FAMILIES ALIKE
- EASY AMPLE ON STREET PARKING
- CLOSE TO NUMEROUS LOCAL AMENITIES AND TRANSPORT LINKS
- SPACIOUS ACCOMODATION ACROSS 2 FLOORS TOTALLING AN IMPRESSIVE 1009 SQ FT





Ground Floor

Approx. 56.7 sq. metres (610.8 sq. feet)

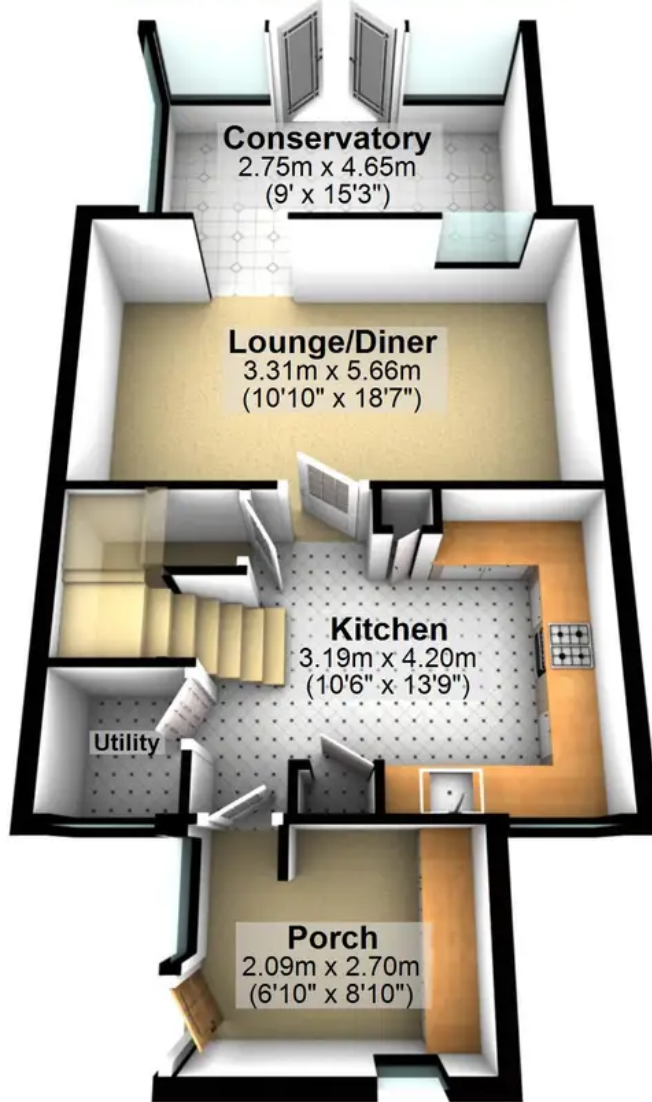

First Floor

Approx. 37.0 sq. metres (398.2 sq. feet)

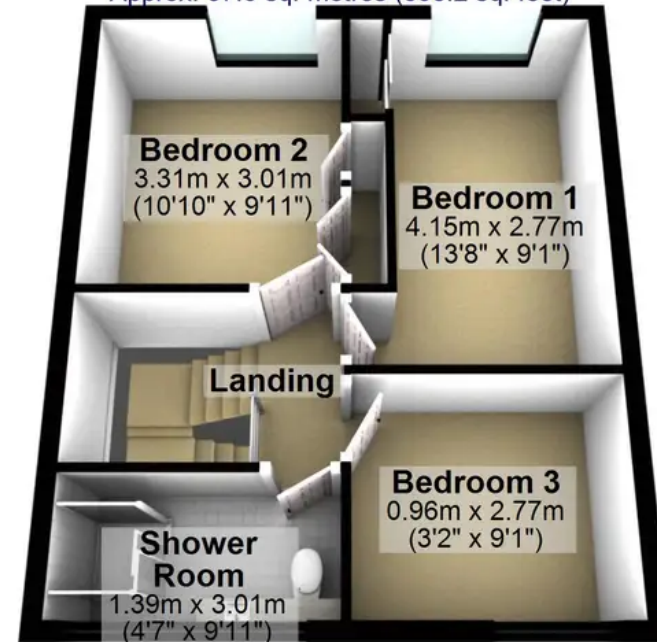

Total area: approx. 93.7 sq. metres (1009.0 sq. feet)

All measurements are approximate
Plan produced using PlanUp.