



WHITEHORNES

Buy. Sell. Let. Relax!

0114 268 8533
info@whitehorses.com
www.whitehorses.com

42 Bradway Close, Bradway

Sheffield

Offers in Region of £155,000

42 Bradway Close

Bradway, Sheffield

Located in the heart of the sought-after area of Bradway, this tastefully finished three-bedroomed top-floor apartment offers light and spacious accommodation, totalling a generous 639 sq. ft. Ideal for first-time buyers or downsizing couples, this property presents an excellent opportunity to reside in a highly desirable neighbourhood. This leasehold property briefly consists of a kitchen, open lounge/diner, 3 well appointed bedrooms and a bathroom. Situated in a prime location this property benefits from numerous local amenities close by including Dore and Totley Railway Station, top local schooling catchments and the peak district a short walk away. This light and spacious accommodation totals an impressive 639 SQ FT. Viewing is essential to see the full potential on offer.

Council Tax band: A

Tenure: Leasehold

- THREE BEDROOMED TOP FLOOR APARTMENT
- LIGHT AND SPACIOUS ACCOMODATION TOTALLING 639 SQ FT
- IDEAL FIRST BUY OR DOWNSIZING COUPLE
- HEART OF SOUGHT AREA LOCATION BRADWAY
- EXCELLENT LOCAL SCHOOL CATCHMENTS
- TASTEFULLY FINISHED THOUGHOUT BY THE CURRENT VENDORS
- VIEWING ADVISED TO SEE THE FINISH ON OFFER
- CLOSE TO NUMEROUS LOCAL AMENITIES INCLUDING DORE AND TOTLEY RAILWAY STATION
- PEAK DISTRICT ON THE DOOR STEP
- LEASEHOLD APARTMENT AND COUNCIL TAX BAND A





Top Floor

Approx. 59.4 sq. metres (639.3 sq. feet)

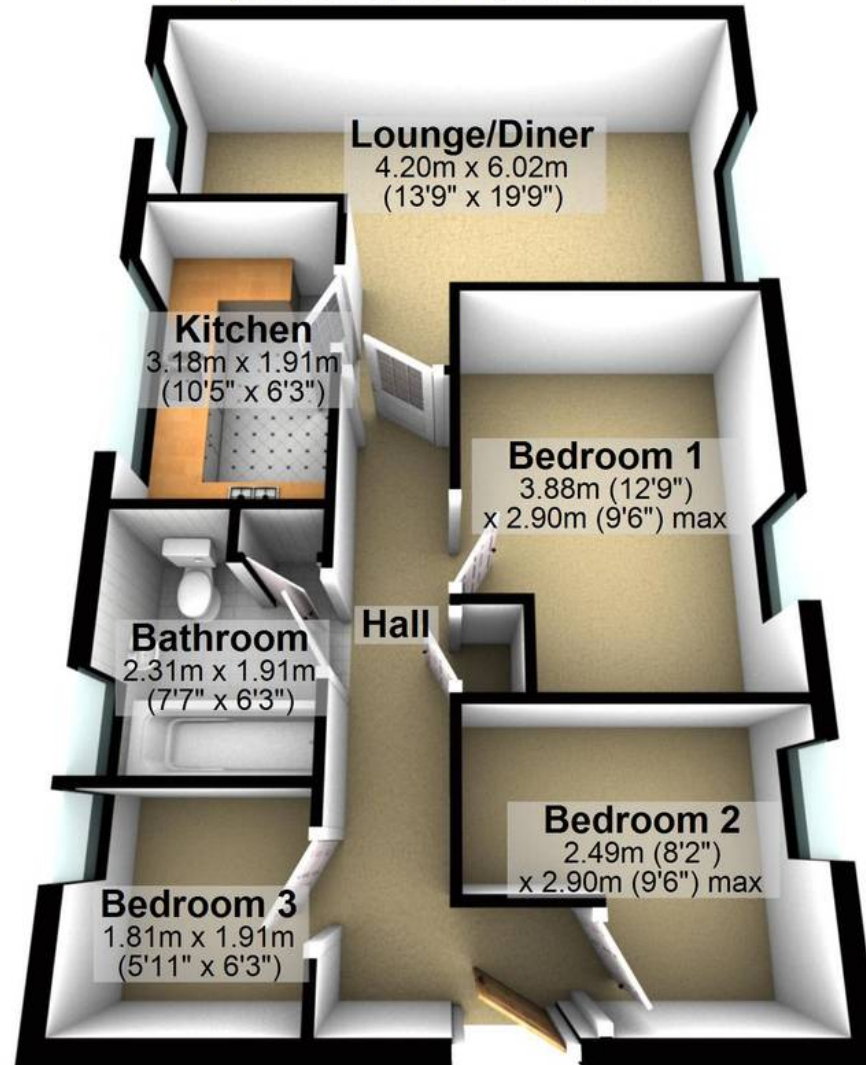

Total area: approx. 59.4 sq. metres (639.3 sq. feet)

All measurements are approximate
Plan produced using PlanUp.



WHITEHORNES

Buy. Sell. Let. Relax!

0114 268 8533
info@whitehorns.com
www.whitehorns.com