



**WHITEHORNS**

Buy. Sell. Let. Relax!

0114 268 8533  
info@whitehorns.com  
www.whitehorns.com

**801 Ecclesall Road, Ecclesall**

Sheffield

**Guide Price £300,000 – £315,000**

# 801 Ecclesall Road

Ecclesall, Sheffield

Standing in this elevated position and enjoying some fine views to both the front and rear together with ensuring a huge degree of privacy is this substantial, four double bed roomed, bay windowed, stone fronted, Victorian villa terraced. Offering one the largest style of terrace on the road that ensures an incredibly spacious and light feel throughout the three floors of accommodation that total an impressive 1,531 sq feet and allow further potential to convert the existing basement if required. With informal parking on a private road to the rear, single rear off shot opened up kitchen in to diner and private garden this property is perfect for the family or professional couple alike.

Council Tax band: B

Tenure: Freehold

- FABULOUS FOUR DOUBLE BEDROOM STONE FRONTED VILLA TERRACE
- ELEVATED POSITION ENSURING PRIVACY AND FAR REACHING VIEWS TO THE FRONT
- OFF SHOT OPEN PLAN REAR KITCHEN THROUGH DINING ROOM
- NEWLY FITTED BATHROOM AND KITCHEN
- GREYSTONES JUNIOR AND HIGH STORRS SECONDARY CATCHMENTS
- PRIVATE REAR GARDEN AND EASY ON ROAD PARKING TO THE FRONT
- FINISHED INTERNALLY TO A SUPER HIGH STANDARD BY THE CURRENT VENDORS
- FOUR IMPRESSIVE FLOORS OF ACCOMMODATION TOTALLING 1,531 SQ FEET
- HEART OF ULTRA POPULAR ECCLESALL WITH ENDCLIFFE PARK AND SHARROW VALE A SHORT STROLL





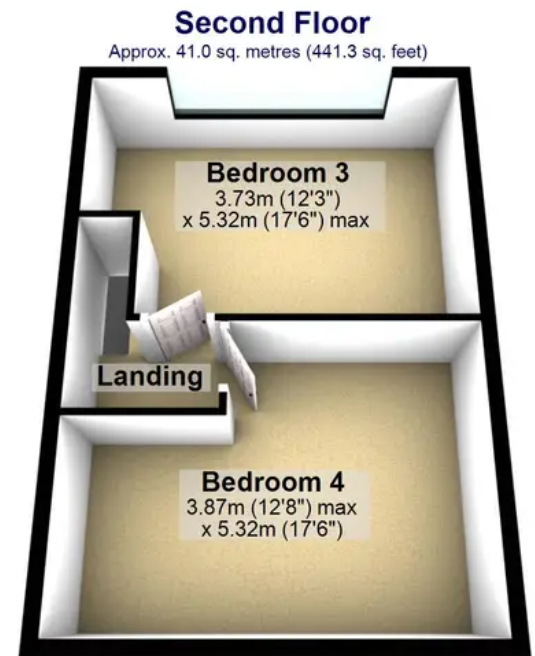
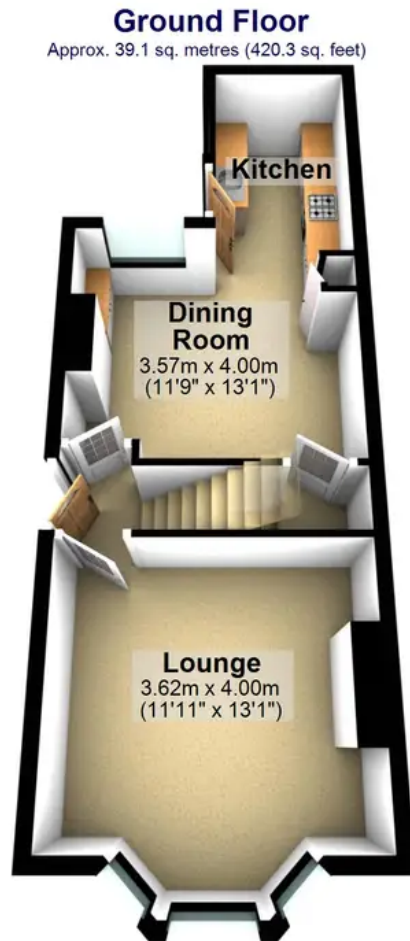
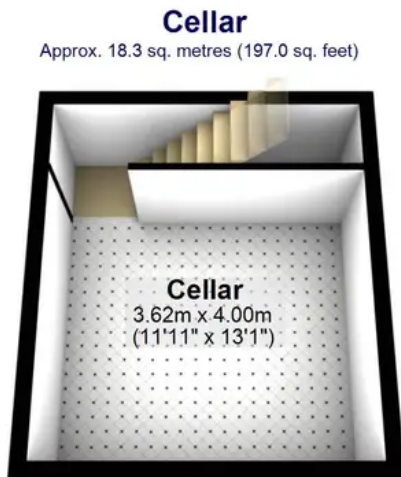

Total area: approx. 142.3 sq. metres (1531.6 sq. feet)

All measurements are approximate  
Plan produced using PlanUp.



0114 268 8533  
info@whitehornes.com  
www.whitehornes.com