

Peterborough
Telephone: 01733 560 650
Email: Sales@RegalPark.co.uk
RegalPark.co.uk

7 Office Village, Cygnet Park, Peterborough, PE7 8GX



Talbot Close, Burton Latimer, Kettering, NN15 5ZF
Price £117,000
Leasehold

45% SHARED OWNERSHIP* *IDEAL FIRST TIME PURCHASE* *NO CHAIN

Regal Park are pleased to offer this SHARED OWNERSHIP 3 Bedroom Semi Detached House in the popular location of Burton Latimer. The property is situated close to local amenities and is within easy access to A14. The property comprises; Entrance Hall, Lounge, Cloakroom, Kitchen/Dining Room, 3 Bedrooms and a Bathroom.

There is a Driveway to the side providing off road parking and good size enclosed rear garden.

Viewings Highly Recommended.
NO CHAIN.

The rent for the remaining 55% Share is: £387.38
Buildings Insurance is £7.26
Monthly Service Charge of £9.91 is also payable
Management Charge of £25.95 is also payable

EPC Rating: B

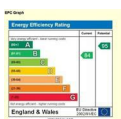

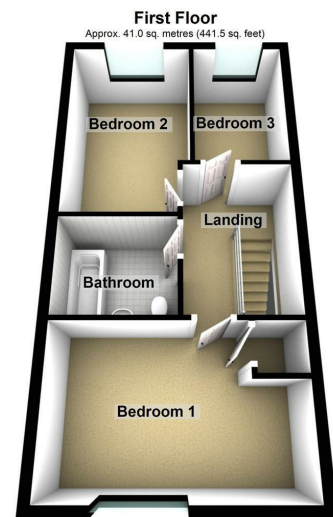
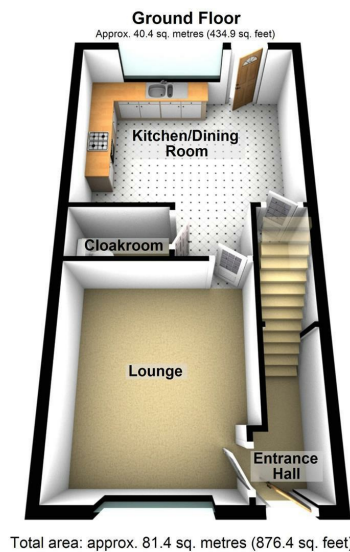

Entrance Hall

Radiator, LVT flooring, stairs, door to:

Lounge

13'1" x 11'3" max (3.99m x 3.43m max)

UPVC double glazed window to front, radiator, fitted carpet, telephone point, TV point, door to:

Kitchen/Dining Room

12'3" x 14'10" (3.73m x 4.53m)

Fitted with a matching range of base and eye level units with worktop space over, stainless steel sink unit with mixer tap, wall mounted combination boiler, plumbing for washing machine, space for fridge/freezer, fitted eye level electric fan assisted oven, built-in four ring gas hob with extractor hood over, uPVC double glazed window to rear, double radiator, LVT flooring, under-stairs storage cupboard, uPVC double glazed door to garden, door to:

Cloakroom

Fitted with two piece suite comprising, wall mounted wash hand basin and close coupled WC, radiator, LVT flooring.

Stairs and Landing

Radiator, fitted carpet, access to loft, door to:

Bedroom 1

9'7" x 14'9" max (2.92m x 4.50m max)

UPVC double glazed window to front, radiator, fitted carpet, over-stairs storage cupboard.

Bedroom 2

13'0" x 8'2" (3.96m x 2.49m)

UPVC double glazed window to rear, radiator, fitted carpet.

Bedroom 3

9'4" x 6'3" (2.85m x 1.90m)

UPVC double glazed window to rear, radiator, fitted carpet.

Bathroom

Fitted with three piece suite comprising deep panelled bath with shower over and glass screen, pedestal wash hand basin and close coupled, tiled surround, radiator, LVT flooring.

Outside

There is a Driveway to the side providing off road parking.

The rear garden has a patio area, lawn area, outside tap, outside lighting, shed, gated side access.

Shared Ownership Costs

The rent for the remaining 55% Share is: £387.38

Buildings Insurance is £7.26 per month

Monthly Service Charge of £9.91 is also payable

Management Charge of £25.95 is also payable