

Green Lane

£1,500 Per Month

SHORT TERM LET FOR 3-4 MONTHS: Cosway Estates are pleased to offer this beautifully presented larger than average one double bedroom 1st floor apartment (with lift) in this popular well sought-after modern development conveniently situated equidistant from both Stanmore and Edgware Tube stations and in walking distance to the local amenities. The property offers a spacious reception room with south facing balcony and flooded with natural light; stylish fitted kitchen; double bedroom with fitted wardrobes and a wonderful bathroom with a walnut look combination vanity W.C. Further benefits include an allocated parking space in the secure underground car park and communal gardens. There is also free use of the onsite gym. **AVAILABLE JUNE 2025.** Viewings highly advised.

Viewing

Please contact our Mill Hill Office on 02089590011 if you wish to arrange a viewing appointment for this property or require further information.



1



1



1



B

Floor Plan

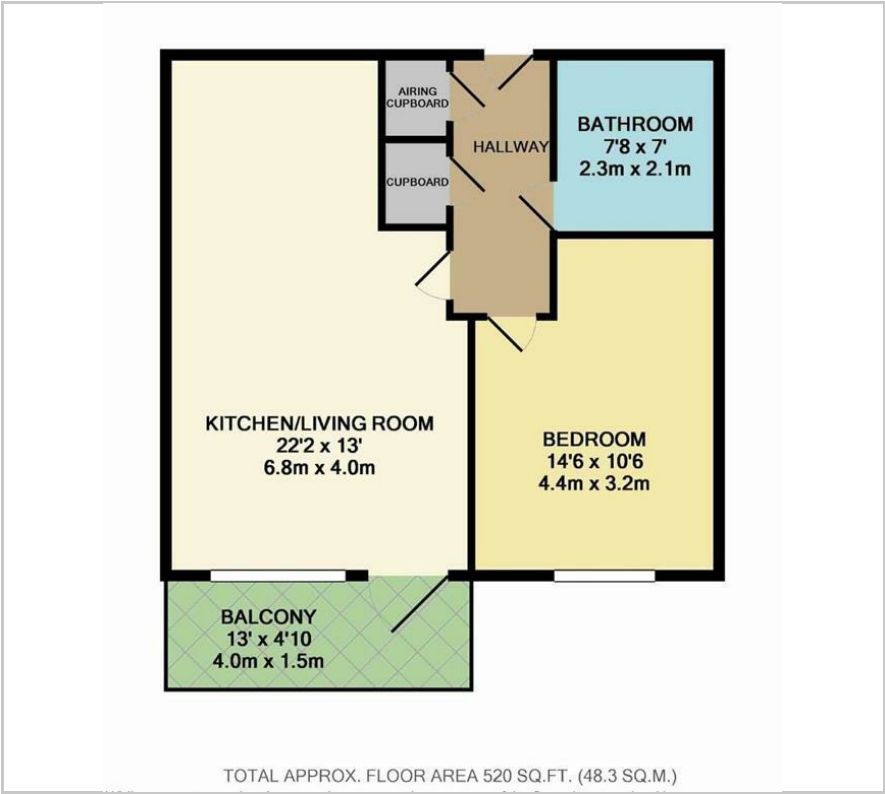

Area Map

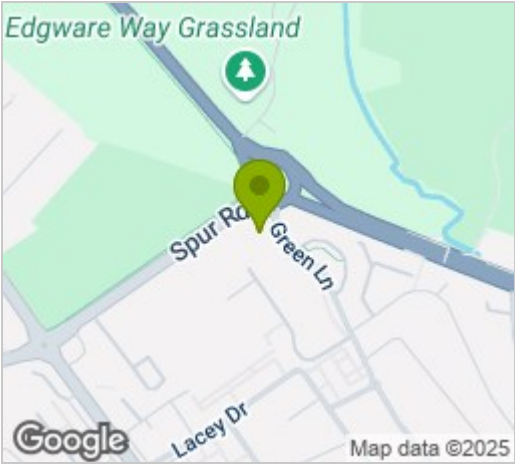

Energy Efficiency Graph

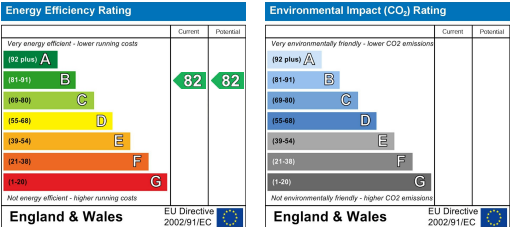

These particulars, whilst believed to be accurate are set out as a general outline only for guidance and do not constitute any part of an offer or contract. Intending purchasers should not rely on them as statements of representation of fact, but must satisfy themselves by inspection or otherwise as to their accuracy. No person in this firm's employment has the authority to make or give any representation or warranty in respect of the property.