



Guardhouse Way

£995,000

Circa 2000 Sq Ft - A well presented, spacious 4-bedroom, 3-bathroom family homes, built in 2017 and situated on a block-paved street in Milbrook Park an area that offers many green spaces.

The accommodation arranged over 3 floors comprises of almost 2000 sq. Feet including a good-sized open-plan kitchen/ dining / reception area featuring ample kitchen storage, fully integrated appliances and a peninsula breakfast bar. Bi-Fold doors lead from the room onto the garden, seamlessly connecting indoor and outdoor living. Additionally, on the ground floor there is a versatile study/playroom, a utility cupboard and a cloakroom with a W/C.

The first floor provides the main reception room, a perfect space for entertaining or to be used as a TV room, complete with a full-width balcony overlooking the garden. This floor also includes a small double bedroom and a large double bedroom with a Jack-and-Jill en-suite bathroom.

The second-floor houses two impressive double bedrooms, each with en-suite shower rooms, providing ample space and privacy for family members or guests.

The property further benefits from driveway parking for one car and a garage accessible from the rear garden. This home combines the charm of traditional design with contemporary comforts, making it an ideal space for modern family living. Chain Free

Viewing

Please contact our Mill Hill Office on 02089590011 if you wish to arrange a viewing appointment for this property or require further information.

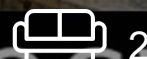

Floor Plan

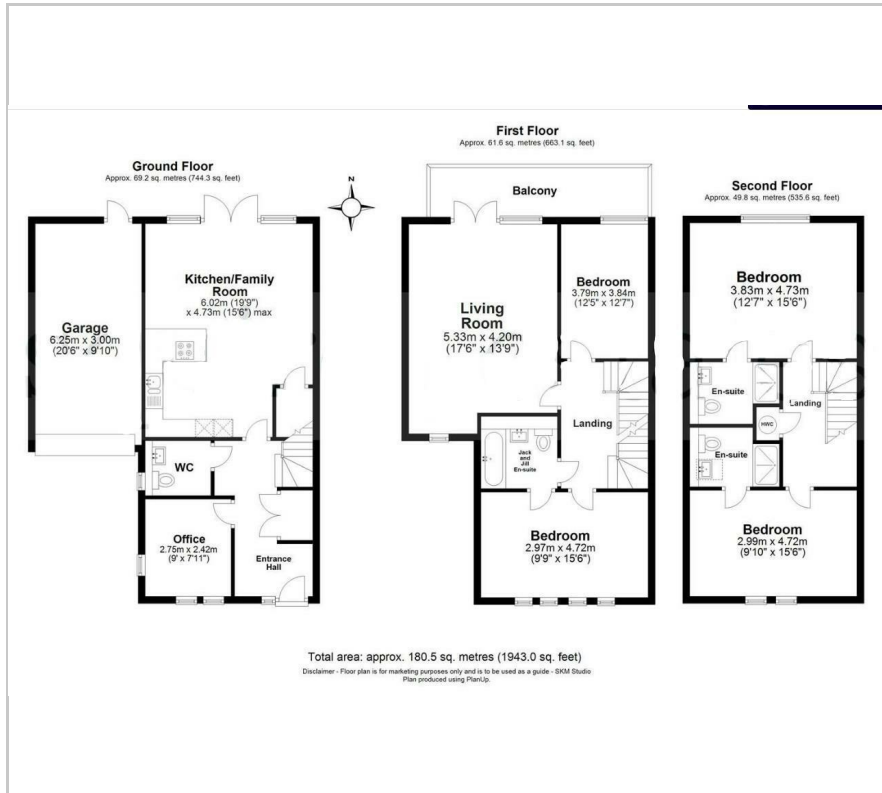

Area Map



Energy Efficiency Graph

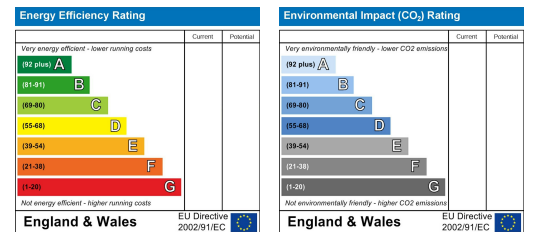

These particulars, whilst believed to be accurate are set out as a general outline only for guidance and do not constitute any part of an offer or contract. Intending purchasers should not rely on them as statements of representation of fact, but must satisfy themselves by inspection or otherwise as to their accuracy. No person in this firm's employment has the authority to make or give any representation or warranty in respect of the property.