



Charles Sevrigh Way

£1,250,000

Located in the highly sought-after Millbrook Park development, this circa 2000 sq ft detached family home offers exceptional living space and modern amenities. The ground floor boasts a modern open-plan kitchen, dining, and reception room, a separate utility room, and a W/C. On the first floor, you'll find an additional reception room, a double bedroom with an ensuite, and a separate W/C. The second floor features three further double bedrooms and two additional bathrooms. Additional features include a separate garage, off-street parking, and excellent decorative order throughout. The home is within walking distance to Mill Hill East Station and is offered chain-free. Sole agent.

- Circa 2000 Sq Ft - Detached House
- Excellent Condition
- 4 Double Bedrooms
- 2 Reception Rooms
- 3 Bathrooms
- Walking Distance To Mill Hill East Station
- Chain Free

Viewing

Please contact our Mill Hill Office on 02089590011 if you wish to arrange a viewing appointment for this property or require further information.



Floor Plan

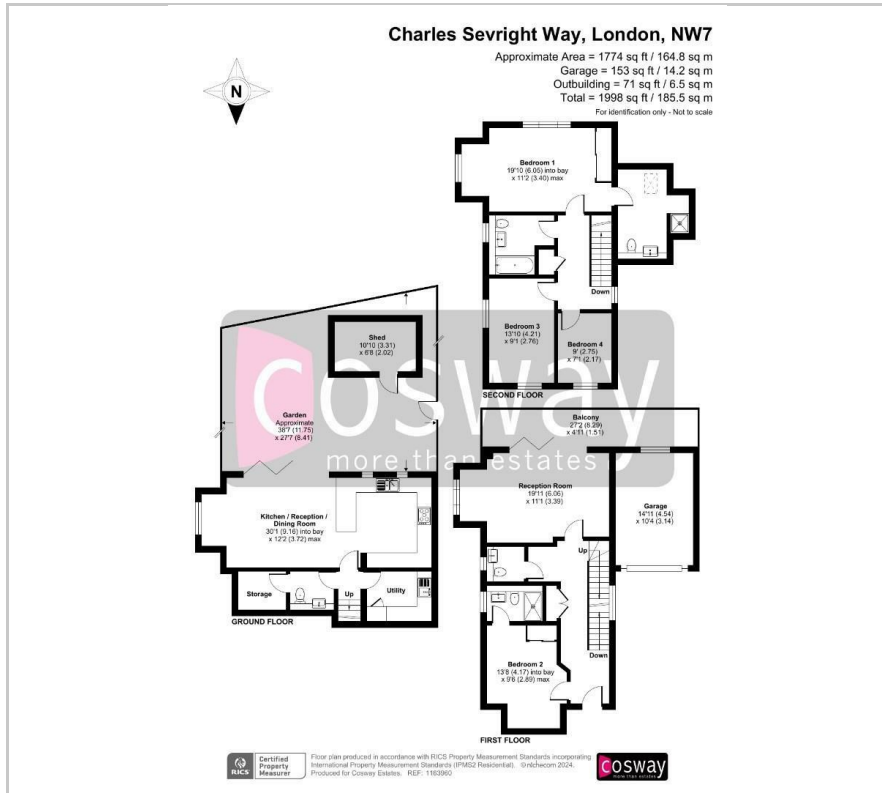

Area Map



Energy Efficiency Graph

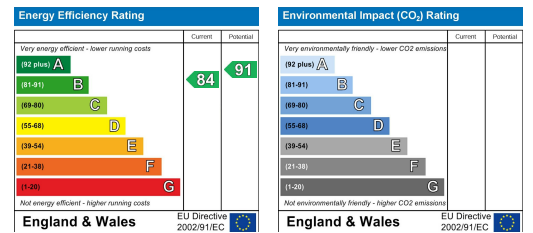

These particulars, whilst believed to be accurate are set out as a general outline only for guidance and do not constitute any part of an offer or contract. Intending purchasers should not rely on them as statements of representation of fact, but must satisfy themselves by inspection or otherwise as to their accuracy. No person in this firm's employment has the authority to make or give any representation or warranty in respect of the property.