



Edgecumbe Avenue

£585,000

1204 sq ft - Located in a highly sought-after development, is this this larger-than-average three double bedroom second floor apartment. Expertly interior designed and truly turn-key, this stunning property features a spacious reception room, a large kitchen-dining room, a main bedroom with an en-suite bathroom, two further double bedrooms, and a family bathroom. Additional benefits include plenty of storage, allocated parking, and a balcony. Conveniently situated close to the amenities of Mill Hill and Colindale, this apartment offers the perfect blend of exceptional style, space, and convenience. J. SOLE

Viewing

Please contact our Mill Hill Office on 02089590011 if you wish to arrange a viewing appointment for this property or require further information.



Floor Plan

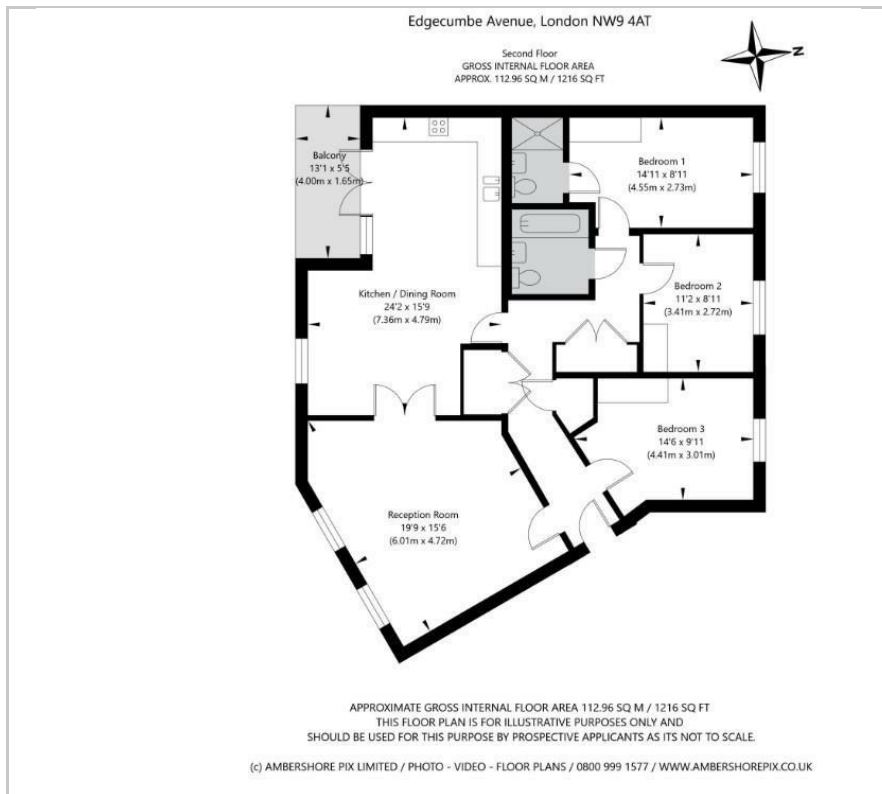

Area Map



Energy Efficiency Graph

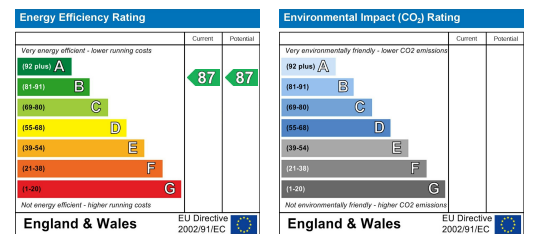

These particulars, whilst believed to be accurate are set out as a general outline only for guidance and do not constitute any part of an offer or contract. Intending purchasers should not rely on them as statements of representation of fact, but must satisfy themselves by inspection or otherwise as to their accuracy. No person in this firm's employment has the authority to make or give any representation or warranty in respect of the property.