



Peacock Close

£425,000

Situated in a highly sought-after development, this well-maintained ground floor flat offers an exceptional living experience with its modern amenities and convenient location. The property features two generously sized double bedrooms, providing ample space for comfort and relaxation. The spacious reception room opens onto a charming balcony, perfect for enjoying a morning coffee or unwinding in the evening.

The modern fitted kitchen is equipped with high-quality appliances and ample counter space, making it a joy for cooking enthusiasts. The main bedroom boasts a luxurious en-suite bathroom, offering a private retreat. The second double bedroom is also well-proportioned, making it ideal for guests, family members, or a home office setup.

The family bathroom is stylishly designed and includes contemporary fixtures. Additional storage spaces throughout the flat. Further benefits of this property include secure parking, providing peace of mind for your vehicle, and its close proximity to Mill Hill East station. The local amenities, including shops, restaurants, and parks, are easily accessible, adding to the convenience of this prime location.

Viewing

Please contact our Mill Hill Office on 02089590011 if you wish to arrange a viewing appointment for this property or require further information.



2



2



1



Floor Plan

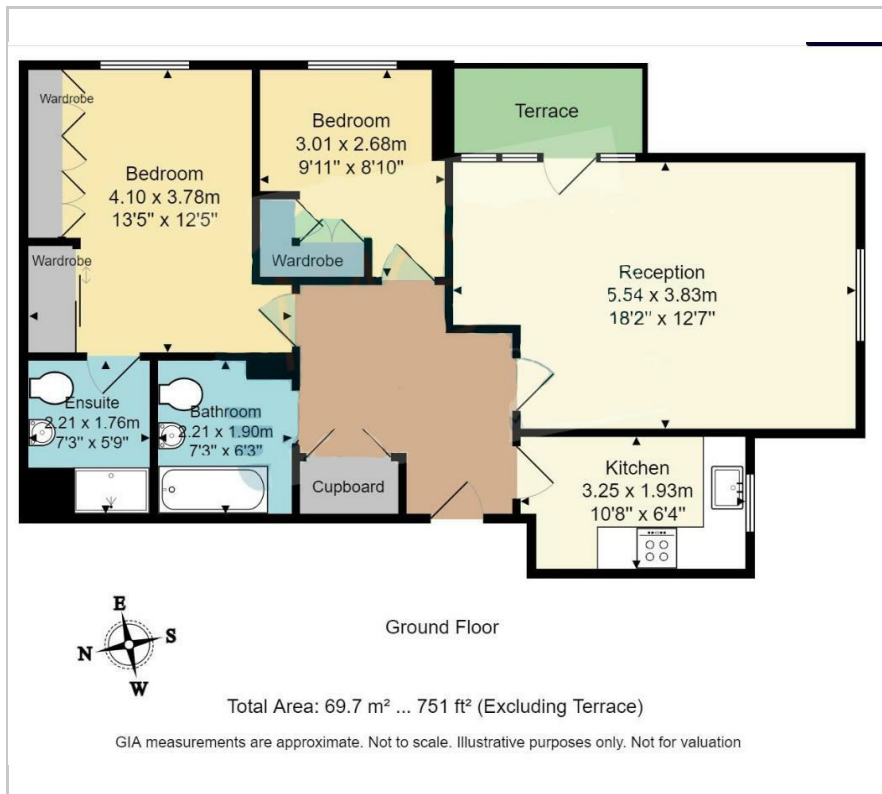

Area Map



Energy Efficiency Graph

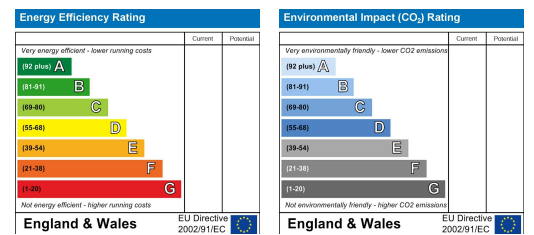

These particulars, whilst believed to be accurate are set out as a general outline only for guidance and do not constitute any part of an offer or contract. Intending purchasers should not rely on them as statements of representation of fact, but must satisfy themselves by inspection or otherwise as to their accuracy. No person in this firm's employment has the authority to make or give any representation or warranty in respect of the property.