

£1,400 pcm

13 Fold Apartments, Sidcup, Kent, DA15 7AP



- WELL PRESENTED 1 BEDROOM 2ND FLOOR FLAT
- CLOSE TO ALL LOCAL AMENITIES
- CENTRAL HEATING, DOUBLE GLAZING & NEUTRAL DECOR
- SPACIOUS LOUNGE WITH WOOD LAMINATE FLOORING
- OPEN PLAN KITCHEN WITH A RANGE OF WALL & BASE UNITS
- DOUBLE SIZE BEDROOM WITH FITTED WARDROBE
- MODERN BATHROOM WITH OVERBATH SHOWER
- ALLOCATED INTERNAL PARKING SPACE
- COMMUNAL ROOF TERRACE WITH VIEWS OF LONDON & KENT

To view all our homes: www.drewery.co.uk





WELL PRESENTED 1 BEDROOM 2ND FLOOR FLAT: UNFURNISHED

A well presented 1 bedroom second floor apartment in 'The Fold' development. Situated close to all local amenities including: schools, shops, high street, bus route and Sidcup mainline train station.

The property benefits from gas central heating, double glazing, lift, video phone entry system and neutral décor.

The accommodation comprises: Entrance hall. Storage cupboard with washer / dryer. Spacious lounge with laminate flooring which is open plan to kitchen. Modern kitchen fitted with a range of wall and base units, work surfaces, stainless steel sink, fridge / freezer and dishwasher. Double size bedroom with carpet and fitted wardrobe. Modern bathroom with hand basin, bath with overbath shower, heated towel rail and W.C. Externally there is an allocated internal parking space. There is also a communal roof terrace with views of London and Kent.

Available end July.

Restrictions: no pets, smokers or students.

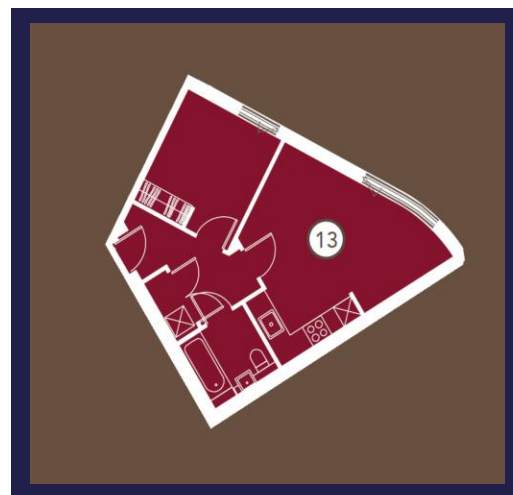

Energy Efficiency Rating C.
(76/76) EIR 0/0

If you would like to view please contact Drewery Property Consultants on **020 8269 6600**

These particulars are intended to give a fair description of the property but their accuracy cannot be guaranteed. Intending tenants should not rely on them as statements of representation of fact, but must satisfy themselves by inspection or otherwise as to their accuracy. All measurements quoted are approximate. None of the appliances/services have been tested by ourselves.

*Important -Admin fees apply per applicant. Please visit our website www.drewery.co.uk (information for tenants - Fees & other costs) or contact our staff.