



Oisc Court

2 Craybrooke Road
Sidcup
DA14 4HL

Leasehold

Modern two double bedroom second floor apartment
Allocated parking space within gated development
Lounge with private balcony to rear
Lift to all floors
Short walk to local shops, bars cafés & restaurants

Local Authority Bexley London Borough
Council
Council Tax Band C
EPC Rating C

Lease 113 years remaining
Service Charge £2,592 pa
Ground Rent £200 pa

Craybrooke Road, Sidcup, DA14

Approximate Area = 771 sq ft / 71.6 sq m
For identification only - Not to scale

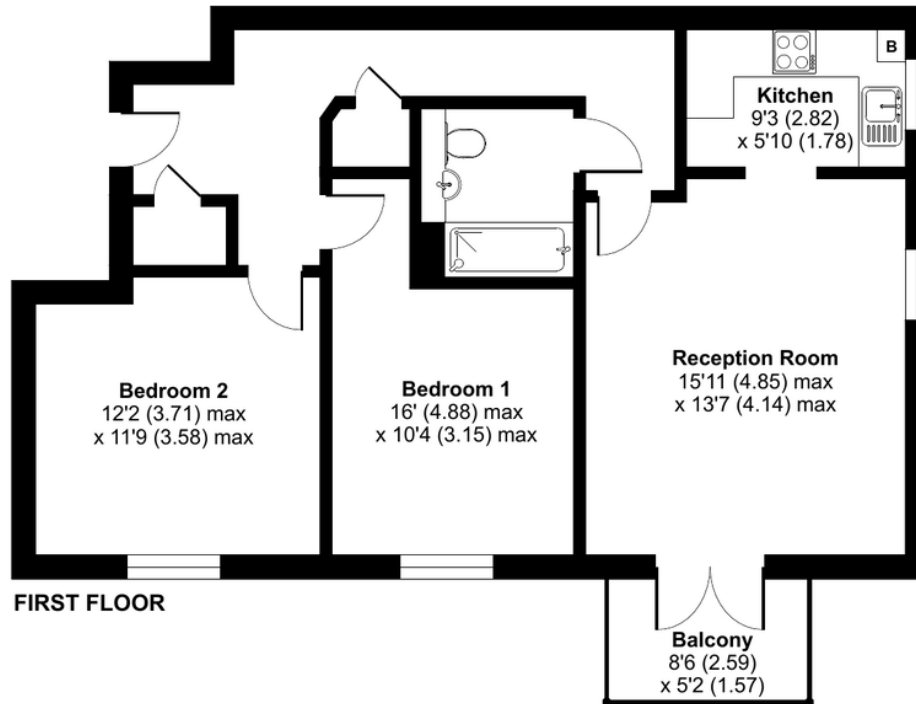

Drewery Property Consultants
128 Station Road
Sidcup
Kent
DA15 7AF

Contact
020 8269 6605
info@drewery.co.uk
www.drewery.co.uk

Agents Note: Whilst every care has been taken to prepare these particulars, they are for guidance purposes only. All measurements are approximate and are for general guidance purposes only and whilst every care has been taken to ensure their accuracy, they should not be relied upon and potential buyers/tenants are advised to recheck the measurements.