



**Kirkland Close**

Sidcup  
DA15 8TP

**Leasehold**

Studio flat with 2 allocated parking spaces  
Chain Free  
Easy access to local shops, transport links  
Convenient for Greenwich University (Avery Hill Campus)  
Ideal buy to let investment / FTB  
Communal entrance  
Long lease

**Local Authority** Bexley London Borough  
Council  
**Council Tax Band** B  
**EPC Rating** C

**Lease** 959 years remaining  
**Service Charge** £1,000 per annum  
**Ground Rent** included in the service charge

## Kirkland Close, Sidcup, DA15

Approximate Area = 292 sq ft / 27.1 sq m  
For identification only - Not to scale

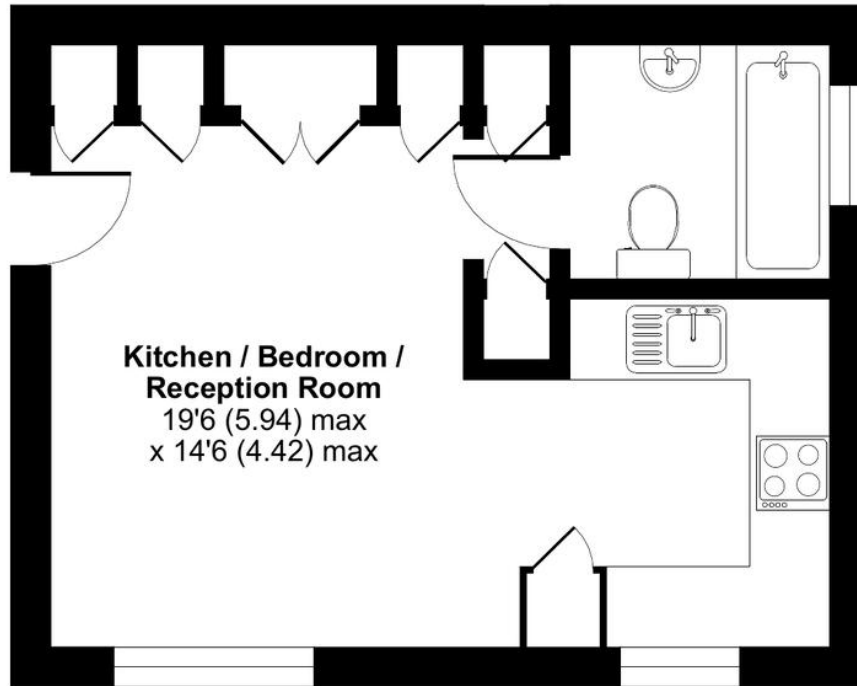

**FIRST FLOOR**



**Drewery Property Consultants**  
128 Station Road  
Sidcup  
Kent  
DA15 7AF

**Contact**  
020 8269 6605  
info@drewery.co.uk  
www.drewery.co.uk

**Agents Note:** Whilst every care has been taken to prepare these particulars, they are for guidance purposes only. All measurements are approximate and are for general guidance purposes only and whilst every care has been taken to ensure their accuracy, they should not be relied upon and potential buyers/tenants are advised to recheck the measurements.