

ROBERTSON PHILLIPS
Estate Agents, Valuers,
Lettings and Property Management

262a Uxbridge Road, Hatch End,
Pinner, Middlesex HA5 4HS
Tel: 020 8428 7161

Email: pinner@robertsonphillips.co.uk

Harrow: 020 8863 1122
Lettings: 020 8421 4847



ROBERTSON
PHILLIPS

Estate Agents



Headstone Lane, Harrow

Guide Price £400,000



www.robertsonphillips.co.uk



A two double bedroom, Hills built property in need of a full renovation throughout.

The property is situated in an ideal location for sought after schools, shopping facilities and transport via bus and Headstone Lane station. Comprising lounge, kitchen/dining room with doors to a lean-to and additional patio door to garden.

Upstairs are two double bedrooms and a family bathroom/wc. Features include private garden, double glazing and ample parking via brick paved drive for two vehicles.



Council Tax Band: C
EPC Rating: To be confirmed
Tenure: Freehold
Facing: West





KEY FEATURES:

- Freehold
- Two Double Bedrooms
- Driveway
- Garden
- Spacious Kitchen
- In Need of Full Refurbishment



Ground Floor

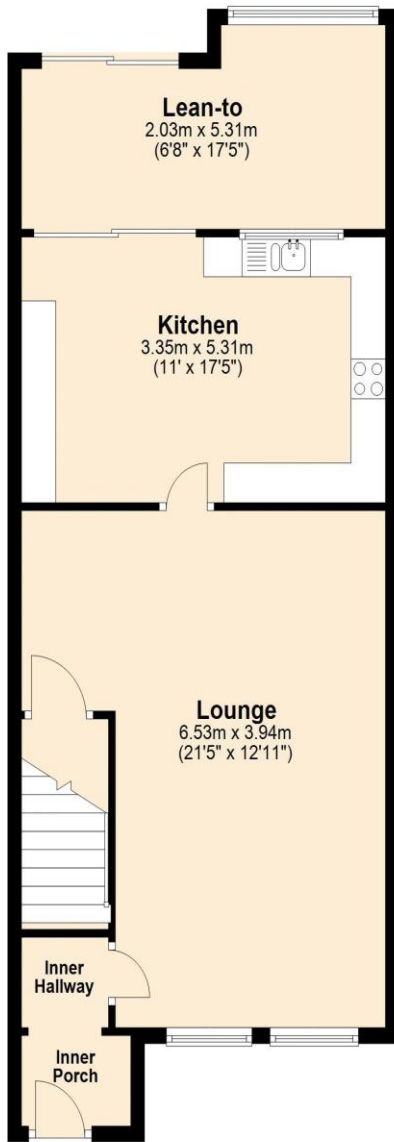

First Floor

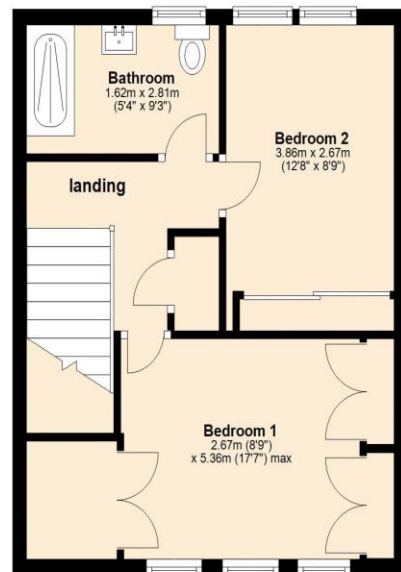

DISCLAIMER: Robertson Phillips may not have sought to verify the legal title of the property, the existence of planning permissions and/or building regulation approvals and have been unable to check the working condition of any services or appliances.

Property layouts are for general guidance and are not drawn exactly to scale. Measurements are taken at the widest points and