



Weston, Bath

£250,000

**A Well Appointed Bungalow in this Popular Retirement Development. EPC Grade D**





**The Bungalow**  
**12A Sheppards Gardens**  
**High Street**  
**Weston**  
**Bath**  
**BA1 4DF**

**PRICE: £250,000**

With a South facing aspect to the front, a ground floor bungalow apartment in this popular development off Weston High Street. The bungalow is accessed via either a staircase or a lift. The level garden accommodation includes a private entrance and porch, Living room, Bedroom, Wet Room and Kitchen with integrated Bosch appliances including washing machine / dryer, fridge freezer, dishwasher and oven. Of note is that both the bathroom and kitchen have windows, which is not common in this popular residence. There are excellent communal facilities which include a Laundry room, Gardens and a communal

Living room. Located in the heart of Weston Village, it's walking distance to all the local amenities such as Tesco and has a choice of coffee shops, as well as bus routes into Bath. Being sold with vacant possession.

### **Bungalow Style Retirement Apartment**

**Private Entrance**

**One Bedroom**

**Wet Room**

**Fitted Kitchen**

**Communal Gardens**

**Residents Living Room**

**Leasehold**

**Council Tax Band B £1762**

**408 Sq Ft (37.9 Sq Ft)**



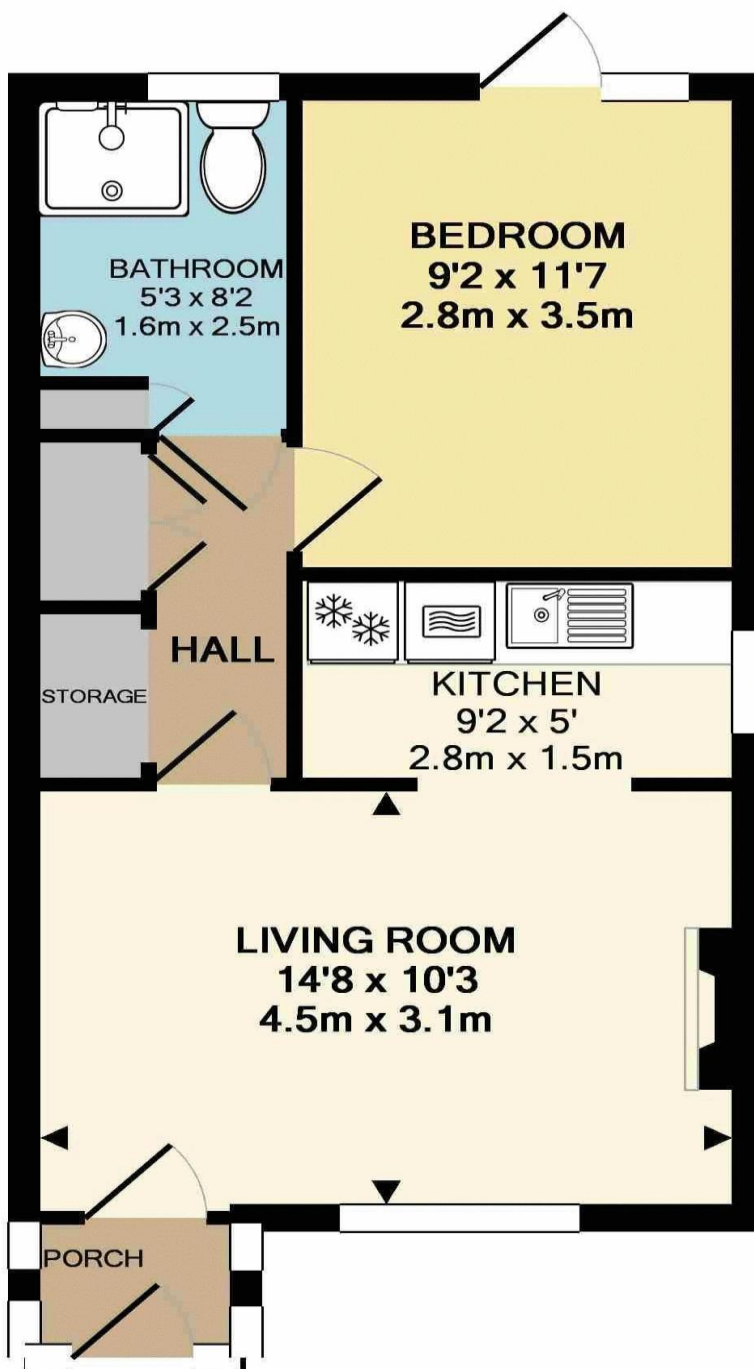

TOTAL APPROX. FLOOR AREA 408 SQ.FT. (37.9 SQ.M.)

All measurements of walls, doors, windows, fittings and appliances, their size and locations are approximate and cannot be regarded as being an accurate representation neither by the vendor nor their agent. [www.inovusproperty.co.uk](http://www.inovusproperty.co.uk)  
Made with Metropix ©2018

**Kit Johnson Residential**  
**26-33 High St**  
**Weston**  
**Bath**  
**BA1 4BX**  
**01225 444447**  
**[sales@kitjohnson.co.uk](mailto:sales@kitjohnson.co.uk)**  
**[www.kitjohnson.co.uk](http://www.kitjohnson.co.uk)**