

KIT JOHNSON

residential



Sheppards Gardens, Bath

£167,950

One Bedroom, Garden Level, South Facing Retirement Apartment. EPC Grade C



16 Sheppards Gardens
High Street
Weston
Bath
BA1 4DF

PRICE: £167,950

Rarely available in this popular retirement development, a South facing garden level apartment with a private entrance. Updated throughout and beautifully presented, the accommodation includes Porch, Living room, fitted Kitchen with integrated appliances, Inner Hallway with large cupboard, double Bedroom and a Bathroom suite. There are award winning gardens and excellent communal facilities. Pets are welcome. Vacant possession. Sheppards Gardens is ideally located for all the amenities in Weston Village and buses into the City centre.

**Over 55's Retirement
Apartment**

One Bedroom

Garden Level

South Facing Front

UPVC Double Glazing

**Electric Night Storage
Heating**

**Leasehold (New 99 Year
Lease Granted on
Completion)**

Service Charge £264.44 PCM

**Estate Manager - 01225
336140**

Council Tax Band B £1596

441 Sq Ft (41.0 Sq Mt)



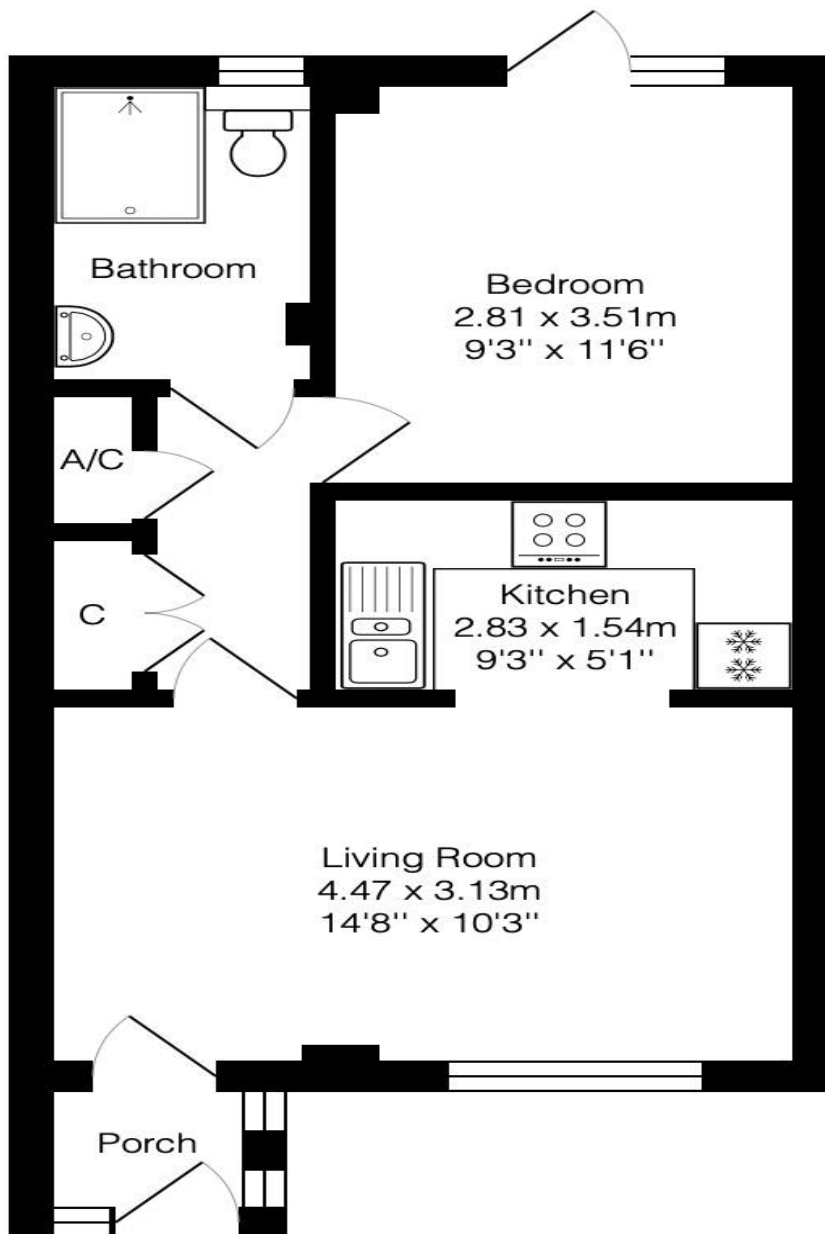

Area: 41.0 m² ... 441 ft²

Whilst every attempt has been made to ensure the accuracy of the floorplan contained here, measurements of doors, windows, rooms and any other items are approximate and no responsibility is taken for any error, omission or mis-statement. This plan is purely for illustrative purposes only and should be used as such by any prospective purchaser. Area includes internal and external wall thickness
www.epcassessments.co.uk

Kit Johnson Residential
26-33 High St
Weston
Bath
BA1 4BX
01225 444447
sales@kitjohnson.co.uk
www.kitjohnson.co.uk