

St. John's Road, Bathwick, Bath BA2 6PZ

For Sale - £650,000



Substantial bay-fronted 1920's three bedroom terraced house with a good size garden and garage. There is potential to modernise and extend the accommodation to create a very desirable home in this sought-after central Bath location.



Hallway

Features

Gas central heating | Double glazed windows | Kitchen with gas hob and electric oven | Separate Utility Room and toilet with basin (under the kitchen and accessed from outside) | Single garage

St. John's Road connects Bathwick Street and Argyle Street via Grove Street. Comprising an attractive mix of period and new-build properties of varying sizes, with the river running the length of the road on the west side.

Did you know?

The river flow and height are controlled throughout the year by the Pulteney and Twerton Weirs (built as part of the Bath Flood Protection Scheme).

Size

116 sq. m. (1255 sq. ft.) approx.

Tenure

Freehold

Council Tax

Band D: £1,851.70 - 2021/22



Arrange a viewing

01225 443322

www.wildandlye.com

Important Notice 1. Particulars: These particulars are not an offer or contract, nor part of one. You should not rely on statements by Wild & Lye in the particulars or by word of mouth or in writing ("information") as being factually accurate about the property, its condition or its value. Neither Wild & Lye nor any joint agent has any authority to make any representations about the property, and accordingly any information given is entirely without responsibility on the part of the agents, seller(s) or lessor(s). 2. Photos etc: The photographs show only certain parts of the property as they appeared at the time they were taken. Areas, measurements and distances given are approximate only. 3. Regulations etc: Any reference to alterations to, or use of, any part of the property does not mean that any necessary planning, building regulations or other consent has been obtained. A buyer or lessee must find out by inspection or in other ways that these matters have been properly dealt with and that all information is correct.

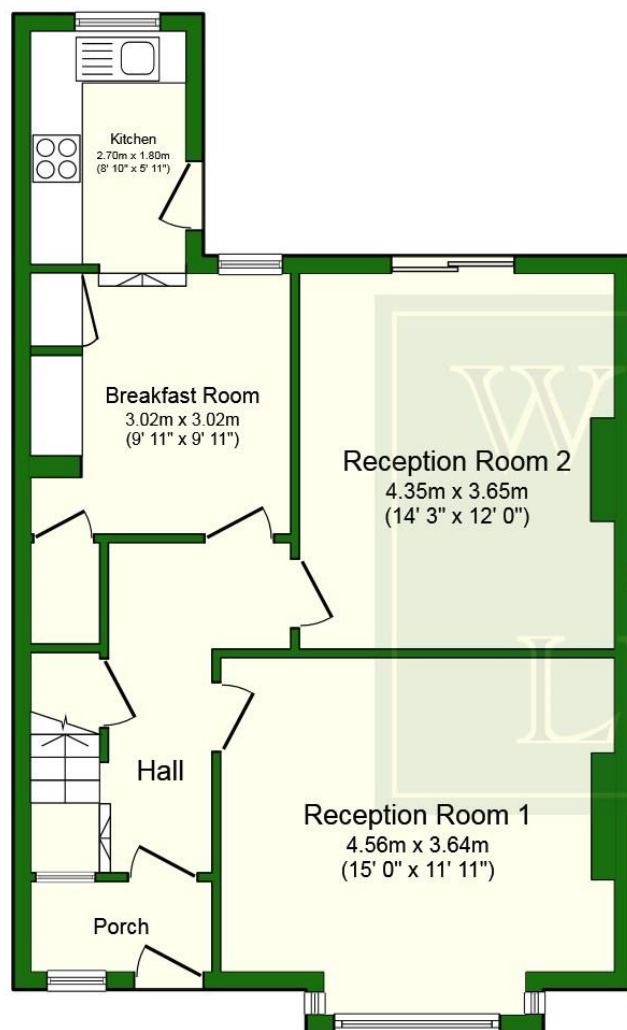

Ground Floor

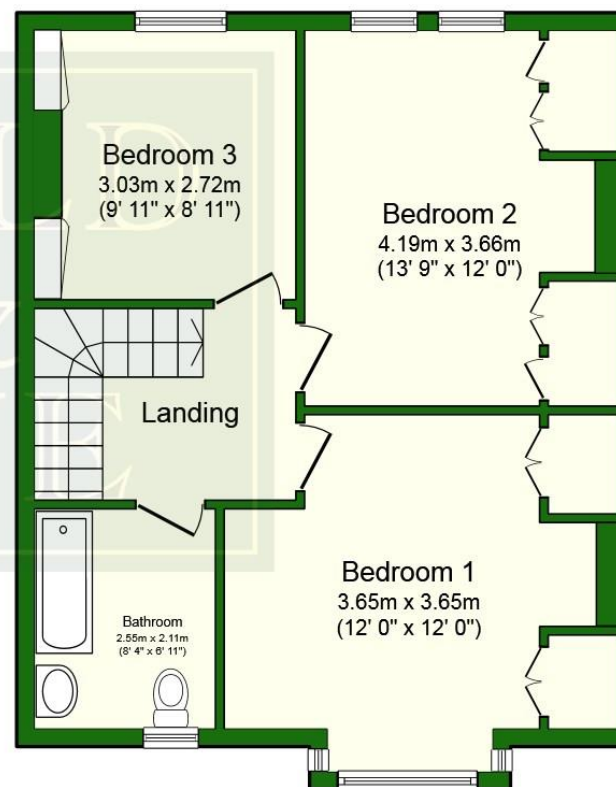

First Floor



Reception Room 2



Breakfast Room

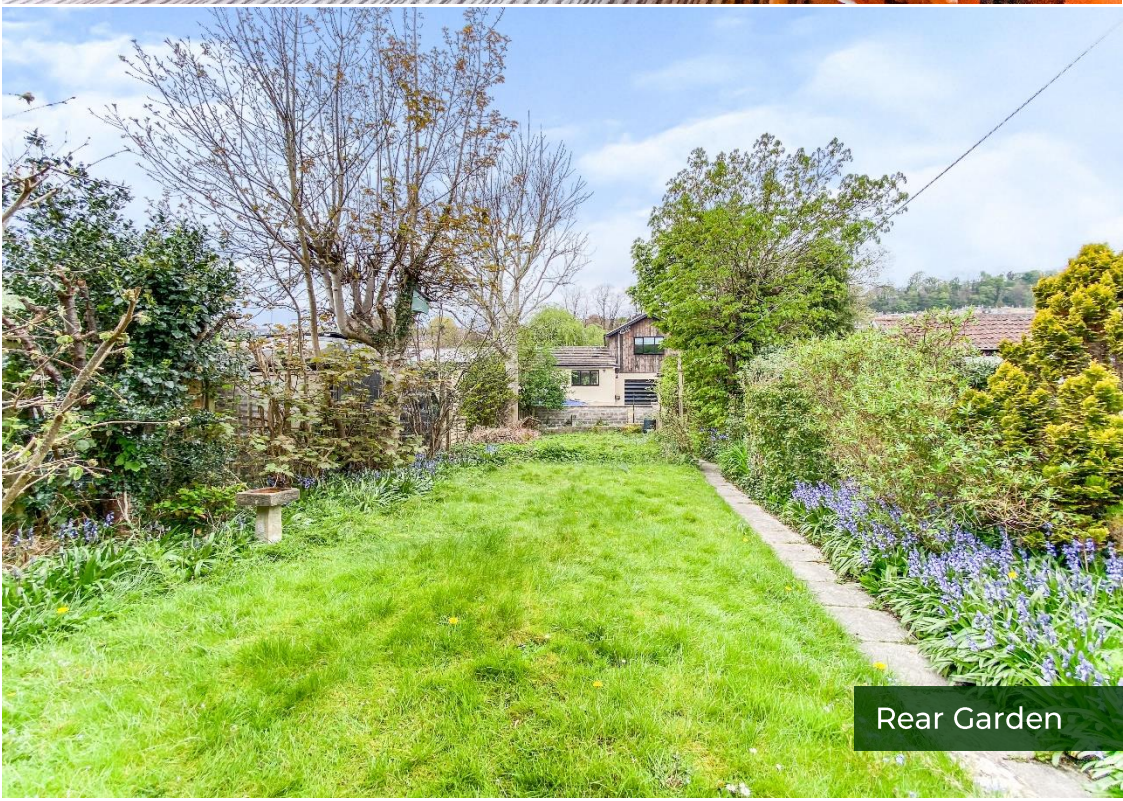

Rear Garden



Bedroom 1



Bedroom 2



Bedroom 3



Plan your move with Wild & Lye...



Choose a Bath estate agency that advertises
on the best property websites and offers
free furniture removal to its sellers.

01225 443322

wildandlye.com