



For Sale £370,000



Rossiter Road, Widcombe, Bath BA2 4JP

A freehold end terrace house in central Bath is a beautiful thing.

2 Beds | Spacious and light first floor Living Room and Kitchen/Dining

Phone: 01225 443322 | Email: property@wildandlye.com





Additional information

Electric heating | Stylish Kitchen with built-in oven, hob, extractor hood, dishwasher, stainless steel splashback and cabinet fronts | Garage available to rent separately

Location

Rossiter Road is about a five minute walk into the city centre and less to Bath Spa Railway Station. Widcombe also has its own parade of shops which is an eclectic mix of amenities, businesses and eateries - connected to Southgate by a footbridge over the river.

Tenure

Freehold

Council Tax

Band C

Score	Energy rating	Current	Potential
92+	A		
81-91	B		85 B
69-80	C		
55-68	D		
39-54	E	40 E	
21-38	F		
1-20	G		

Arrange a viewing

01225 443322

www.wildandlye.com

Important Notice 1. Particulars: These particulars are not an offer or contract, nor part of one. You should not rely on statements by Wild & Lye in the particulars or by word of mouth or in writing ("information") as being factually accurate about the property, its condition or its value. Neither Wild & Lye nor any joint agent has any authority to make any representations about the property, and accordingly any information given is entirely without responsibility on the part of the agents, seller(s) or lessor(s). 2. Photos etc: The photographs show only certain parts of the property as they appeared at the time they were taken. Areas, measurements and distances given are approximate only. 3. Regulations etc: Any reference to alterations to, or use of, any part of the property does not mean that any necessary planning, building regulations or other consent has been obtained. A buyer or lessee must find out by inspection or in other ways that these matters have been properly dealt with and that all information is correct.

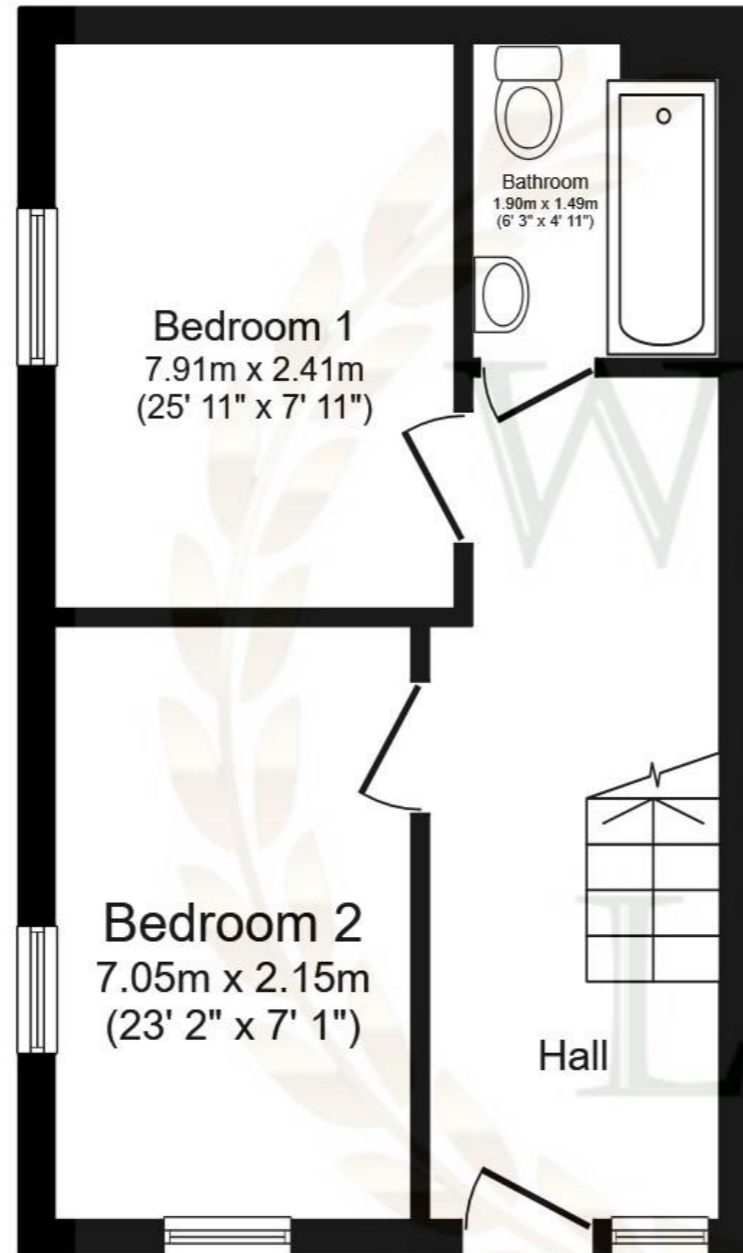

Ground Floor

Floor area 28.3 m² (304 sq.ft.)

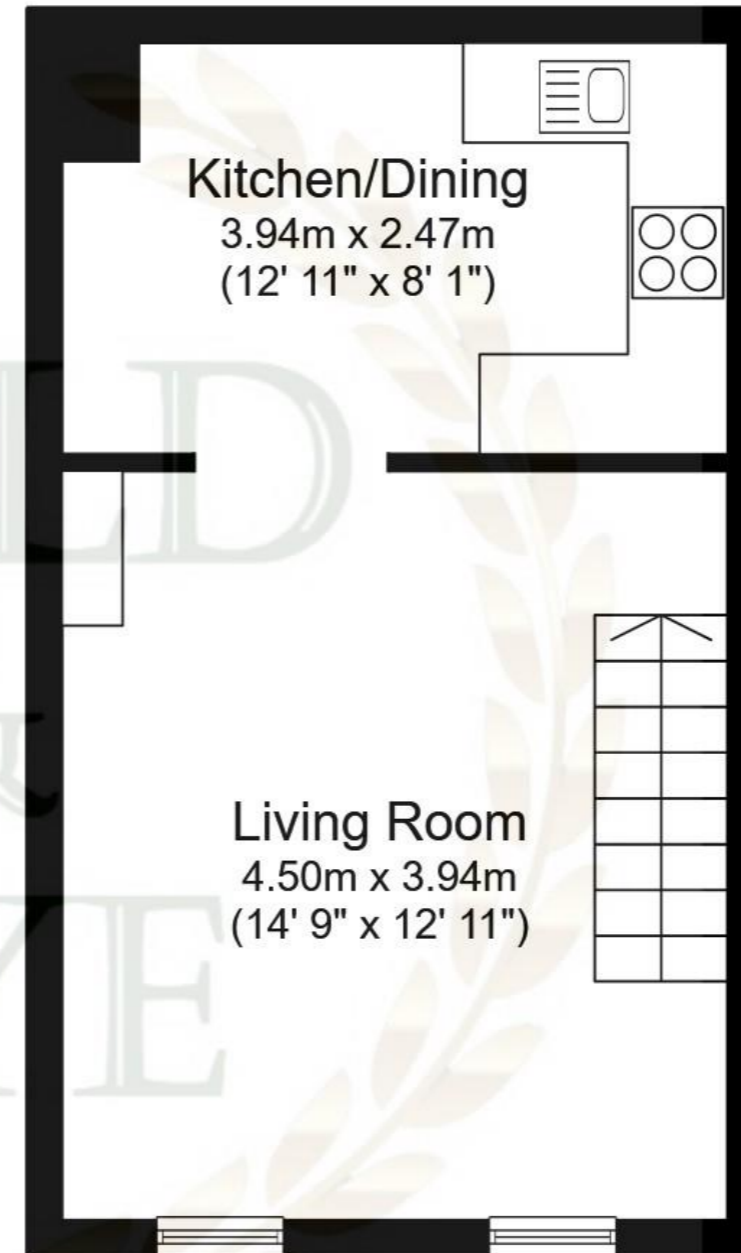

First Floor

Floor area 28.3 m² (304 sq.ft.)

TOTAL: 56.6 m² (609 sq.ft.)

This floor plan is for illustrative purposes only. It is not drawn to scale. Any measurements, floor areas (including any total floor area), openings and orientations are approximate. No details are guaranteed, they cannot be relied upon for any purpose and do not form any part of any agreement. No liability is taken for any error, omission or misstatement. A party must rely upon its own inspection(s). Powered by www.Propertybox.io



Bedroom 1



Bedroom 2



When you sell your home with



01225 443322
wildandlye.com

FREE
FURNITURE
REMOVAL

