



Bedford Court, Bedford Street, Bath BA1 6PH  
**For Sale** - £325,000





**Very impressive first and second floor two bedroom maisonette with its own parking space, bathroom and shower room.** Quietly situated and well-managed modern apartment building in central Bath. This is a high quality and practical home that we highly recommend viewing.





### Property features

Quantum electric night storage heaters | Kitchen with integral oven, hob, extractor hood, dishwasher, washing machine and fridge/freezer | Karndean wood effect flooring in the Living Room (carpeted Bedrooms) | Built-in wardrobes in both bedrooms | Eaves storage

### Size

61 sq. m. (658 sq. ft.) approx.

### Tenure

Leasehold. 999 years from 1984

### Service Charge

Approx. £80 pcm

### Council Tax

Band A: £1,272.64 – 2022/23



Arrange a viewing

01225 443322

[www.wildandlye.com](http://www.wildandlye.com)

**Important Notice** 1. Particulars: These particulars are not an offer or contract, nor part of one. You should not rely on statements by Wild & Lye in the particulars or by word of mouth or in writing ("information") as being factually accurate about the property, its condition or its value. Neither Wild & Lye nor any joint agent has any authority to make any representations about the property, and accordingly any information given is entirely without responsibility on the part of the agents, seller(s) or lessor(s). 2. Photos etc: The photographs show only certain parts of the property as they appeared at the time they were taken. Areas, measurements and distances given are approximate only. 3. Regulations etc: Any reference to alterations to, or use of, any part of the property does not mean that any necessary planning, building regulations or other consent has been obtained. A buyer or lessee must find out by inspection or in other ways that these matters have been properly dealt with and that all information is correct.

Score	Energy rating	Current	Potential
92+	A		
81-91	B		
69-80	C	77 C	79 C
55-68	D		
39-54	E		
21-38	F		
1-20	G		

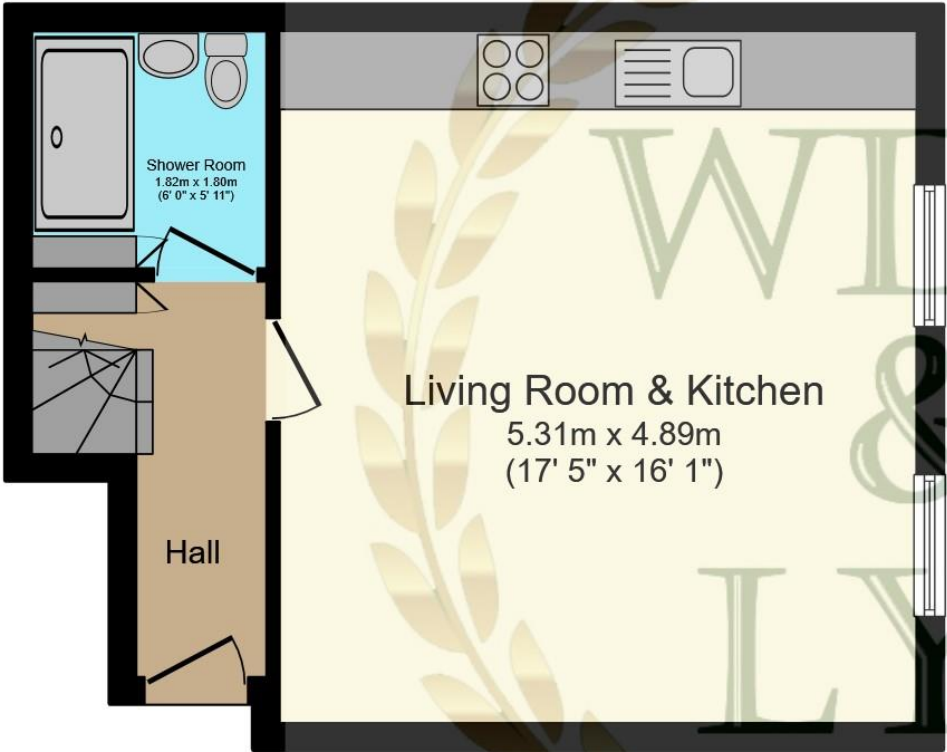

**First Floor**

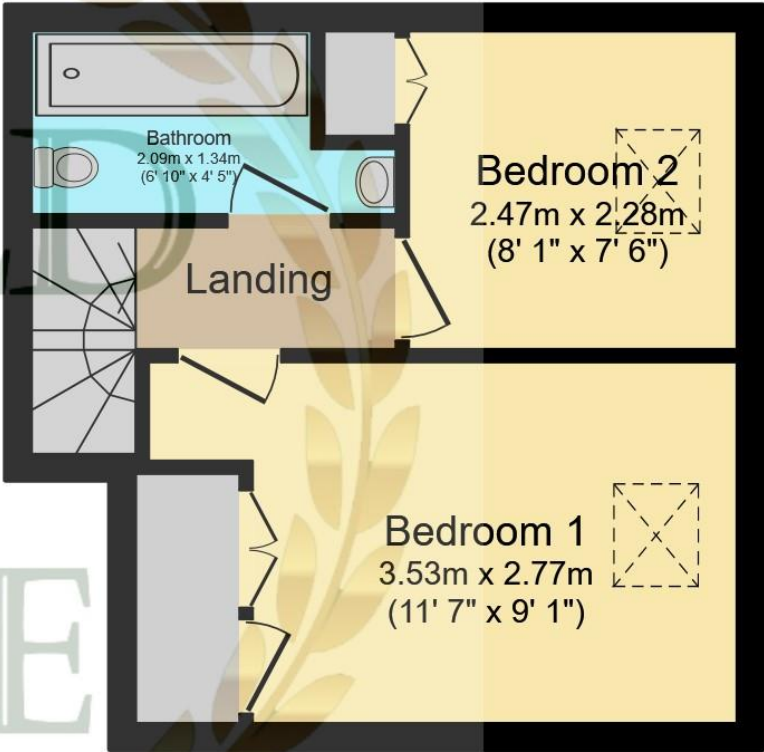

**Second Floor**





# Plan your move with Wild & Lye...



Choose a Bath estate agency that advertises  
on the best property websites and offers  
free furniture removal to its sellers.

01225 443322

[wildandlye.com](http://wildandlye.com)