



Summerlays Court, Widcombe, Bath BA2 4HU

For Sale - £143,500



A light and airy two bedroom middle floor apartment in a good central Bath location. Attractively priced for homeowners aged fifty five or older. Widcombe is in the heart of the city, just a short walk from the train station and the wonderful shops and amenities that this beautiful city offers. The apartment has been improved from the original specification with a newly fitted kitchen and bathroom, together with replacement double glazed windows.



Property features

Electric heating | Double glazed windows | Good energy efficiency rating | Kitchen with ceramic hob, oven, integral fridge and freezer | Some parking spaces on-site and permit parking for residents in neighbouring streets (available to purchase from B&NES)

Video Tour

<https://youtu.be/HP4IKydYdLE>

Size

52 sq. m. (562 sq. ft.) approx.

Tenure

New 70 year lease

Service Charge

£84.32 pcm

Council Tax

Band B: £1,516 - 2022/23



Arrange a viewing

01225 443322

www.wildandlye.com

Important Notice 1. Particulars: These particulars are not an offer or contract, nor part of one. You should not rely on statements by Wild & Lye in the particulars or by word of mouth or in writing ("information") as being factually accurate about the property, its condition or its value. Neither Wild & Lye nor any joint agent has any authority to make any representations about the property, and accordingly any information given is entirely without responsibility on the part of the agents, seller(s) or lessor(s). 2. Photos etc: The photographs show only certain parts of the property as they appeared at the time they were taken. Areas, measurements and distances given are approximate only. 3. Regulations etc: Any reference to alterations to, or use of, any part of the property does not mean that any necessary planning, building regulations or other consent has been obtained. A buyer or lessee must find out by inspection or in other ways that these matters have been properly dealt with and that all information is correct.

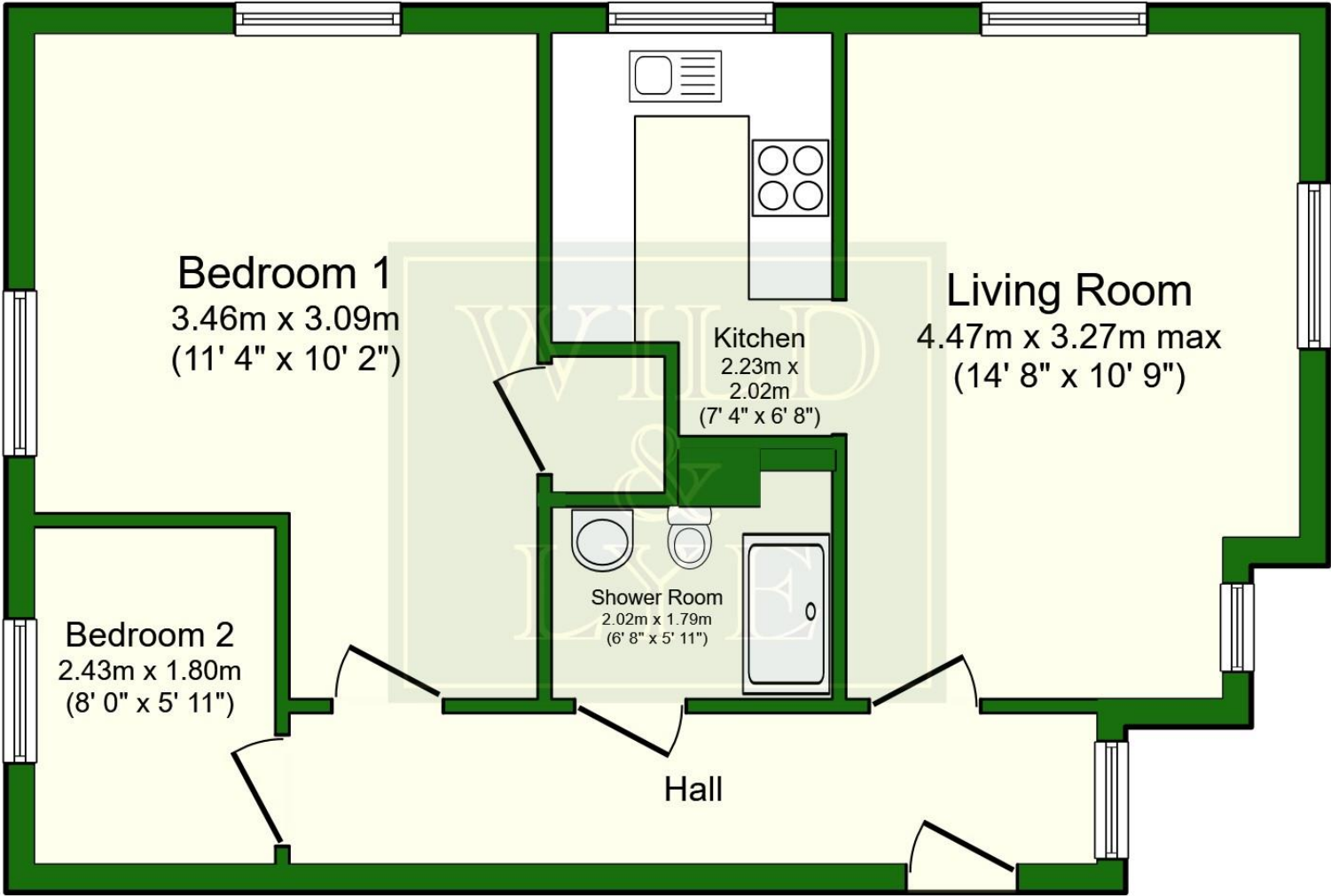
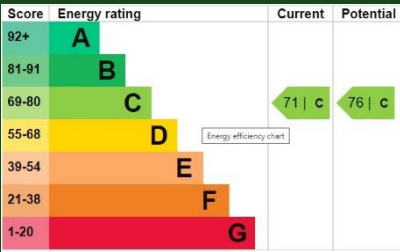



Bedroom 1



Bedroom 2



Shower Room