



## 9 Waterloo Lane

Skellingthorpe, Lincoln, LN6 5SJ

**£355,000**

A well-presented three bedroom detached family home positioned in this non-estate position on the popular tree-lined street of Waterloo Lane in Skellingthorpe. The property is approached by a block-paved driveway, lawned garden and mature trees and shrubs. Internally the accommodation comprises of Entrance Porch, Inner Hallway, Lounge, Dining Area, modern fitted Dining Kitchen, further Reception Room/Study, Rear Entrance leading to WC and Utility Room and stairs rising to the First Floor Landing giving access to three Bedrooms and a Bathroom. To the rear of the property there is an extensive lawned garden, paved seating area, mature shrubs, trees and fruit trees. The property is close to two local schools with 'Good' Ofsted ratings, North Hykeham Railway station is approx. 2.56 miles away and the nearest bus stop is on Gardenfields (approx. 0.01 miles away). The property further benefits from No Onward Chain and viewing is highly recommended to appreciate the accommodation on offer and the position it sits within this popular village.



**Waterloo Lane, Skellingthorpe, Lincoln, LN6 5SJ**



**SERVICES**

All mains services available. Gas central heating.

**EPC RATING** – TBC

**COUNCIL TAX BAND** – C

**LOCAL AUTHORITY** - West Lindsey District Council.

**TENURE** - Freehold.

**VIEWINGS** - By prior appointment through Mundys.

**LOCATION**

The property is located in the medium sized village of Skellingthorpe which lies approximately 4 miles West of the Historic Cathedral and University City of Lincoln. The village itself offers a wide range of local amenities including shops, public houses and primary schooling. There is good access to Lincoln City Centre via the A46 Bypass.



## ACCOMMODATION

### ENTRANCE HALL

With UPVC windows and doors to the front aspect and glass panelled wooden door to the Inner Hallway.

### INNER HALLWAY

With stairs to the First Floor Landing and radiator.

### LOUNGE

12' 3" x 15' 7" (3.74m x 4.77m), with UPVC bay window to the rear aspect, double radiator, wooden flooring, feature stone fireplace, wall lights, door to the Reception Room/Study and leading to the Dining Area.

### DINING AREA

11' 4" x 8' 11" (3.46m x 2.72m), with wooden flooring UPVC window to the front aspect, radiator, understairs storage cupboard and space for a dining table.

### KITCHEN

11' 9" x 9' 1" (3.59m x 2.78m), with wooden flooring, UPVC window and double doors to the rear garden, fitted with a range of base units and drawers with work surfaces over, stainless steel sink and drainer with mixer tap, integral oven, microwave, four ring electric hob with extraction above, integral fridge and freezer, integral dishwasher, wall-mounted cupboards with complementary tiling below, radiator, full-height storage cupboards and door to the Rear Entrance.

### BREAKFAST AREA

9' 11" x 9' 8" (3.04m x 2.96m), with space for a dining table.

### REAR ENTRANCE

With tiled flooring, door to the rear garden and doors to the WC and Utility Room.

### UTILITY ROOM

8' 0" x 6' 11" (2.46m x 2.11m), with UPVC window to the front aspect, tiled flooring, Belfast sink, spaces for an automatic washing machine and tumble dryer, work surfaces, wall-mounted gas central heating boiler and radiator.

### WC

With WC, wash hand basin, window to the rear aspect and extractor fan.

### STUDY/RECEPTION ROOM

10' 4" x 14' 9" (3.16m x 4.52m), with beams to the ceiling, UPVC sliding doors to the rear garden, UPVC window to the side aspect and radiator.

### FIRST FLOOR LANDING

With UPVC window to the front aspect, fitted cupboards and doors to the Bathroom and three Bedrooms.

### BATHROOM

5' 7" x 7' 10" (1.72m x 2.41m), with UPVC window to the side aspect, suite to comprise of bath with shower over, WC and wash hand basin, vanity cupboard, part-tiled walls and chrome towel radiator.





### BEDROOM 1

12' 1" x 11' 3" (3.7m x 3.43 m), with UPVC window to the rear aspect, radiator and fitted wardrobes.

### BEDROOM 2

8' 11" x 10' 11" (2.74m x 3.35m), with UPVC window to the rear aspect, radiator and fitted wardrobes.

### BEDROOM 3

9' 1" x 7' 5" (2.77m x 2.28m), with UPVC window to the side aspect, radiator and fitted wardrobe.

### OUTSIDE

To the front of the property there is a lawned garden, flowerbeds, mature shrubs and trees. To the rear there is a paved seating area. Lawned garden, flowerbeds, mature shrubs, trees and fruit trees.

### GARAGE

With up and over door to the front aspect, power, lighting and electric meters.



#### WEBSITE

Our detailed website shows all our available properties and also gives extensive information on all aspects of moving home, local area information and helpful information for buyers and sellers. This can be found at [mundys.co.uk](http://mundys.co.uk)

#### SELLING YOUR HOME - HOW TO GO ABOUT IT

We are happy to offer FREE advice on all aspects of moving home, including a Valuation by one of our QUALIFIED/SPECIALIST VALUERS. Ring or call into one of our offices or visit our website for more details.

#### REFERRAL FEE INFORMATION - WHO WE MAY REFER YOU TO

Sills & Betteridge, Ringrose Law LLP, Burton and Co, Bridge McFarland, Dale & Co and Gilson Gray who will be able to provide information to you on the Conveyancing services they can offer. Should you decide to use these Conveyancing Services then we will receive a referral fee of up to £150 per sale and £150 per purchase from them.

CWH and J Walter will be able to provide information and services they offer relating to Surveys. Should you decide to instruct them we will receive a referral fee of up to £125.

Claverings will be able to provide information and services they offer relating to removals. Should you decide to instruct them we will receive a referral fee of up to £125.

Mundys Financial Services who will be able to offer a range of financial service products. Should you decide to instruct Mundys Financial Services we will receive a commission from them of £250 and in addition, the individual member of staff who generated the lead will receive £50.

#### BUYING YOUR HOME

An Independent Survey gives peace of mind and could save you a great deal of money. For details, including RICS Home Buyer Reports, call 01522 550088 and ask for Steven Spivey MRICS.

#### GETTING A MORTGAGE

We would be happy to put you in touch with our Financial Adviser who can help you to work out the costs of financing your purchase.

#### NOTE

1. None of these services or equipment have been checked or tested.
2. All measurements are believed to be accurate but are given as a general guide and should be thoroughly checked.

#### GENERAL

If you have any queries with regard to a purchase, please ask and we will be happy to assist. Mundys makes every effort to ensure these details are accurate however they are for themselves and the vendors (Lessors) for whom they act as Agents given notice that:

1. The details are a general outline of guidance only and do not constitute any part of an offer or contract. No person in the employment of Mundys is any authority to make or give representation or warranty in relation to this property.
2. All descriptions, dimensions, references to condition and necessary permissions for use and occupation in other details should be verified by yourself on inspection, your own advisor or conveyancer, particularly on items stated herein and not verified.

Regulated by RICS. Mundys is the trading name of Mundys Property Services LLP registered in England NO. OC 353705. The Partners are not Partners for the purposes of the Partnership Act 1890. Registered Office 29 Silver Street, Lincoln, LN2 1AS.

Approx Gross Internal Area  
144 sq m / 1553 sq ft

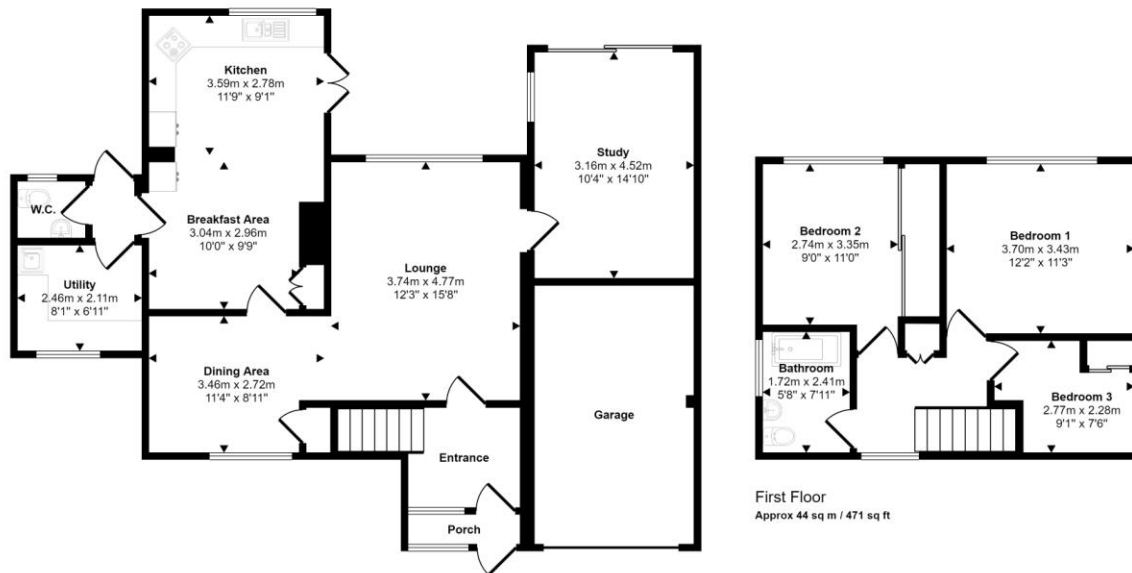

Ground Floor  
Approx 100 sq m / 1081 sq ft

First Floor  
Approx 44 sq m / 471 sq ft

This floorplan is only for illustrative purposes and is not to scale. Measurements of rooms, doors, windows, and any items are approximate and no responsibility is taken for any error, omission or mis-statement. Icons of items such as bathroom suites are representations only and may not look like the real items. Made with Made Snappy 360.

29 – 30 Silver Street  
Lincoln  
LN2 1AS

22 Queen Street  
Market Rasen  
LN8 3EH

Agents Note: Whilst every care has been taken to prepare these sales particulars, they are for guidance purposes only. All measurements are approximate and for general guidance purposes only and whilst every care has been taken to ensure their accuracy, they should not be relied upon and potential buyers are advised to recheck the measurements.

