

145 Meanley Road, London, E12 6AS

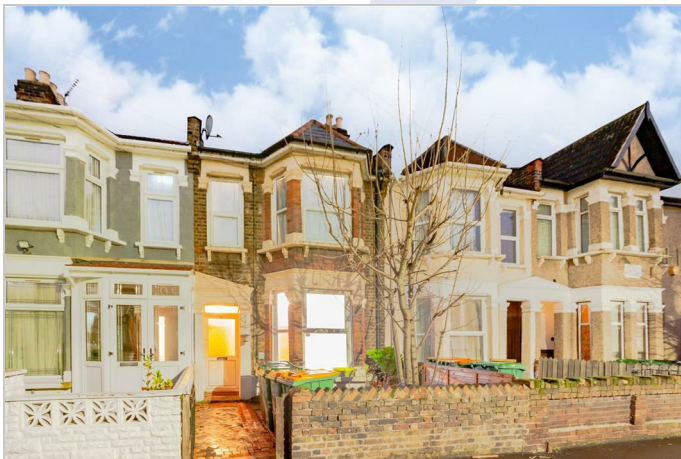

£1,350 Per month

145 Meanley Road, London, E12 6AS

McDowalls are pleased to bring to the market this 1 bedroom ground floor garden flat on Meanley Rd just off the Romford Road (E12 6AS) in Manor Park.

Licensed for 3 people.

Features newly installed carpets
Gas Central Heating and Double Glazing
Property is unfurnished
White goods included

Council Tax - Band B (£1443 PA)
EPC - Band D

Viewings by appointment only

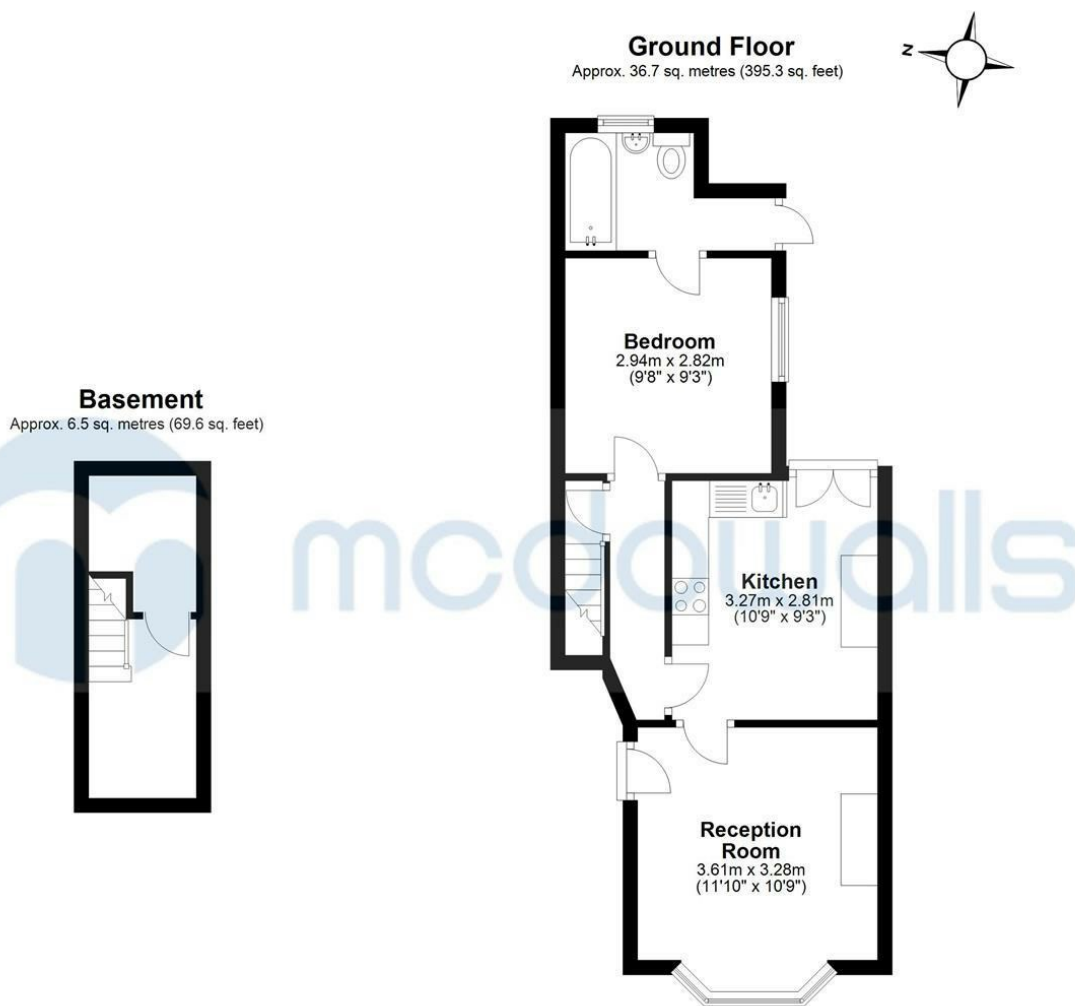

Total area: approx. 43.2 sq. metres (464.9 sq. feet)

Floor Plan measurements are approximate and are for illustrative purposes only.
Plan produced using PlanUp.

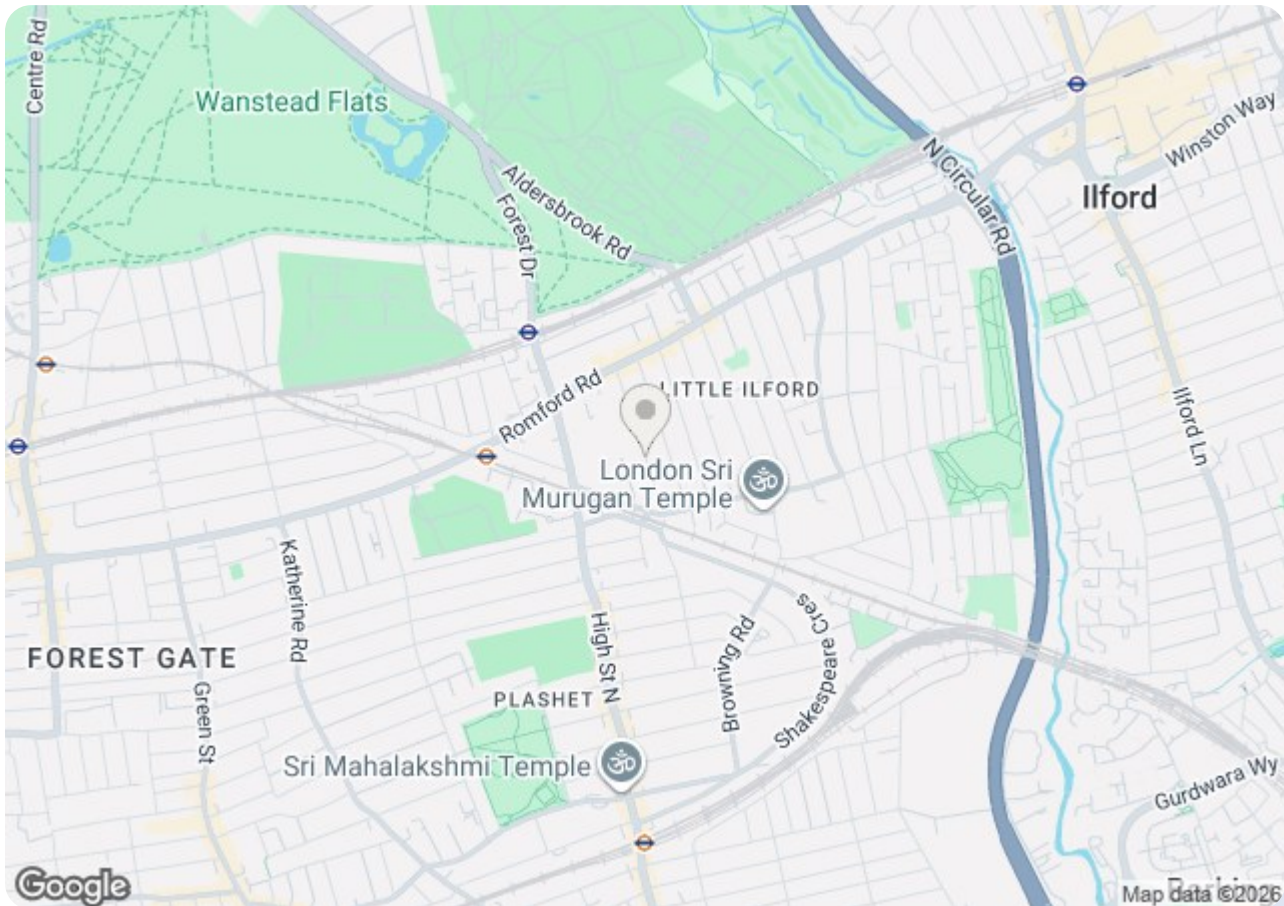

Energy Efficiency Rating		
	Current	Potential
Very energy efficient - lower running costs		
(92 plus) A		
(81-91) B		
(69-80) C		
(55-68) D		
(39-54) E		
(21-38) F		
(1-20) G		
Not energy efficient - higher running costs		
England & Wales	EU Directive 2002/91/EC	

Environmental Impact (CO ₂) Rating		
	Current	Potential
Very environmentally friendly - lower CO ₂ emissions		
(92 plus) A		
(81-91) B		
(69-80) C		
(55-68) D		
(39-54) E		
(21-38) F		
(1-20) G		
Not environmentally friendly - higher CO ₂ emissions		
England & Wales	EU Directive 2002/91/EC	