

141 Field Road, London, E7 9DH

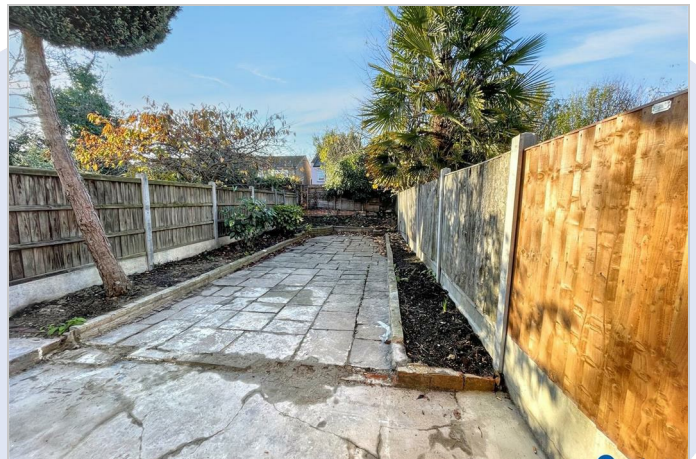

£2,750 (from) PCM

141 Field Road, London, E7 9DH

McDowalls are delighted to present this stylishly refurbished three bedroom terraced house to the rental market. Situated on a quiet residential street in Forest Gate, this newly renovated home features two receptions, a large open kitchen and a ground floor tiled shower room. Upstairs includes three well sunlit bedrooms, two doubles and a single as well as an additional tiled shower room.

Other features include two storage cupboards, a basement and sizable garden. The property is unfurnished and does not include white goods.

With great transport links via the Elizabeth Line and the Overground, the house is a ten minute walk from Forest Gate Station / High Street and Wanstead Park Station, providing excellent access to local amenities and shops.

- PARKING - LBN Street Parking Permit Required
- LOCAL AUTHORITY - London Borough of Newham
- COUNCIL TAX - TBC
- EPC - Band C
- WATER / SEWAGE - Mains
- GAS - Mains
- ELECTRIC - Mains

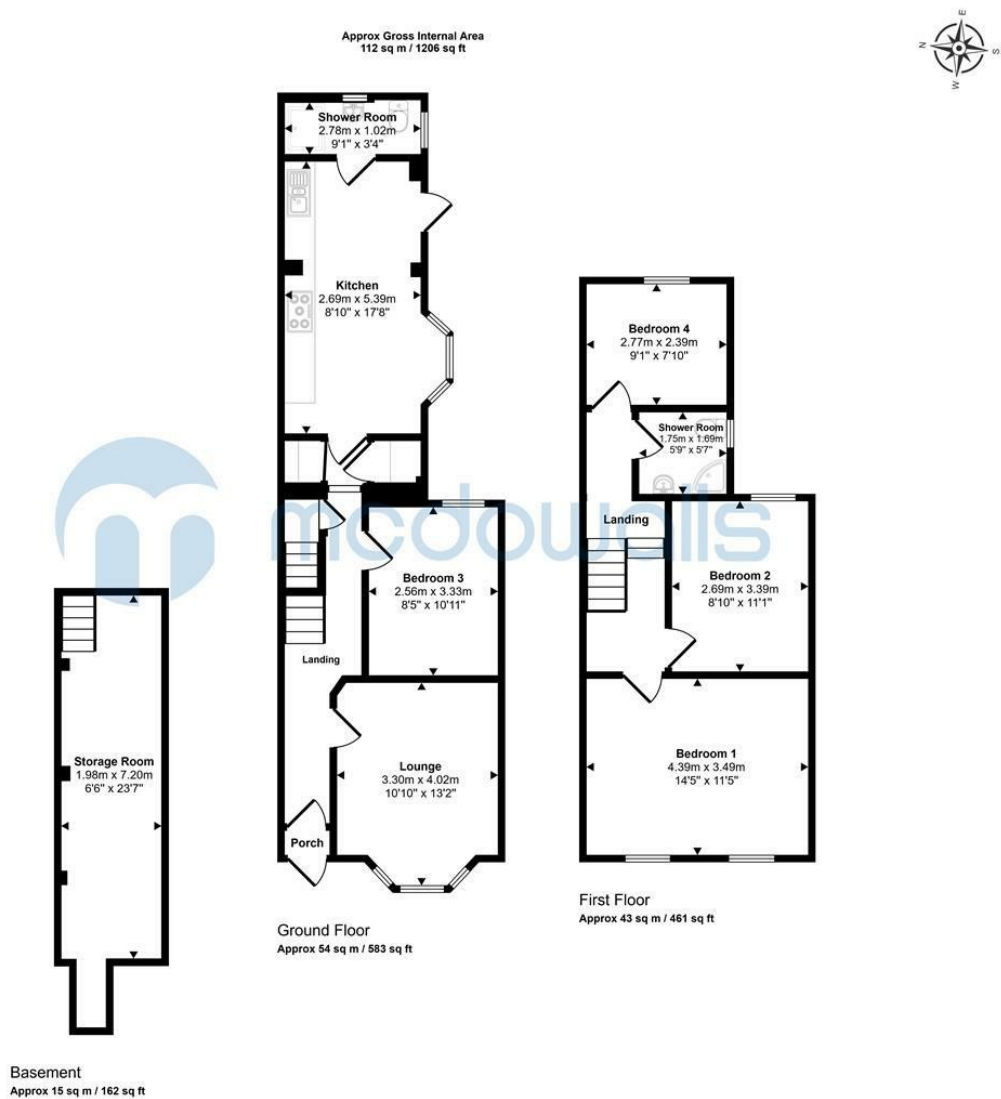

This floorplan is only for illustrative purposes and is not to scale. Measurements of rooms, doors, windows, and any items are approximate and no responsibility is taken for any error, omission or mis-statement. Icons of items such as bathroom suites are representations only and may not look like the real items. Made with Made Snappy 360.

54/56 Barking Road
East Ham, London E6 3BP
Telephone: (020) 8472 4422
Property Management: (020) 8471 4224
Fax: (020) 8471 5052
E-mail: eastham@mcdowalls.com
Website: www.mcdowalls.com

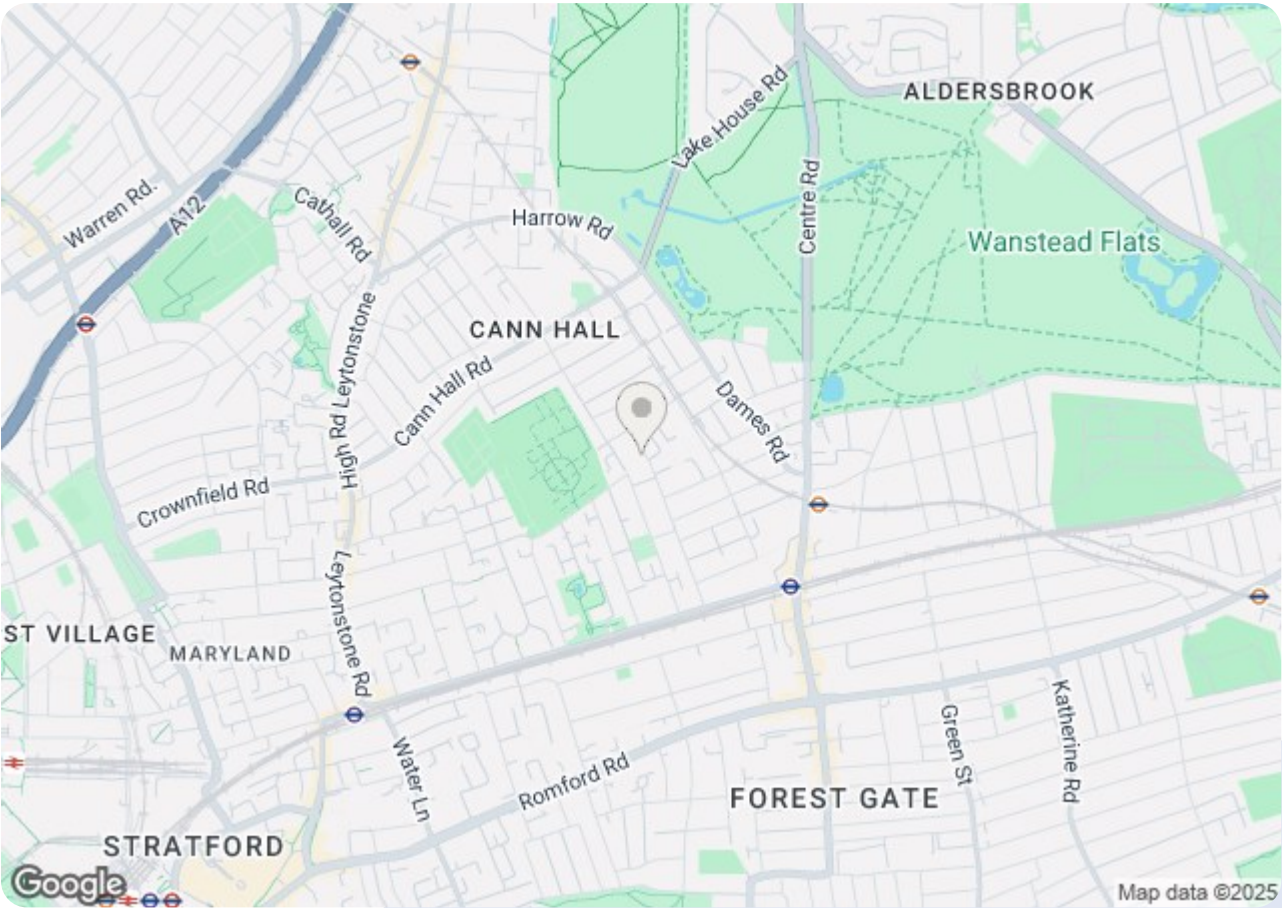

Energy Efficiency Rating		
	Current	Potential
Very energy efficient - lower running costs		
(92 plus) A		
(81-91) B		
(69-80) C		
(55-68) D		
(39-54) E		
(21-38) F		
(1-20) G		
Not energy efficient - higher running costs		
England & Wales	EU Directive 2002/91/EC	

Environmental Impact (CO ₂) Rating		
	Current	Potential
Very environmentally friendly - lower CO ₂ emissions		
(92 plus) A		
(81-91) B		
(69-80) C		
(55-68) D		
(39-54) E		
(21-38) F		
(1-20) G		
Not environmentally friendly - higher CO ₂ emissions		
England & Wales	EU Directive 2002/91/EC	