

**145 Meanley Road, London, E12 6AS**

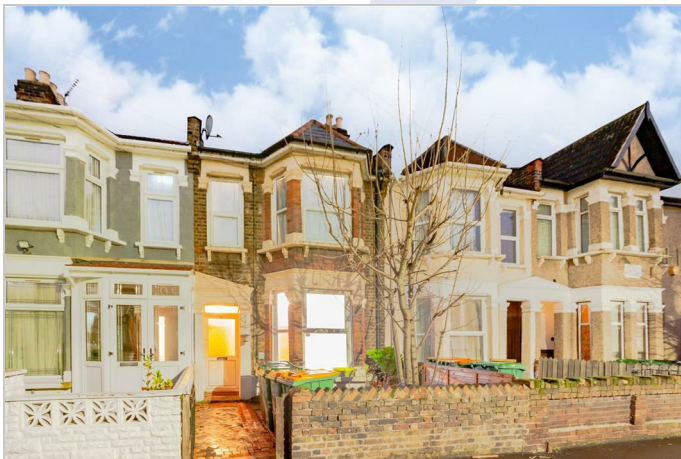

**£1,350 Per month**

## 145 Meanley Road, London, E12 6AS

McDowalls are pleased to bring to the market this 1 bedroom ground floor garden flat on Meanley Rd just off the Romford Road (E12 6AS) in Manor Park.

Licensed for 3 people.

Features newly installed carpets  
Gas Central Heating and Double Glazing  
Property is unfurnished  
White goods included

Council Tax - Band B (£1443 PA)  
EPC - Band D

Viewings by appointment only

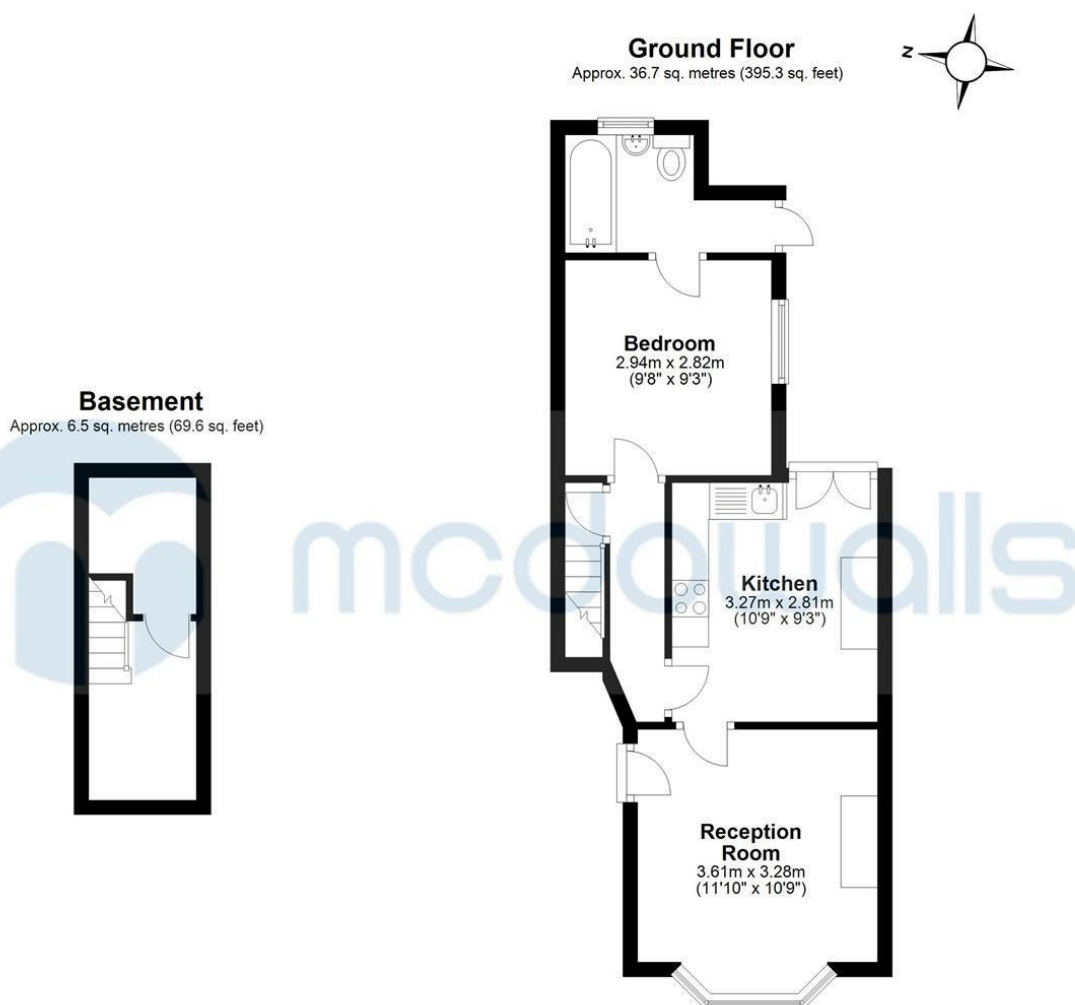

Total area: approx. 43.2 sq. metres (464.9 sq. feet)

Floor Plan measurements are approximate and are for illustrative purposes only.  
Plan produced using PlanUp.

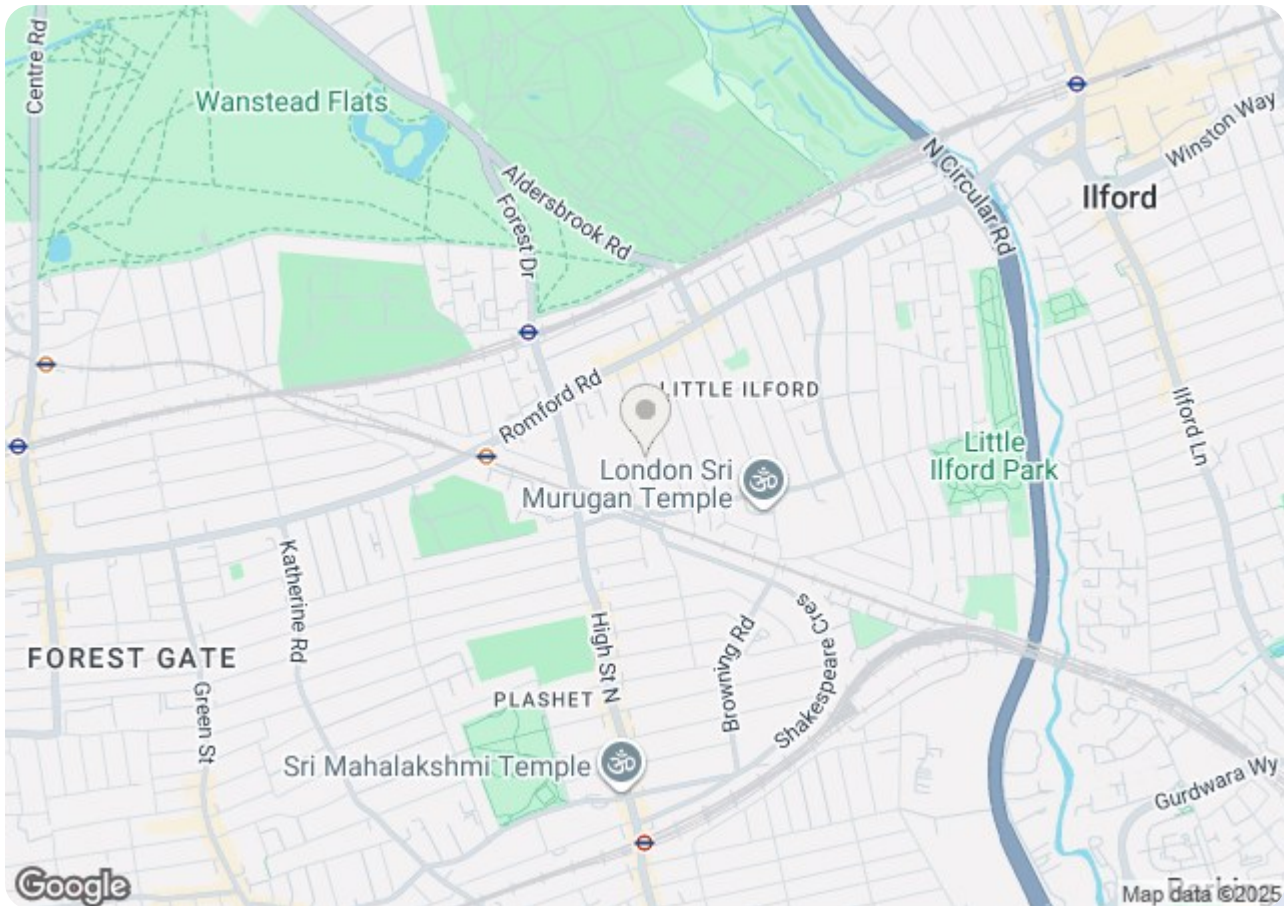

Energy Efficiency Rating		
	Current	Potential
Very energy efficient - lower running costs		
(92 plus) <b>A</b>		
(81-91) <b>B</b>		
(69-80) <b>C</b>		
(55-68) <b>D</b>		
(39-54) <b>E</b>		
(21-38) <b>F</b>		
(1-20) <b>G</b>		
Not energy efficient - higher running costs		
<b>England &amp; Wales</b>	EU Directive 2002/91/EC	

Environmental Impact (CO <sub>2</sub> ) Rating		
	Current	Potential
Very environmentally friendly - lower CO <sub>2</sub> emissions		
(92 plus) <b>A</b>		
(81-91) <b>B</b>		
(69-80) <b>C</b>		
(55-68) <b>D</b>		
(39-54) <b>E</b>		
(21-38) <b>F</b>		
(1-20) <b>G</b>		
Not environmentally friendly - higher CO <sub>2</sub> emissions		
<b>England &amp; Wales</b>	EU Directive 2002/91/EC	