



Red Barn, Turves Peterborough  
Offers in excess of **£375,000** **Freehold**

**Sharman  
Quinney**

# Key Features



- Detached Family Home
- Four Bedrooms
- Three Reception Rooms
- Three Bathrooms
- Separate W/C

This detached family home is nestled on a corner plot on Red Barn in the ever popular village of Turves. The property boasts large accommodation throughout and also benefits three reception rooms and three bathrooms making this the perfect family home! Red barn briefly comprises entrance hall, bay fronted lounge, kitchen/breakfast room, dining room, utility room and downstairs w/c. Upstairs are four bedrooms with both bedroom one and two benefitting from their own en-suites shower rooms. Upstairs is also the family bathroom. To the rear is an enclosed rear garden mainly laid to patio with a grassed area. The rear garden also houses a brick and wooden purpose built kennel area. To the front of the property is a large gravelled driveway providing off road parking for ample cars. Red Barn also benefits from its own double integral



garage

Entrance Hall - 2.00m (6'5") x 4.46m (14'6")

Kitchen/Breakfast Room - 6.27m (20'5") x 4.03m (13'2")

Lounge - 3.46m (11'4") x 5.31m (17'4")

Dining Room - 3.64m (11'4") x 4.03m (13'2")

Utility Room - 1.75m (5'7") x 4.03m (13'2")

W/C - 0.80m (2'7") x 4.03 (13'2")

Landing

Bedroom One - 3.94m (12'9") x 4.73m (15'6")

En-Suite One - 0.80m (2'7") x 2.53m (8'3")

Bedroom Two - 6.03m (19'8") x 3.40m (11'2")

En-Suite Two - 1.93m (6'3") x 2.46m (8'0")

Bedroom Three - 3.85m (12'6") x 4.30m (14'10")

Bedroom Four - 4.34m (14'2") x 3.82m (12'5")

Family Bathroom - 3.38m (11'4") x 3.00m (9'8")

Double Integral Garage - 6.04m (19'7") x 4.46m (14'6")



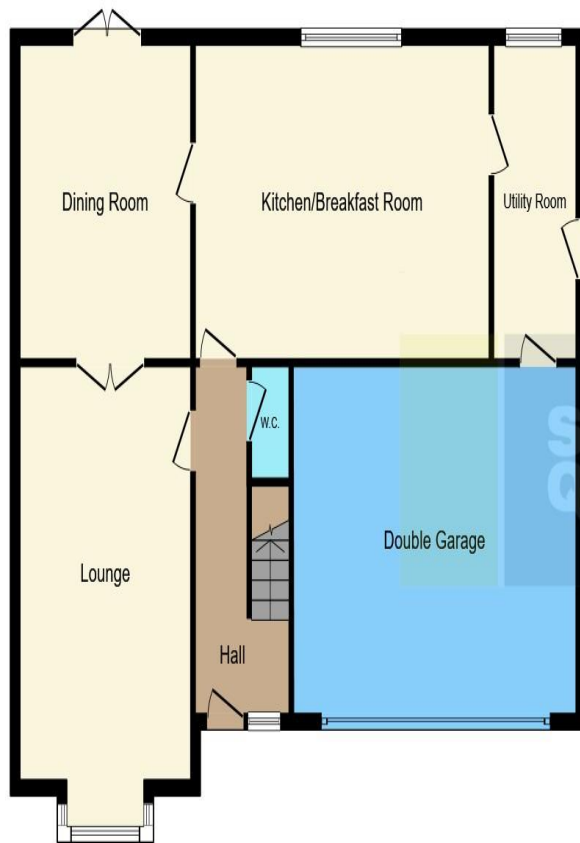

**Ground Floor**

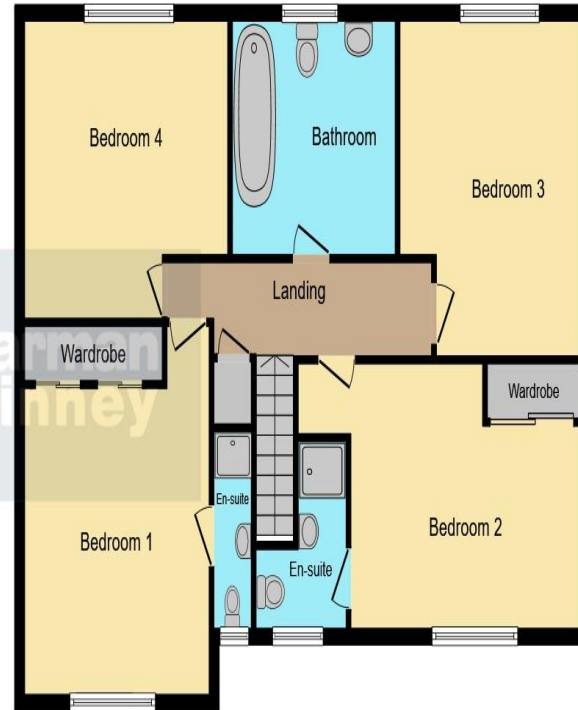

**First Floor**

This floor plan is for illustrative purposes only. It is not drawn to scale. Any measurements, floor areas (including any total floor area), openings and orientation are approximate. No details are guaranteed, they cannot be relied upon for any purpose and they do not form part of any agreement. No liability is taken for any error, omission or misstatement. A party must rely upon its own inspection(s). Powered by [www.focalagent.com](http://www.focalagent.com)

To view this property call Sharman Quinney on:  
**01733 205000**

# Selling your property?

Contact us to arrange a **FREE** home valuation.

 01733 205000

 46a Market Street, Whittlesey, PETERBOROUGH, Cambridgeshire, PE7 1BD

 whittlesey@sharmanquinney.co.uk

 [www.sharmanquinney.co.uk](http://www.sharmanquinney.co.uk)



 SCAN ME



Sharman Quinney Holdings Limited is registered in England and Wales under company number 4174227, Registered Office is Cumbria House, 16-20 Hockliffe Street, Leighton Buzzard, Bedfordshire, LU7 1GN. VAT Registration Number is 500 2481 05.

1: These particulars do not constitute part or all of an offer or contract. 2: The measurements indicated are supplied for guidance only and as such must be considered incorrect. 3: Potential buyers are advised to recheck the measurements before committing to any expense. 4: Sharman Quinney has not tested any apparatus, equipment, fixtures, fittings or services and it is the buyers interests to check the working condition of any appliances. 5: Sharman Quinney has not sought to verify the legal title of the property and buyers must obtain verification from their legal representative. 6: Intending purchasers will be asked to produce identification documentation at a later stage and we would ask your co-operation in order that there will be no delay in agreeing the sale. Ref: WHT202687 - 0001

