



Grounds Way, Whittlesey Peterborough
£230,000 Freehold

**Sharman
Quinney**

Key Features



- 15' Lounge and 15' kitchen/diner
- UPVc conservatory
- 13' Master bedroom
- Off road parking for two vehicles
- Enclosed rear garden

Entrance porch

Lounge 4.59m x 3.90m (15'1" x 12'10") maximum including staircase. Opening to:

Kitchen/diner 4.59m x 3.64m (15'1" x 11'11") opening to:

Conservatory 3.38m x 2.62m (11'1" x 8'6") maximum into recess

First floor landing

Bedroom one 4.03m x 2.65m (13'3" x 8'8") maximum into recess

Bedroom two 2.94m x 2.62m (9'8" x 8'7")



Bedroom three 2.51m x 1.87m (8'3" x 6'2")

Bathroom

Outside: The front is laid to lawn with ornamental shrubs and trees, driveway to the side providing off road parking with gated access to the rear garden. Enclosed rear garden mainly laid to lawn with patio area and ornamental flower beds.



GROUND FLOOR

1ST FLOOR

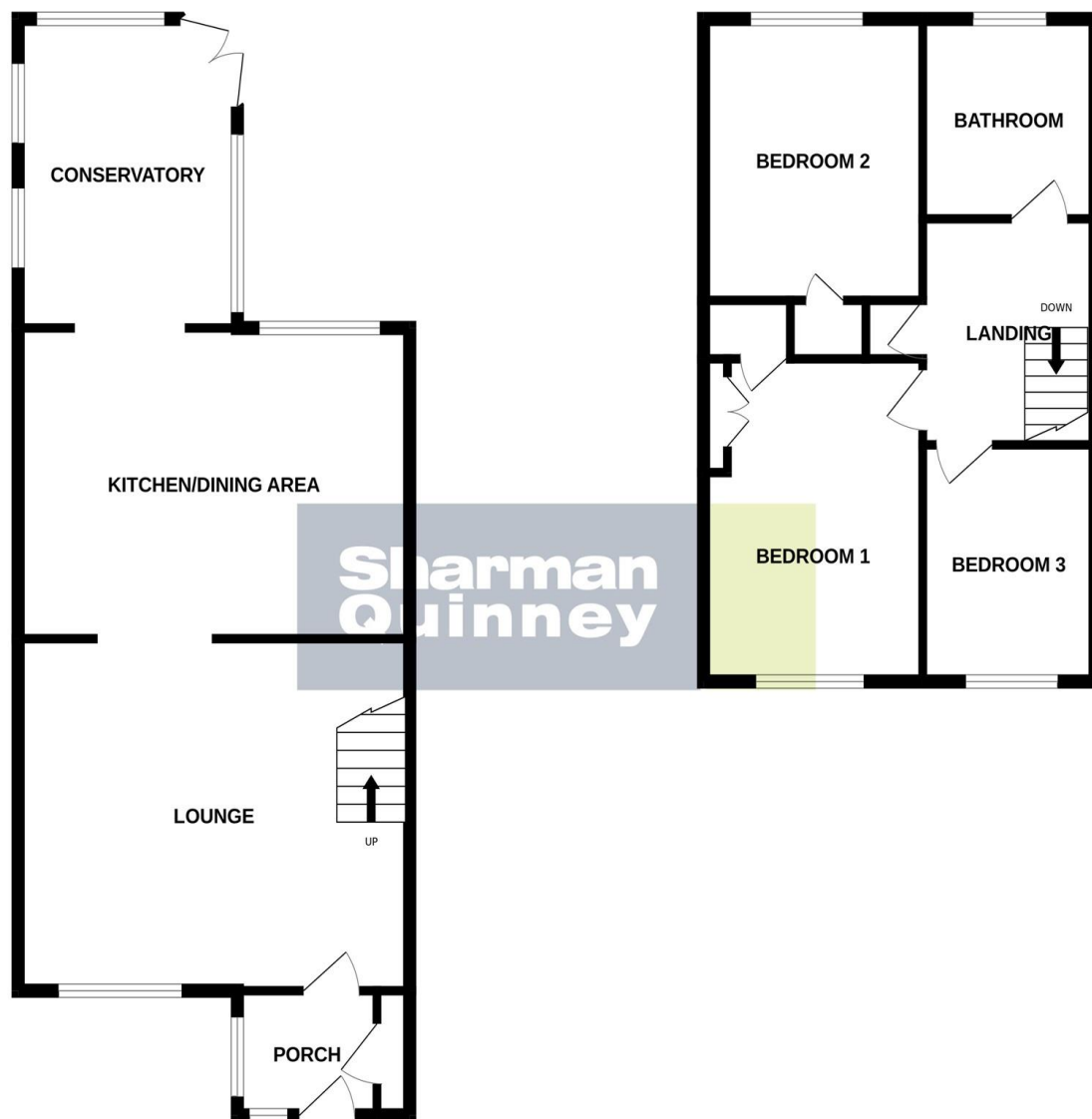

Whilst every attempt has been made to ensure the accuracy of the floorplan contained here, measurements of doors, windows, rooms and any other items are approximate and no responsibility is taken for any error, omission or mis-statement. This plan is for illustrative purposes only and should be used as such by any prospective purchaser. The services, systems and appliances shown have not been tested and no guarantee as to their operability or efficiency can be given.

Made with Metropix ©2025

To view this property call Sharman Quinney on:
01733 205000

Selling your property?

Contact us to arrange a **FREE** home valuation.

 01733 205000

 46a Market Street, Whittlesey, PETERBOROUGH,
Cambridgeshire, PE7 1BD

 whittlesey@sharmanquinney.co.uk

 www.sharmanquinney.co.uk



 SCAN ME



Sharman Quinney Holdings Limited is registered in England and Wales under company number 4174227, Registered Office is Cumbria House, 16-20 Hockliffe Street, Leighton Buzzard, Bedfordshire, LU7 1GN. VAT Registration Number is 500 2481 05.

1: These particulars do not constitute part or all of an offer or contract. 2: The measurements indicated are supplied for guidance only and as such must be considered incorrect. 3: Potential buyers are advised to recheck the measurements before committing to any expense. 4: Sharman Quinney has not tested any apparatus, equipment, fixtures, fittings or services and it is the buyers interests to check the working condition of any appliances. 5: Sharman Quinney has not sought to verify the legal title of the property and buyers must obtain verification from their legal representative. 6: Intending purchasers will be asked to produce identification documentation at a later stage and we would ask your co-operation in order that there will be no delay in agreeing the sale. Ref: WHT204883 - 0001

