



Glenfields North, Whittlesey Peterborough  
**£140,000 Leasehold**

**Sharman  
Quinney**



# Key Features



60% Shared Ownership  
£261.82 Rent pcm

125 Years remaining as of 20 Sep 2019

£Ask Agent Ground Rent p/a

Review due: Ask Agent

£471.36 Service Charge p/a

Review due: 09/2026

- 60% Shared Ownership
- 4 years left on the NHBC
- 15' Living room and kitchen
- Downstairs cloakroom
- Beautifully presented throughout
- Parking for two vehicles
- Enclosed rear garden
- Cul de sac location



Living room 4.41m x 4.57m (14'5" x 15')  
maximum into recess and including staircase

Kitchen/breakfast room 4.6m x 2.96m (15'1" x 9'7") walk-in understairs cupboard

Rear lobby

Downstairs cloakroom

First floor landing

Bedroom one 3.66m x 4.58m (12' x 15') storage  
cupboard

Bedroom two 4.1m x 2.3m (13'5" x 7'6")

Bedroom three 2.98m x 2.18m (9'8" x 7'2")

Bathroom

Outside: Off road parking to the front for two  
vehicles. Enclosed rear garden mainly laid to lawn  
with paved patio area. Gated access to the side,  
leading to the front.

Agent's notes: The current percentage of the  
Shared Ownership is 60%, this can be  
"staircased" meaning more percentage can be  
purchased.  
The current rent for the additional 40% is  
approximately £262 per month.  
The current service charge is approximately £40  
per month.





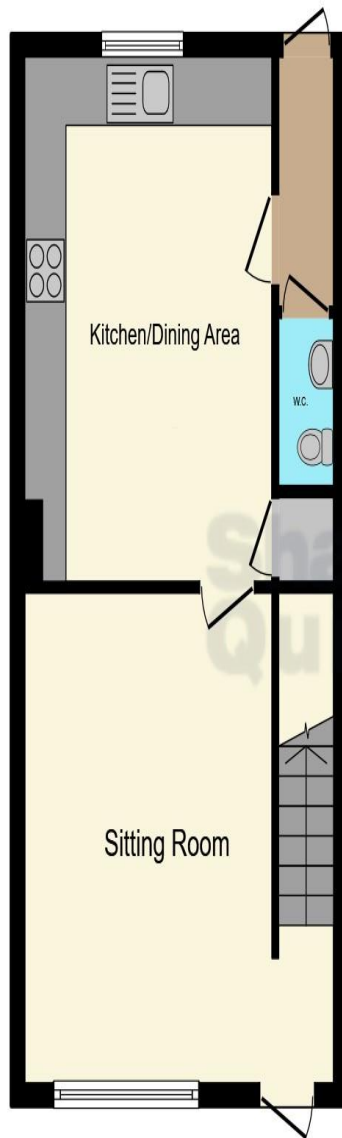

**Ground Floor**

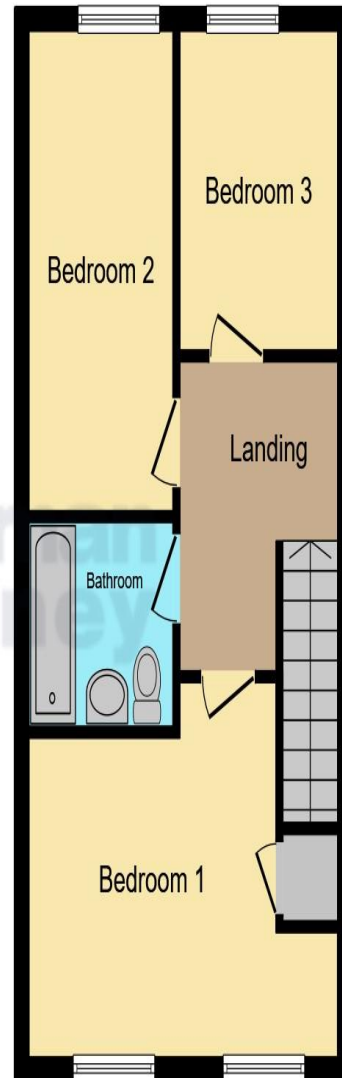

**First Floor**

This floor plan is for illustrative purposes only. It is not drawn to scale. Any measurements, floor areas (including any total floor area), openings and orientation are approximate. No details are guaranteed, they cannot be relied upon for any purpose and they do not form part of any agreement. No liability is taken for any error, omission or misstatement. A party must rely upon its own inspection(s). Powered by [www.focalagent.com](http://www.focalagent.com)

To view this property call Sharman Quinney on:  
**01733 205000**

# Selling your property?

**Contact us to arrange a FREE  
home valuation.**

**01733 205000**

46a Market Street, Whittlesey, PETERBOROUGH,  
Cambridgeshire, PE7 1BD

[whittlesey@sharmanquinney.co.uk](mailto:whittlesey@sharmanquinney.co.uk)

[www.sharmanquinney.co.uk](http://www.sharmanquinney.co.uk)



Sharman Quinney Holdings Limited is registered in England and Wales under company number 4174227, Registered Office is Cumbria House, 16-20 Hockliffe Street, Leighton Buzzard, Bedfordshire, LU7 1GN. VAT Registration Number is 500 2481 05.

1: These particulars do not constitute part or all of an offer or contract. 2: The measurements indicated are supplied for guidance only and as such must be considered incorrect. 3: Potential buyers are advised to recheck the measurements before committing to any expense. 4: Sharman Quinney has not tested any apparatus, equipment, fixtures, fittings or services and it is the buyers interests to check the working condition of any appliances. 5: Sharman Quinney has not sought to verify the legal title of the property and buyers must obtain verification from their legal representative. 6: Intending purchasers will be asked to produce identification documentation at a later stage and we would ask your co-operation in order that there will be no delay in agreeing the sale. Ref:WHT204611 -

0003

