



Viking Way, Whittlesey Peterborough  
**£280,000** **Freehold**

**Sharman  
Quinney**

# Key Features



- Detached Family Home
- Three Bedrooms
- Large Conservatory/Family Room
- Downstairs Cloakroom
- Oversized Single Garage

**MUST SEE PROPERTY!!** This stunning three bedroom detached home situated within walking distance to Whittlesey town centre and all local primary and secondary schools. The property is modern throughout and offers a large conservatory/family room, downstairs cloakroom and an oversized single garage with driveway providing off road parking. The property briefly comprises, entrance hall, lounge, modern fitted kitchen, large conservatory/family room with a warm roof and downstairs cloakroom. Upstairs are three well proportioned bedrooms, modern fitted bathroom with a bath and shower over and the airing cupboard which houses the combi boiler. Outside to the rear is a fully enclosed private rear garden mainly laid to lawn with a patio area. To the front of the property is a driveway leading to the oversized single garage which has an electric



shutter door and courtesy doors to both the house and the garden. This property has been very loved by the current owners and is a must see!

Entrance Hall - 1.76m x 2.37m (5'8" x 7'8")

Lounge - 3.3m x 6.03m (11'11" x 19'8")

Kitchen - 1.98m x 4.69m (6'5" x 15'4")

Conservatory/Family Room - 2.77m x 7.19m (9'1" x 23'6")

W/C - 0.76m x 1.49m (2'5" x 4'9")

Landing

Bedroom One - 3.08m x 4.23m (10'11" x 13'9")

Bedroom Two - 3.38m x 2.83m (11'10" x 9'3")

Bedroom Three - 2.01m x 2.83m (6'6" x 9'3")

Family Bathroom - 1.98m x 1.76m (6'5" x 5'8")

Garage - 3.6m x 5.09m (12'1" x 16'7")





**Ground Floor**

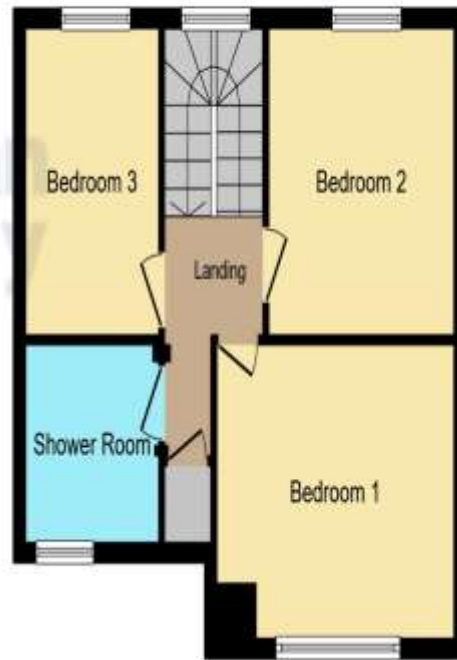

**First Floor**

This floor plan is for illustrative purposes only. It is not drawn to scale. Any measurements, floor areas (including any total floor area), openings and orientation are approximate. No details are guaranteed, they cannot be relied upon for any purpose and they do not form part of any agreement. No liability is taken for any error, omission or misstatement. A party must rely upon its own inspection(s). Powered by [www.focalagent.com](http://www.focalagent.com)

To view this property call Sharman Quinney on:  
**01733 205000**

# Selling your property?

Contact us to arrange a **FREE** home valuation.

 01733 205000

 46a Market Street, Whittlesey, PETERBOROUGH, Cambridgeshire, PE7 1BD

 whittlesey@sharmanquinney.co.uk

 [www.sharmanquinney.co.uk](http://www.sharmanquinney.co.uk)



 SCAN ME



Sharman Quinney Holdings Limited is registered in England and Wales under company number 4174227, Registered Office is Cumbria House, 16-20 Hockliffe Street, Leighton Buzzard, Bedfordshire, LU7 1GN. VAT Registration Number is 500 2481 05.

1: These particulars do not constitute part or all of an offer or contract. 2: The measurements indicated are supplied for guidance only and as such must be considered incorrect. 3: Potential buyers are advised to recheck the measurements before committing to any expense. 4: Sharman Quinney has not tested any apparatus, equipment, fixtures, fittings or services and it is the buyers interests to check the working condition of any appliances. 5: Sharman Quinney has not sought to verify the legal title of the property and buyers must obtain verification from their legal representative. 6: Intending purchasers will be asked to produce identification documentation at a later stage and we would ask your co-operation in order that there will be no delay in agreeing the sale. Ref: WHT204432 - 0001

