



Coates Road, Whittlesey Peterborough
Guide Price **£550,000 - £575,000** Freehold

**Sharman
Quinney**

Key Features



- Luxury Detached Family Home
- Four Bedrooms
- Three Reception Rooms
- Dressing Room to Bedroom One
- En-Suite to Bedroom One

This stunning four bedroom detached family home offers a versatile living accommodation with three reception rooms. The property is spacious throughout and no expense has been spared with the quality of finish. Coates Road briefly comprises: entrance hall, kitchen/dining room, lounge, office, utility room, salon and downstairs w/c. Upstairs there are four bedrooms with bedroom one benefitting from its own dressing room and separate en-suite and the family bathroom. Outside to the rear is an enclosed rear garden overlooking fields. To the front is a large gravelled driveway leading to a double garage which has been slightly converted.

Entrance Hall - 6.42m (21'1") x 4.21m (13'9")
Lounge - 3.87m (12'7") x 6.96m (22'9")
Kitchen/Dining Room - 8.60m (28'2" Max) x 4.32m



(14'2" Max)

Office - 2.7m (8'8") x 3.07m (10'1")

Salon - 2.31m (7'6") x 3.59m (11'8")

W/C - 1.60m (5'2") x 1.46m (4'8")

Landing

Bedroom One - 3.86m (12'7") x 4.37m (14'3")

Dressing Room - 1.60m (5'2") x 2.48m (8'1")

En-Suite - 2.11m (6'9") x 2.48 (8'1")

Bedroom Two - 4.17m (13'7") x 3.48m (11'4")

Bedroom Three - 3.16m (10'4") x 3.43m (11'3")

Bedroom Four - 2.98m (9'8") x 2.42m (7'10")

Family Bathroom - 2.98m (9'8") x 1.79m (8'9")

Garage - 5.53m (18'2") x 5.42m (17'8")





Ground Floor

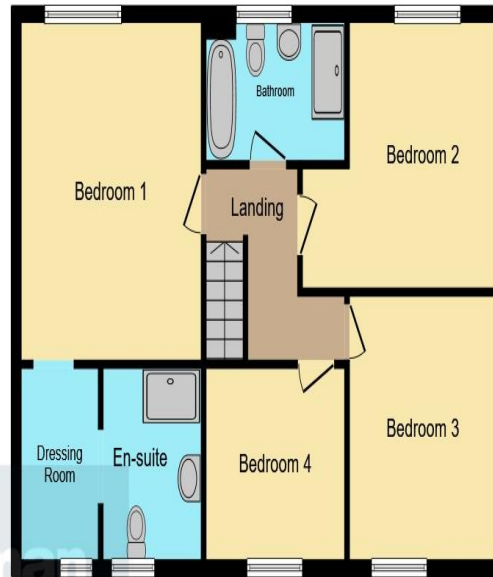

First Floor

This floor plan is for illustrative purposes only. It is not drawn to scale. Any measurements, floor areas (including any total floor area), openings and orientation are approximate. No details are guaranteed, they cannot be relied upon for any purpose and they do not form part of any agreement. No liability is taken for any error, omission or misstatement. A party must rely upon its own inspection(s). Powered by www.focalagent.com

To view this property call Sharman Quinney on:
01733 205000

Selling your property?

Contact us to arrange a **FREE** home valuation.

 01733 205000

 46a Market Street, Whittlesey, PETERBOROUGH, Cambridgeshire, PE7 1BD

 whittlesey@sharmanquinney.co.uk

 www.sharmanquinney.co.uk



 SCAN ME



Sharman Quinney Holdings Limited is registered in England and Wales under company number 4174227, Registered Office is Cumbria House, 16-20 Hockliffe Street, Leighton Buzzard, Bedfordshire, LU7 1GN. VAT Registration Number is 500 2481 05.

1: These particulars do not constitute part or all of an offer or contract. 2: The measurements indicated are supplied for guidance only and as such must be considered incorrect. 3: Potential buyers are advised to recheck the measurements before committing to any expense. 4: Sharman Quinney has not tested any apparatus, equipment, fixtures, fittings or services and it is the buyers interests to check the working condition of any appliances. 5: Sharman Quinney has not sought to verify the legal title of the property and buyers must obtain verification from their legal representative. 6: Intending purchasers will be asked to produce identification documentation at a later stage and we would ask your co-operation in order that there will be no delay in agreeing the sale. Ref: WHT203700 - 0003

