



Red Barn, Whittlesey Peterborough
£280,000 Freehold

**Sharman
Quinney**

Key Features



- Detached Family Home
- Four Bedrooms
- Two Reception Rooms
- Utility Room
- Downstairs W/C

This fantastic value for money four bedroom detached home is not to be missed. Sat in the village of turves just a short drive to Whittlesey and the local amenities. Looking for a village lifestyle but surrounded by lots of open fields then look no further! The property briefly comprises: Entrance hall, kitchen, sitting room, dining room, utility room and downstairs wc. Upstairs are four very good sized bedrooms with bedroom one benefitting from its own en-suite. To the rear is a fully enclosed rear garden mainly laid to lawn with a small patio area. To the front is a driveway providing off road parking and a single integral garage.

Entrance Hall - 2.22m x 4.45m (7'2" x 14'6")

Lounge - 6.10m x 3.38m (20' x 11'1")

Dining Room - 3.00m x 3.50m (9'10" x 11'6")



Kitchen - 4.45m x 3.51m (14'6" x 10'3")
W/C -
Utility Room - 1.43m x 3.51m (4'6" x 10'3")
First Floor Landing:
Bedroom 1 - 4.72m x 3.33m (15'6" x 10'11")
Ensuite - 1.23m x 3.04m (4'0" x 9'9")
Bedroom 2 - 4.06m x 2.77m (13'4" x 9'1")
Bedroom 3 - 3.71m x 2.21m (12'2" x 7'3")
Bedroom 4 - 3.93m x 2.42m (12'9" x 7'9")
Family Bathroom - 1.95m x 3.51m (6'4" x 10'3")



GROUND FLOOR

1ST FLOOR

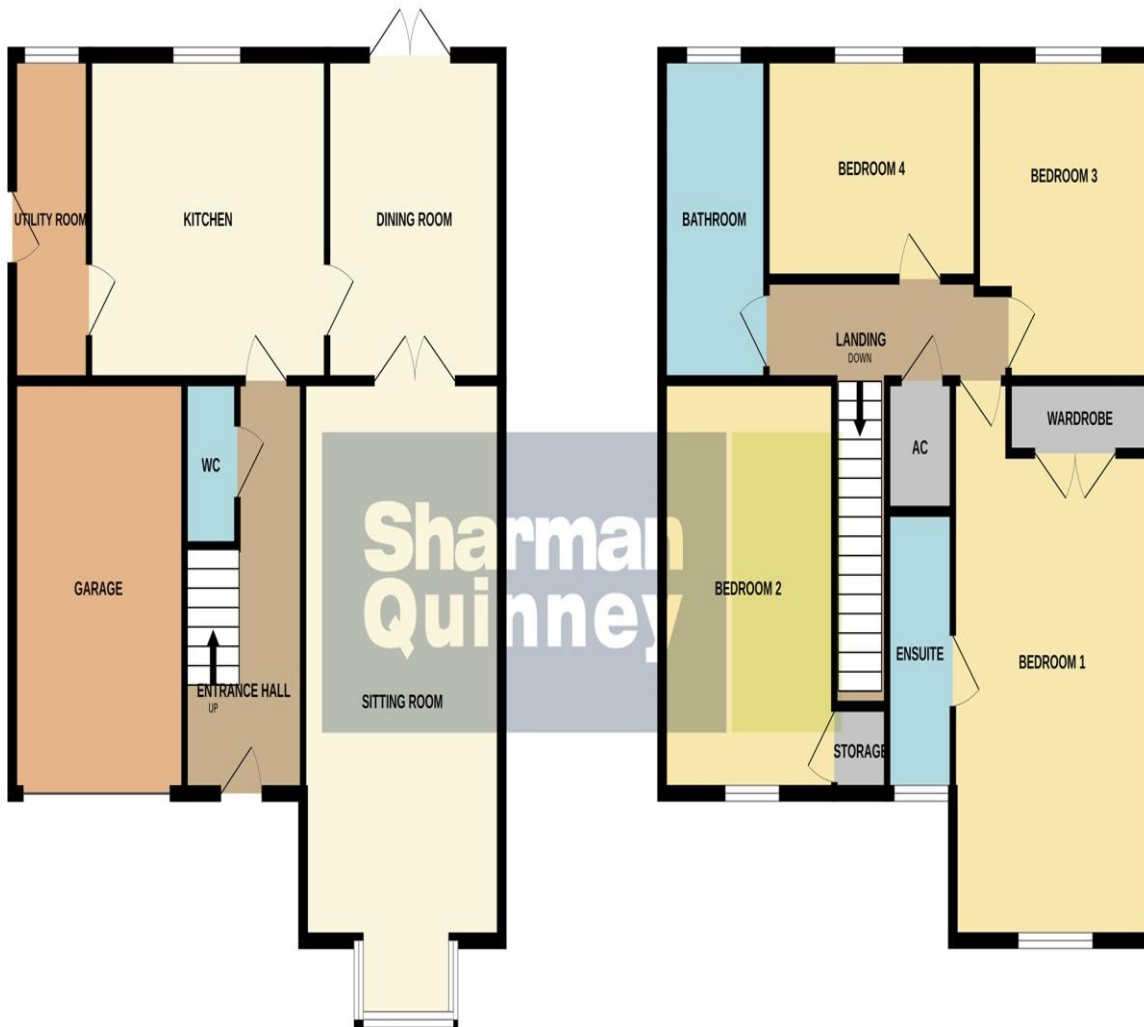

Whilst every attempt has been made to ensure the accuracy of the floorplan contained here, measurements of doors, windows, rooms and any other items are approximate and no responsibility is taken for any error, omission or mis-statement. This plan is for illustrative purposes only and should be used as such by any prospective purchaser. The services, systems and appliances shown have not been tested and no guarantee as to their operability or efficiency can be given.
Made with Metropix ©2024

To view this property call Sharman Quinney on:
01733 205000

Selling your property?

Contact us to arrange a **FREE** home valuation.

 01733 205000

 46a Market Street, Whittlesey, PETERBOROUGH, Cambridgeshire, PE7 1BD

 whittlesey@sharmanquinney.co.uk

 www.sharmanquinney.co.uk



 SCAN ME



Sharman Quinney Holdings Limited is registered in England and Wales under company number 4174227, Registered Office is Cumbria House, 16-20 Hockliffe Street, Leighton Buzzard, Bedfordshire, LU7 1GN. VAT Registration Number is 500 2481 05.

1: These particulars do not constitute part or all of an offer or contract. 2: The measurements indicated are supplied for guidance only and as such must be considered incorrect. 3: Potential buyers are advised to recheck the measurements before committing to any expense. 4: Sharman Quinney has not tested any apparatus, equipment, fixtures, fittings or services and it is the buyers interests to check the working condition of any appliances. 5: Sharman Quinney has not sought to verify the legal title of the property and buyers must obtain verification from their legal representative. 6: Intending purchasers will be asked to produce identification documentation at a later stage and we would ask your co-operation in order that there will be no delay in agreeing the sale. Ref: WHT204245 - 0003

