



Farrow Avenue, Hampton Vale Peterborough
£310,000 Freehold

**Sharman
Quinney**

Key Features



- Semi-Detached House
- 3 Storey Living
- 4 Bedrooms
- Kitchen/Breakfast Room
- Lounge/Dining Room
- En-Suite to Bedroom 1
- Landscaped Garden
- Garage

The accommodation includes on the ground floor, downstairs cloakroom, The smart upgraded kitchen/ breakfast room with its modern integrated appliances makes it perfect for the aspiring chef in you, the cozy lounge/diner is a wonderful room to relax and unwind in after a long day, whilst admiring the views of the recently landscaped rear garden.

As we step upstairs to the first floor the two well-proportioned bedrooms are ideal for the children, family bathroom, then onto the second floor you'll find bedroom 1 boasting an en-suite shower room



providing a touch of luxury and privacy, the additional bedroom would be ideal for guests or even home office, depending on your personal needs.

Outside the property overlooks the square, the rear garden is a joy to behold having been recently landscaped, making it perfect for the family to enjoy their outdoor activities together. There is a shared driveway to the rear, accessed via private remote-controlled gates that lead to the single garage en bloc.

Entrance hallway

Downstairs cloakroom

Lounge/diner
4.42m x 3.91m (14'06" x 12'10")

Kitchen/ Breakfast room
4.83m x 2.39m max (15'10" x 7'10" max)

First floor Landing

Bedroom 2
3.91m x 3.76m (12'10" x 12'04")

Bedroom 4
3.38m x 1.88m (11'01" x 6'02")

Family bathroom



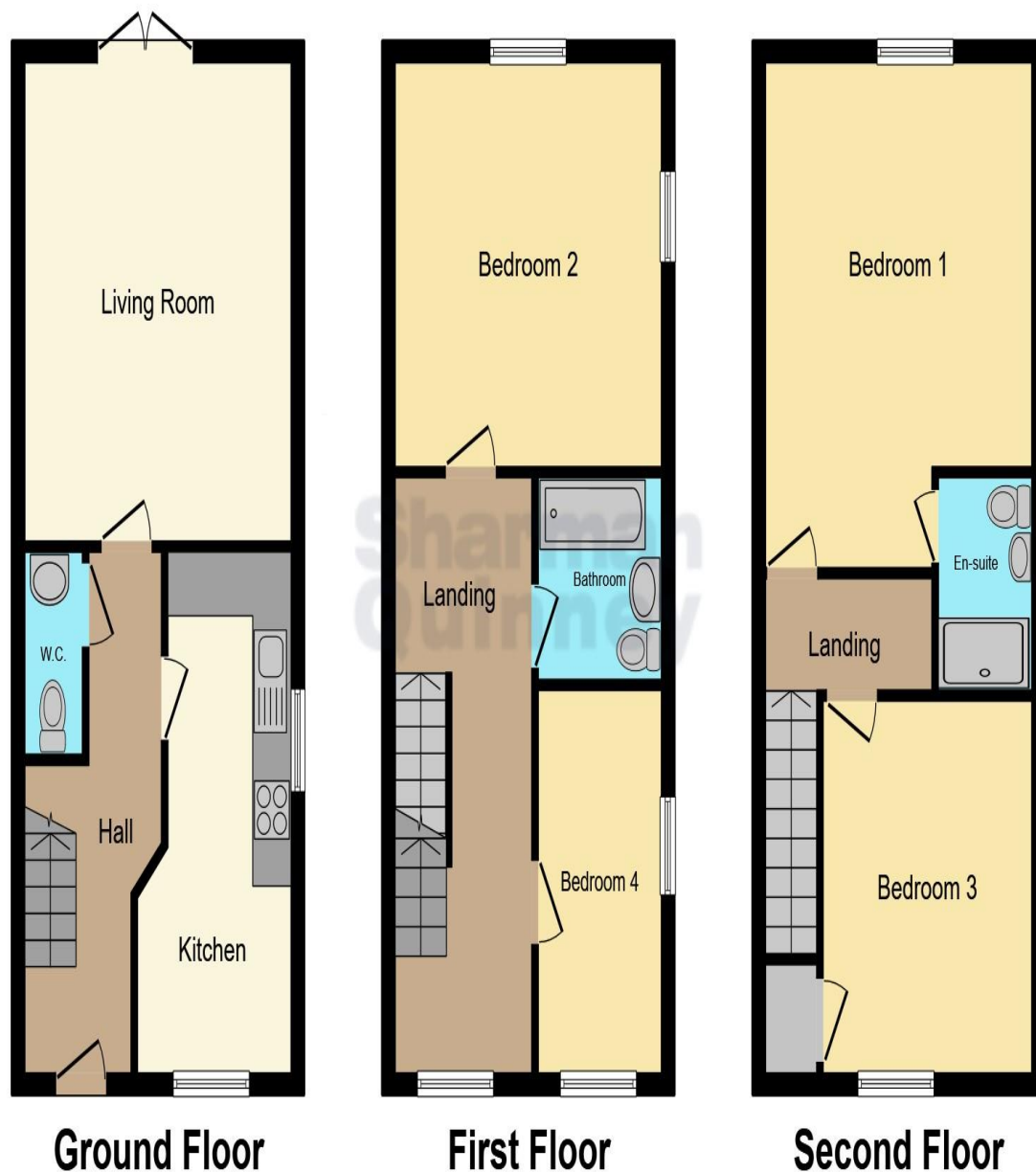

Stairs to second floor

Bedroom 1

4.67m max x 3.91m (15'04" max x 12'10")

En-suite

Bedroom 3

3.58m x 2.82m (11'09" x 9'03")

Outside the property overlooks the square, the rear garden is joy to behold having been recently landscaped, making it perfect for the family to enjoy their outdoor activities together. There is a shared driveway to the rear accessed via private remote controlled gates that lead to the single garage en bloc measuring 5.21m x 2.59m (17'01" x 8'06")

This floor plan is for illustrative purposes only. It is not drawn to scale. Any measurements, floor areas (including any total floor area), openings and orientation are approximate. No details are guaranteed, they cannot be relied upon for any purpose and they do not form part of any agreement. No liability is taken for any error, omission or misstatement. A party must rely upon its own inspection(s). Powered by www.focalagent.com

To view this property call Sharman Quinney on:
01733 346111

Selling your property?

Contact us to arrange a **FREE** home valuation.

 01733 346111

 50 Hargate Way, Hampton Hargate,
Peterborough, Cambridgeshire, PE7 8DS

 hampton@sharmanquinney.co.uk

 www.sharmanquinney.co.uk



 SCAN ME



Sharman Quinney Holdings Limited is registered in England and Wales under company number 4174227, Registered Office is Cumbria House, 16-20 Hockliffe Street, Leighton Buzzard, Bedfordshire, LU7 1GN. VAT Registration Number is 500 2481 05.

1: These particulars do not constitute part or all of an offer or contract. 2: The measurements indicated are supplied for guidance only and as such must be considered incorrect. 3: Potential buyers are advised to recheck the measurements before committing to any expense. 4: Sharman Quinney has not tested any apparatus, equipment, fixtures, fittings or services and it is the buyers interests to check the working condition of any appliances. 5: Sharman Quinney has not sought to verify the legal title of the property and buyers must obtain verification from their legal representative. 6: Intending purchasers will be asked to produce identification documentation at a later stage and we would ask your co-operation in order that there will be no delay in agreeing the sale. Ref: HAM202118 - 0003

