



Abbotsbury, Orton Malborne Peterborough
£200,000 Freehold

**Sharman
Quinney**

Key Features



- Extended Semi-Detached House
- Two Bedrooms
- Lounge
- Refitted Kitchen
- Separate Dining Room
- Off Road Parking

This property offers the perfect blend of modern living with traditional charm, as you step inside you are greeted by the warm and welcoming hallway leading you through to the light and airy lounge which is the perfect room to relax and unwind in after a long day's work.

The recently refitted kitchen is ideal with plenty of storage and preparation space making it ideal for the aspiring chef in you, adjacent is the lovely dining room, the space this room offers is amazing for the family to enjoy their evening meals together or for entertaining guests in.

As you go upstairs, you'll find the two well-proportioned bedrooms, bedroom 1 boasting built in wardrobes, the additional bedroom also comes with built in wardrobes ideal for the children



guests or home office, depending on your needs, family shower room.

Outside the driveway to the side provides off road parking for one car, the low maintenance rear garden offers ample space for the family to enjoy their outdoor activities together, or even for entertaining guests whilst enjoying your summer barbecues together.

Entrance porch

Lounge
5.82m x 3.40m max (19'01" x 11'02" max)

Refitted Kitchen
2.95m x 2.49m (9'08" x 8'02")

Dining room
4.85m x 3.0m max (15'11" x 9'10" max)

Utility room
2.24m x 2.03m (7'04" x 6'08")

First floor

Bedroom 1
3.70m ex wardrobe x 3.28m (12'02" ex wardrobe x 10'09")

Bedroom 2
2.62m x 2.46m ex wardrobe recess (8'07" x 8'01" ex wardrobe recess)





Ground Floor

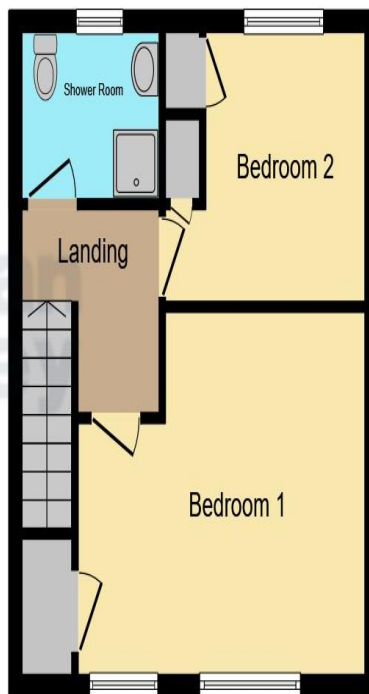

First Floor

Shower room

Outside the driveway to the side provides off road parking for one car, the low maintenance rear garden offers ample space for the family to enjoy their outdoor activities together, or even for entertaining guests.

Under the terms of the Estate Agency Act 1979 (section 21), please note that the vendor of this property is an Associate of an Employee of the Connells Group of companies.

This floor plan is for illustrative purposes only. It is not drawn to scale. Any measurements, floor areas (including any total floor area), openings and orientation are approximate. No details are guaranteed, they cannot be relied upon for any purpose and they do not form part of any agreement. No liability is taken for any error, omission or misstatement. A party must rely upon its own inspection(s). Powered by www.focalagent.com

To view this property call Sharman Quinney on:
01733 346111

Selling your property?

Contact us to arrange a **FREE** home valuation.

 01733 346111

 50 Hargate Way, Hampton Hargate,
Peterborough, Cambridgeshire, PE7 8DS

 hampton@sharmanquinney.co.uk

 www.sharmanquinney.co.uk



 SCAN ME



Sharman Quinney Holdings Limited is registered in England and Wales under company number 4174227, Registered Office is Cumbria House, 16-20 Hockliffe Street, Leighton Buzzard, Bedfordshire, LU7 1GN. VAT Registration Number is 500 2481 05.

1: These particulars do not constitute part or all of an offer or contract. 2: The measurements indicated are supplied for guidance only and as such must be considered incorrect. 3: Potential buyers are advised to recheck the measurements before committing to any expense. 4: Sharman Quinney has not tested any apparatus, equipment, fixtures, fittings or services and it is the buyers interests to check the working condition of any appliances. 5: Sharman Quinney has not sought to verify the legal title of the property and buyers must obtain verification from their legal representative. 6: Intending purchasers will be asked to produce identification documentation at a later stage and we would ask your co-operation in order that there will be no delay in agreeing the sale. Ref: HAM203646 - 0008

