



Yates Close, Weldon  
**£350,000** Freehold

**Sharman  
Quinney**



# Key Features



- A 'Persimmon built' four- bedroom detached family home
- Green open space to front
- Kitchen with built in hob and oven, breakfast bar
- Driveway with open plan front garden
- Four well-proportioned bedrooms, master with en-suite
- On completion this property will be converted to a Freehold

Overlooking a green open space is this family four-bedroom detached family home. In brief comprising lounge, kitchen/diner, conservatory, study and utility. To the first floor four bedrooms, family bathroom and en-suite to master. Gardens to rear and driveway for several vehicles.





## Ground Floor

Lounge - 11' 1" x 15' 9" (3.38m x 4.85m)

Kitchen/Diner- 10' 1" x 18' 3" (3.10m x 5.60m)

Conservatory - 9' 5" x 15' 1" (2.91m x 4.63m)

Study - back of garage converted 10' 3" x 8' 6" (3.15m x 2.63)

Utility - 5' 2" x 6' 9" (1.59m x 2.13m)

## First Floor

Bedroom One - 13' 3" x 12' 5" (4.07m x 3.83m)

Bedroom Two - 9' 3" x 12' 1" (2.85m max. x 3.71m)

Bedroom Three - 9' 3" x 9' 6" (2.84m x 2.93)

Bedroom Four - 7' 1" x 9' 6" (2.19m x 2.93)

Family Bathroom - Three-piece suite

## Outside

### Front

An open plan front garden with driveway for a number of vehicles. There is an open green space enclosed by mature hedging and trees.

### Rear

The rear garden is of a low maintenance design, having an immediate paved patio area with remainder of the garden being laid to gravel with a further decked patio area with gazebo. The garden is enclosed by low brick walling and timber panelled fencing.





**Ground Floor**

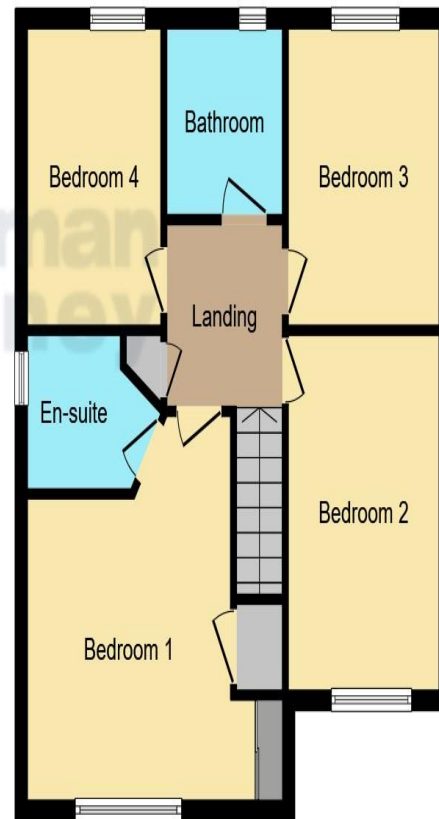

**First Floor**

Agent Note:  
On completion this property will be converted to a Freehold.

This floor plan is for illustrative purposes only. It is not drawn to scale. Any measurements, floor areas (including any total floor area), openings and orientation are approximate. No details are guaranteed, they cannot be relied upon for any purpose and they do not form part of any agreement. No liability is taken for any error, omission or misstatement. A party must rely upon its own inspection(s). Powered by [www.focalagent.com](http://www.focalagent.com)

To view this property call Sharman Quinney on:  
**01832 274567**

# Selling your property?

Contact us to arrange a **FREE** home valuation.

 01832 274567

 The Old Town Hall Market Place, Oundle, Peterborough, Cambridgeshire, PE8 4BQ

 [oundle@sharmanquinney.co.uk](mailto:oundle@sharmanquinney.co.uk)

 [www.sharmanquinney.co.uk](http://www.sharmanquinney.co.uk)



 SCAN ME



Sharman Quinney Holdings Limited is registered in England and Wales under company number 4174227, Registered Office is Cumbria House, 16-20 Hockliffe Street, Leighton Buzzard, Bedfordshire, LU7 1GN. VAT Registration Number is 500 2481 05.

1: These particulars do not constitute part or all of an offer or contract. 2: The measurements indicated are supplied for guidance only and as such must be considered incorrect. 3: Potential buyers are advised to recheck the measurements before committing to any expense. 4: Sharman Quinney has not tested any apparatus, equipment, fixtures, fittings or services and it is the buyers interests to check the working condition of any appliances. 5: Sharman Quinney has not sought to verify the legal title of the property and buyers must obtain verification from their legal representative. 6: Intending purchasers will be asked to produce identification documentation at a later stage and we would ask your co-operation in order that there will be no delay in agreeing the sale. Ref: OUN202516 - 0001

