



Primroses, Deeping St. James, Peterborough
£340,000 Freehold

**Sharman
Quinney**

Key Features



- Detached House
- Four Bedrooms
- Separate Dining Room
- En Suite
- Conservatory

Accommodation Includes

Front door to:

Entrance Hall

Window to front, stairs to first floor and landing, understairs storage cupboard, window to front.

Lounge

3.57m x 4.83m (11'8" x 15'10"). Gas fire with feature fire place, window to front aspect, radiator, double doors to:

Dining Room

2.85m x 3.94m (9'4" x 12'11"). Radiator, French doors leading to:



Conservatory

4.40m max x 2.88m (14'5" max x 9'5"). Brick and upvc construction, polycarbonate roof, French doors leading to rear garden.

Kitchen

4.61m x 2.69m (15'1" x 8'10"). Fitted with a matching range of base and eye level units with worktops over, built in microwave, built in electric oven, gas hob and extractor, sink with mixer taps, plumbing for washing machine, plumbing for dishwasher, space for fridge freezer door to side.

Stairs to First Floor and Landing

Window to side, airing cupboard.

Bedroom One

2.66m x 4.09m (8'8" x 13'5"). Window to front, radiator, door to:

En Suite

Comprising wc, wash hand basin with cupboard below, shower cubicle, radiator.

Bedroom Two

3.12m x 2.66m (10'3" x 8'8"). Window to rear, radiator, built in wardrobe.

Bedroom Three

2.76m x 2.33m (9' x 7'7"). Window to rear radiator.



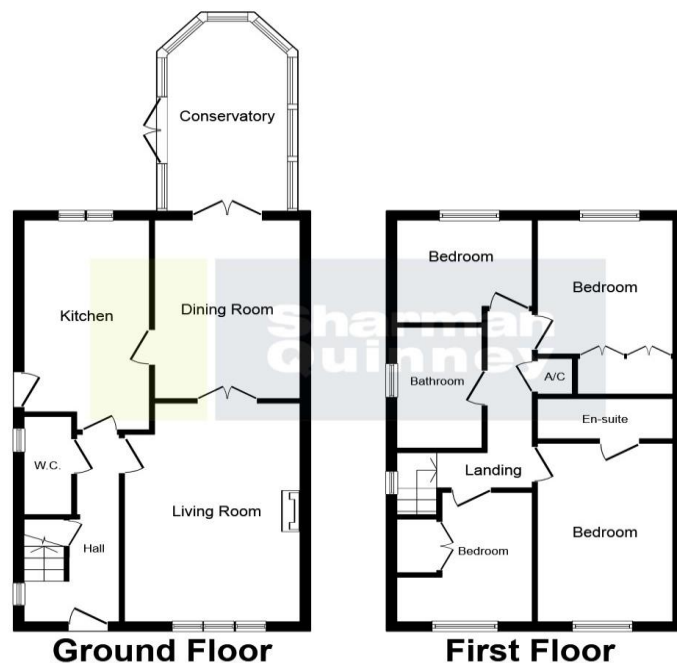

This plan is for illustration purposes only and may not be representative of the property. Plan not to scale.

Powered by audioagent.com

Bedroom Four
3.09m x 2.76m (10'1" x 9'). Window to front radiator, loft access, built in wardrobe.

Bathroom
Comprising panel bath with mixer taps, pedestal wash hand basin, wc, radiator, window to side.

Outside
The rear garden is laid to lawn with patio area and corner deck area. Enclosed with timber fence surround and side gate access. There is a courtesy door leading to the detached single garage.
To the front there is a driveway leading to a single garage with metal up and over door power and light connected.

To view this property call Sharman Quinney on:
01778 343322

Selling your property?

Contact us to arrange a **FREE**
home valuation.

 01778 343322

 25 Market Place, Market Deeping,
PETERBOROUGH, Cambridgeshire, PE6 8EA

 marketdeeping@sharmanquinney.co.uk

 www.sharmanquinney.co.uk



 SCAN ME



Sharman Quinney Holdings Limited is registered in England and Wales under company number 4174227, Registered Office is Cumbria House, 16-20 Hockliffe Street, Leighton Buzzard, Bedfordshire, LU7 1GN. VAT Registration Number is 500 2481 05.

1: These particulars do not constitute part or all of an offer or contract. 2: The measurements indicated are supplied for guidance only and as such must be considered incorrect. 3: Potential buyers are advised to recheck the measurements before committing to any expense. 4: Sharman Quinney has not tested any apparatus, equipment, fixtures, fittings or services and it is the buyers interests to check the working condition of any appliances. 5: Sharman Quinney has not sought to verify the legal title of the property and buyers must obtain verification from their legal representative. 6: Intending purchasers will be asked to produce identification documentation at a later stage and we would ask your co-operation in order that there will be no delay in agreeing the sale. Ref: MRD203928 - 0003

