



Starsmore Fields, Baston, Peterborough  
fixed price £275,000 **Freehold**

**Sharman  
Quinney**



# Key Features



- Detached Bungalow
- Over 55's Development
- Enclosed Rear Garden
- Village Location
- Two Bedrooms

## Accommodation Includes

Door to:

Entrance Hall

Radiator, window to side, loft access, built in cloak storage cupboard, boiler cupboard with combination boiler.

Kitchen-Diner

3.61m x 4.31m (11'10" x 14'1"). Fitted with a range of base and eye level units with worktops over, stainless steel sink and drainer with mixer taps, electric oven, induction hob and extractor, integrated fridge freezer, washing machine and dishwasher, radiator, French doors with fitted blinds leading to the rear garden.



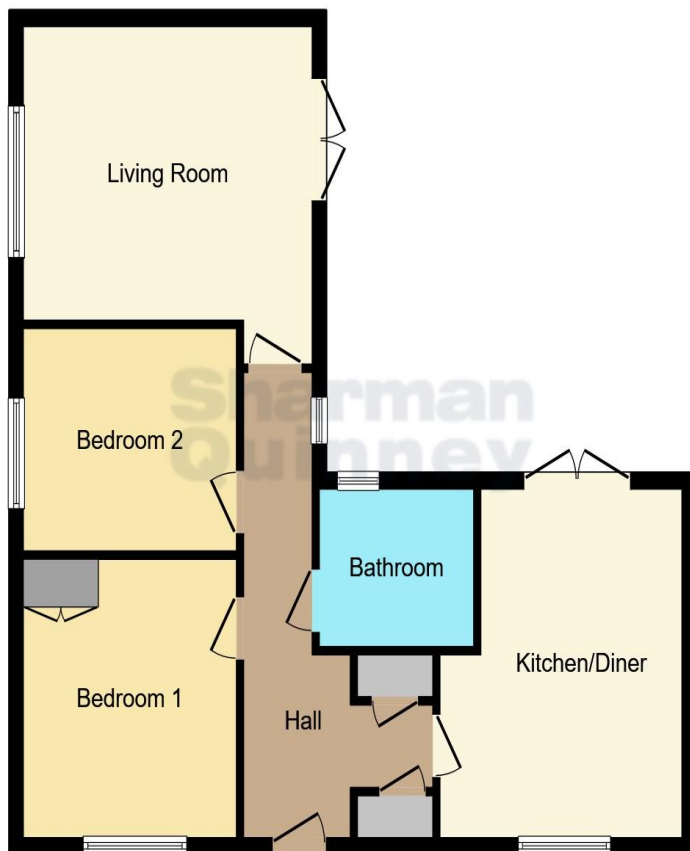

This floor plan is for illustrative purposes only. It is not drawn to scale. Any measurements, floor areas (including any total floor area), openings and orientation are approximate. No details are guaranteed, they cannot be relied upon for any purpose and they do not form part of any agreement. No liability is taken for any error, omission or misstatement. A party must rely upon its own inspection(s). Powered by [www.focalagent.com](http://www.focalagent.com)

#### Lounge

3.76m x 4.31m (12'4" x 14'1"). Feature fire place, window to front, French doors with fitted blinds leading to rear garden

#### Bedroom One

3.10m x 3.49m (10'2" x 11'5"). Window with fitted blind to front, built in double wardrobe, radiator.

#### Bedroom Two

3.10m x 2.71m (10'2" x 8'10"). Window with fitted blind to side, radiator.

#### Shower Room

Walk in shower cubicle, WC, pedestal wash hand basin, heated towel rail.

#### Outside

The bungalow occupies a corner plot. The rear garden is laid to lawn with paved patio area Arbour and pergola and enclosed with wood panel fencing with side gate access. To the front and side, the property is laid to lawn with shrubs and paved double width driveway providing parking.

#### Agents Note

There are owned solar panels on the property.

To view this property call Sharman Quinney on:  
**01778 343322**

# Selling your property?

Contact us to arrange a **FREE**  
home valuation.

 01778 343322

 25 Market Place, Market Deeping,  
PETERBOROUGH, Cambridgeshire, PE6 8EA

 marketdeeping@sharmanquinney.co.uk

 [www.sharmanquinney.co.uk](http://www.sharmanquinney.co.uk)



 SCAN ME



Sharman Quinney Holdings Limited is registered in England and Wales under company number 4174227, Registered Office is Cumbria House, 16-20 Hockliffe Street, Leighton Buzzard, Bedfordshire, LU7 1GN. VAT Registration Number is 500 2481 05.

1: These particulars do not constitute part or all of an offer or contract. 2: The measurements indicated are supplied for guidance only and as such must be considered incorrect. 3: Potential buyers are advised to recheck the measurements before committing to any expense. 4: Sharman Quinney has not tested any apparatus, equipment, fixtures, fittings or services and it is the buyers interests to check the working condition of any appliances. 5: Sharman Quinney has not sought to verify the legal title of the property and buyers must obtain verification from their legal representative. 6: Intending purchasers will be asked to produce identification documentation at a later stage and we would ask your co-operation in order that there will be no delay in agreeing the sale. Ref:

MRD204061 - 0008