

**sharman
Quinney**

www.sharmanquinney.co.uk
MARKET DEEPING 01778 343322

for sale

Beech Close, Market Deeping
Offers Over £275,000 Freehold

**Sharman
Quinney**

Key Features



- Detached House
- Corner Plot
- Cul De Sac
- Three Bedrooms
- Lounge/Diner

Accommodation includes

Front door to

Entrance hall
Radiator, stairs to first floor and landing.

Lounge/Diner
4.37m max x 7.10m (14'4" x 23'3"). Feature fire place, radiator x 2, bay window to front, French doors to rear.



Kitchen

2.80m x 3.41m (9'2" x 11'2). Range of base and eye level units with worktops over, electric oven, gas hob and extractor, sink, plumbing for washing machine, boiler, understairs storage cupboard, space for fridge freezer, door to side.

Stairs to first floor and landing

Loft access, window to side, storage cupboard.

Bedroom One

3.53m max x 3.92m max (11'7" max x 12'10" max). Window to front, radiator.

Bedroom Two

3.53m x 3.43m (11'7" x 11'3"). Window to rear, radiator.

Bedroom Three

2.56m x 2.28m (8'4" x 7'5"). Window to front, radiator.

Bathroom

Refitted and comprising of w/c, wash hand basin, panel bath and shower, window to rear, radiator towel rail.

Outside

To the rear of the property the garden is lawned with patio area. The property is located on a corner plot and has a brick wall and wood fence surround with side and rear gate access. There is a drive way to the rear leading to the garage with



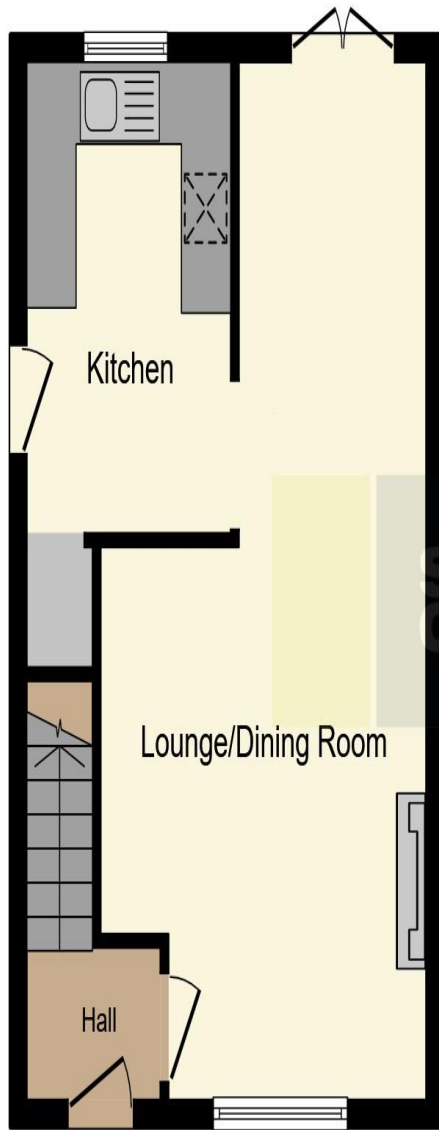

Ground Floor

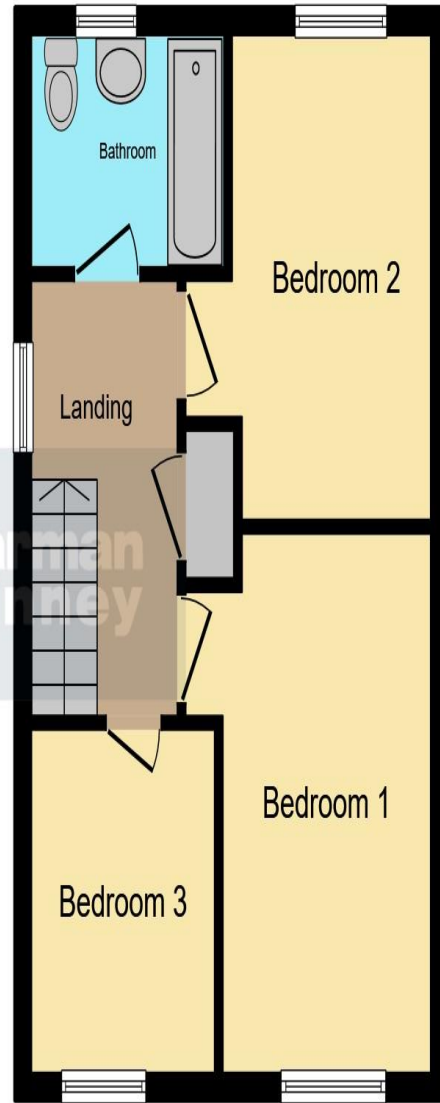

First Floor

personal door. To the front the garden is lawned with a mature hedge border.

This floor plan is for illustrative purposes only. It is not drawn to scale. Any measurements, floor areas (including any total floor area), openings and orientation are approximate. No details are guaranteed, they cannot be relied upon for any purpose and they do not form part of any agreement. No liability is taken for any error, omission or misstatement. A party must rely upon its own inspection(s). Powered by www.focalagent.com

To view this property call Sharman Quinney on:
01778 343322

Selling your property?

Contact us to arrange a **FREE** home valuation.

 01778 343322

 25 Market Place, Market Deeping,
PETERBOROUGH, Cambridgeshire, PE6 8EA

 marketdeeping@sharmanquinney.co.uk

 www.sharmanquinney.co.uk



 SCAN ME



Sharman Quinney Holdings Limited is registered in England and Wales under company number 4174227, Registered Office is Cumbria House, 16-20 Hockliffe Street, Leighton Buzzard, Bedfordshire, LU7 1GN. VAT Registration Number is 500 2481 05.

1: These particulars do not constitute part or all of an offer or contract. 2: The measurements indicated are supplied for guidance only and as such must be considered incorrect. 3: Potential buyers are advised to recheck the measurements before committing to any expense. 4: Sharman Quinney has not tested any apparatus, equipment, fixtures, fittings or services and it is the buyers interests to check the working condition of any appliances. 5: Sharman Quinney has not sought to verify the legal title of the property and buyers must obtain verification from their legal representative. 6: Intending purchasers will be asked to produce identification documentation at a later stage and we would ask your co-operation in order that there will be no delay in agreeing the sale. Ref: MRD204016 - 0006

