



Towgood Close, Helpston, Peterborough
£370,000 Freehold

**Sharman
Quinney**

Key Features



- Detached Family Home
- Four Bedrooms
- Kitchen/Diner
- En Suite
- Garage and Driveway

Accommodation Includes

Entrance Hall

Stairs to first floor and landing, radiator, under stairs storage cupboard.

Cloakroom

Fitted with a two piece suite comprising pedestal wash hand basin and WC, radiator.

Kitchen Diner

6.50m x 3.54m (21'4" x 11'7"). Comprising a range of base and eye level units, worktops over, sink, electric oven, gas hob, extractor fan, space for fridge freezer, integrated dish washer, window to front and rear, radiator, door to rear.



Utility Room

Range of base and eye level units with worktops over, sink, boiler, window to rear, radiator.

Lounge

6.50m x 3.34m (21'4" x 10'11"). Radiators x 2
window to front, patio doors to rear garden.

Stairs to first floor and landing

Loft access, radiator, airing cupboard.

Bedroom 1

3.82m x 3.35m (12'6" x 11'). Window to front,
radiator, door to:

En-Suite

Comprising wc, shower cubicle, pedestal wash
hand basin, window to front.

Bedroom 2

3.00m x 3.37m (9'10" x 11'). Window to front,
radiator.

Bedroom 3

3.23m x 3.08m (10'7" x 10'1"). Window to rear,
radiator.

Bedroom 4

3.40m x 3.39m (11'2" x 11'1"). Window to rear,
radiator.



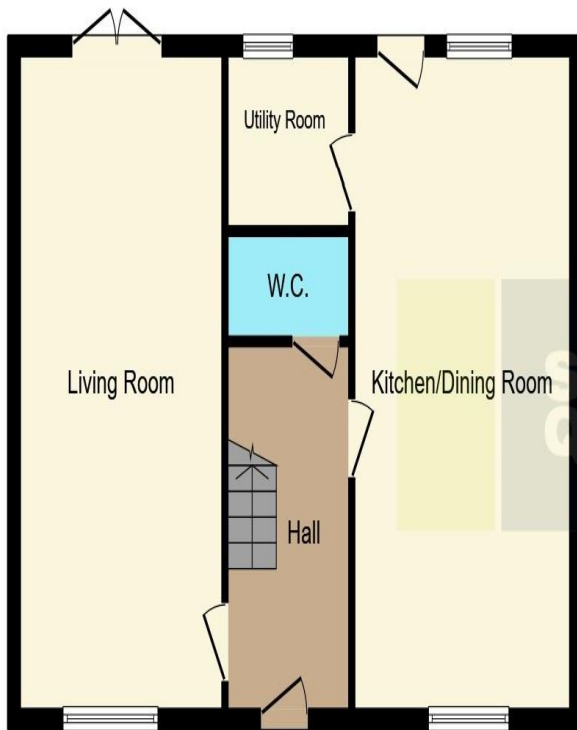

Ground Floor

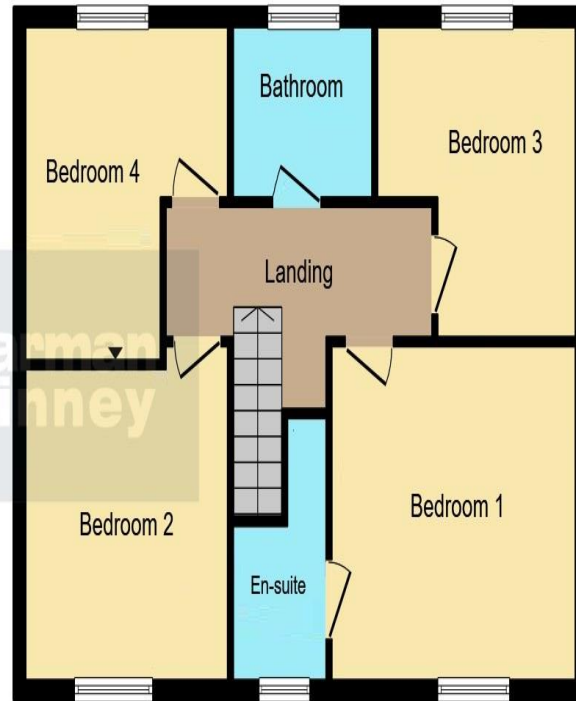

First Floor

Bathroom

Comprising of panel bath, shower with mixer taps, pedestal wash hand basin, wc, window to rear, radiator, towel rail.

Outside

To the rear the garden is laid to lawn with patio area, shrubs and plants, shed and enclosed with wood panel fencing and side gate access.

To the front there is a combination of plants, shrubs and flowers with a drive way to the side leading to a single garage with power and light and up and over door.

This floorplan is for illustrative purposes only and is not drawn to scale. Measurements, floor-areas, openings and orientations are approximate. They should not be relied upon for any purpose and do not form any part of an agreement. No liability is taken for any error or mis-statement. All parties must rely on their own inspections.

To view this property call Sharman Quinney on:
01778 343322

Selling your property?

Contact us to arrange a **FREE** home valuation.

 01778 343322

 25 Market Place, Market Deeping,
PETERBOROUGH, Cambridgeshire, PE6 8EA

 marketdeeping@sharmanquinney.co.uk

 www.sharmanquinney.co.uk



 SCAN ME



Sharman Quinney Holdings Limited is registered in England and Wales under company number 4174227, Registered Office is Cumbria House, 16-20 Hockliffe Street, Leighton Buzzard, Bedfordshire, LU7 1GN. VAT Registration Number is 500 2481 05.

1: These particulars do not constitute part or all of an offer or contract. 2: The measurements indicated are supplied for guidance only and as such must be considered incorrect. 3: Potential buyers are advised to recheck the measurements before committing to any expense. 4: Sharman Quinney has not tested any apparatus, equipment, fixtures, fittings or services and it is the buyers interests to check the working condition of any appliances. 5: Sharman Quinney has not sought to verify the legal title of the property and buyers must obtain verification from their legal representative. 6: Intending purchasers will be asked to produce identification documentation at a later stage and we would ask your co-operation in order that there will be no delay in agreeing the sale. Ref: MRD203806 - 0001

