



Smiths Drive, March  
**£190,000** **Freehold**

**Sharman  
Quinney**



# Key Features



- No Onward Chain!
- Fantastic First Time Buyer or Investment Opportunity!
- Generous Garden!
- Walking Distance to Town Centre and Local Schools!
- Three Double Bedrooms!

## Entrance Hall -

Tiled floor, under stair storage area, doors to all ground floor rooms and the stairs up to first floor.

## Lounge Diner - 6.5m x 3.5m (21'7" x 11'7")

Carpet flooring, window to front and rear, electric feature fireplace

## Kitchen/Breakfast Room - 3.5m x 2.3m (11'6" x 7'7")

Tiled flooring, window to rear, a range of wall and base cupboards, stainless steel sink, plumbing for washing machine, space for oven, breakfast bar area, door leading to garden.

## Ground Floor Cloakroom

Tiled flooring, window to front, low-level WC, wall mounted hand wash basin, heated towel rail.





Walk-in Storeroom / Cupboard - 1.3m x 1.1m (4'6" x 3'10")

Walk-in storage cupboard could be utilised as a small office space if needed.

Landing -

Carpet flooring, loft access, airing cupboard.

Bedroom One - 3.5m x 3.2m (11'8" x 10'9")

Carpet flooring, window to rear.

Bedroom Two - 3.5m x 3.3m (11'7" x 10'10")

Carpet flooring, window to front.

Bedroom Three - 3m x 2.3m (10'0" x 7'8")

Carpet flooring, window to front.

Bathroom

Tiled flooring and walls, window to rear, low level WC, pedestal sink, step up shower cubicle, radiator, built-in storage cupboard.

Outside

The front of the property is gravelled, and a paved pathway leads to the front door. The rear garden can be access via a gate to the rear and is gravelled for low maintenance and has a patio area off the rear of the house. There is also a timber constructed shed with light and power.



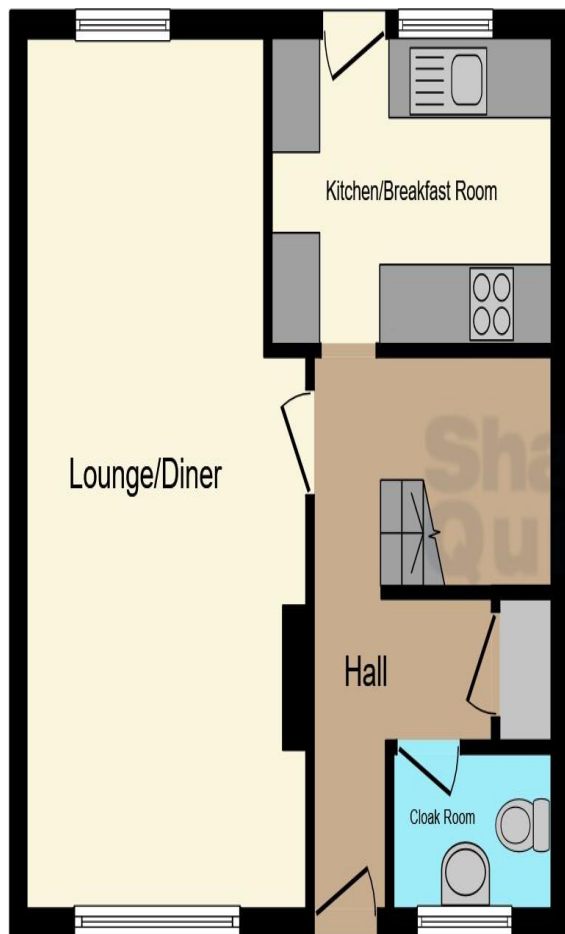

**Ground Floor**

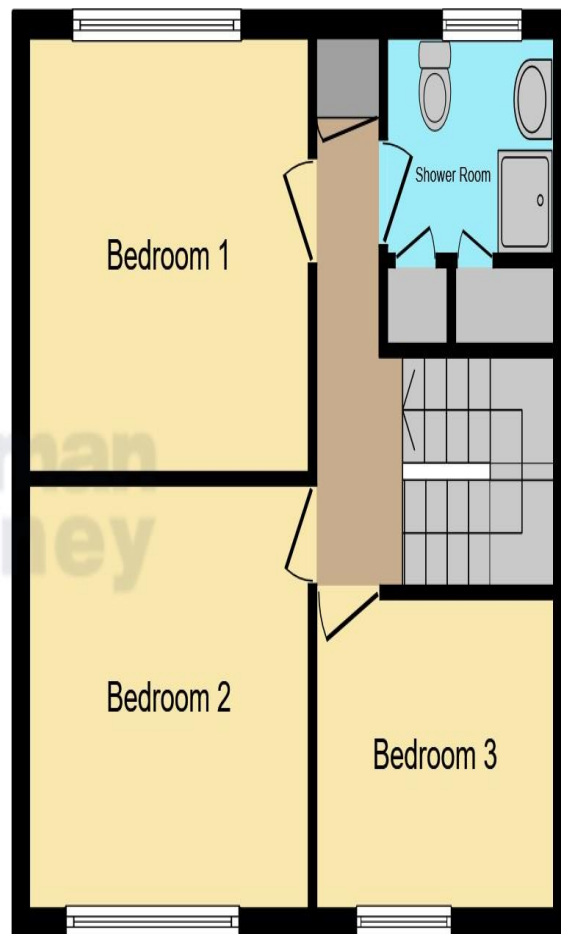

**First Floor**

This floor plan is for illustrative purposes only. It is not drawn to scale. Any measurements, floor areas (including any total floor area), openings and orientation are approximate. No details are guaranteed, they cannot be relied upon for any purpose and they do not form part of any agreement. No liability is taken for any error, omission or misstatement. A party must rely upon its own inspection(s). Powered by [www.focalagent.com](http://www.focalagent.com)

To view this property call Sharman Quinney on:  
**01354 661166**

# Selling your property?

Contact us to arrange a **FREE** home valuation.

 01354 661166

 8 Broad Street, MARCH, Cambridgeshire, PE15 8TG

 march@sharmanquinney.co.uk

 [www.sharmanquinney.co.uk](http://www.sharmanquinney.co.uk)



 SCAN ME



Sharman Quinney Holdings Limited is registered in England and Wales under company number 4174227, Registered Office is Cumbria House, 16-20 Hockliffe Street, Leighton Buzzard, Bedfordshire, LU7 1GN. VAT Registration Number is 500 2481 05.

1: These particulars do not constitute part or all of an offer or contract. 2: The measurements indicated are supplied for guidance only and as such must be considered incorrect. 3: Potential buyers are advised to recheck the measurements before committing to any expense. 4: Sharman Quinney has not tested any apparatus, equipment, fixtures, fittings or services and it is the buyers interests to check the working condition of any appliances. 5: Sharman Quinney has not sought to verify the legal title of the property and buyers must obtain verification from their legal representative. 6: Intending purchasers will be asked to produce identification documentation at a later stage and we would ask your co-operation in order that there will be no delay in agreeing the sale. Ref: MRC206650 - 0001

