



School Road, Upwell Wisbech
OIEO £425,000 Freehold

**Sharman
Quinney**

Key Features



- 41ft river mooring
- Multiple reception rooms
- Garage/Workshop PLUS Ample Off Road Parking
- Recently renovated throughout
- Downstairs bathroom PLUS upstairs shower room

Ground floor

Dining Room - 3.9m x 4.5m (12'7" x 14'7")

The main access into the house stepping down over the original stone step. Hard flooring, original fireplace with multi fuel burner. Window overlooking the front of the property with views of the river, all windows to front aspect have integrated blinds.

Kitchen - 3.8m x 2.4m (12'4" x 7'8")

Tiled flooring, new shaker style kitchen with a range of base and wall units plus full-length walk-in pantry, integrated fridge/freezer, slim line dishwasher, eye level double oven and microwave and gas range.

Study - 3m x 2.6m (9'8" x 8'5")

Hard flooring, small window into dining room.



Lounge - 4.2m x 4.1m (13'7" x 13'4")
Carpet flooring, French doors leading out to rear garden.

Bathroom - 2.2m x 2m (7'2" x 6'5")
Tiled flooring, 4 piece suite comprising of traditional style claw foot tub, free standing corner shower and integrated vanity unit with low rise wc and storage.

Utility Room - 6m 2.2m (19'6" x 7'2")
Tiled flooring, airing cupboard. A range of base and wall units with plumbing for washing machine, tumble dryer and additional space for dish washer and small fridge/freezer. Single door leading out to rear garden.

First floor

Bedroom One - 3.8m x 4.4m (12'4" x 14'4")
Carpet, vaulted style ceiling.

Bedroom Two - 3.5m x 3.5m (11'4" x 11'4")
Carpet, built in wardrobe and loft access.

Bedroom Three - 2.8m x 4.6m (9'1" x 15'0")
Carpet flooring.

Shower Room - 3m x 2.1m (9'8" x 6'8")
Tiled floor. Comprising of a 3-piece suite with free standing shower with rain head, vanity sink with storage and low rise w/c.





Ground Floor

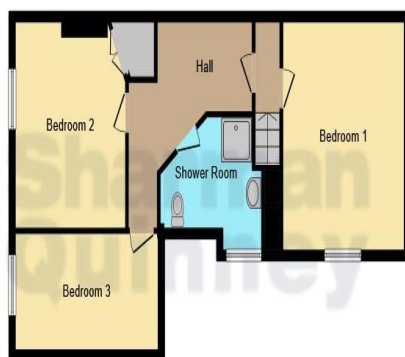

First Floor

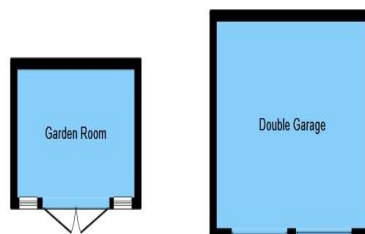

Outbuilding

This floor plan is for illustrative purposes only. It is not drawn to scale. Any measurements, floor areas (including any total floor area), openings and orientation are approximate. No details are guaranteed, they cannot be relied upon for any purpose and they do not form part of any agreement. No liability is taken for any error, omission or misstatement. A party must rely upon its own inspection(s). Powered by www.focalagent.com

Outside -
Garage/Workshop - Left 4.9m x 3.1m (16'0" x 10'1") Right 4.9m x 5.1m (16'0" x 16'7")
Accessed via two garage doors.

Garden Room - 3.8m x 2.4m (12'4" x 7'8")
Light and power with TV ariel.

The front of the property offers ample parking for multiple vehicles. Mostly laid to lawn with various shrubs. It is hedged up to the road for privacy and has steps leading down to the private mooring. Please note, the mooring access steps are shared with the neighbour so there is no divide between the front gardens. The rear garden is mostly laid to lawn with a small patio area and decking area.

To view this property call Sharman Quinney on:
01354 661166

Selling your property?

Contact us to arrange a **FREE** home valuation.

 01354 661166

 8 Broad Street, MARCH, Cambridgeshire, PE15 8TG

 march@sharmanquinney.co.uk

 www.sharmanquinney.co.uk



 SCAN ME



Sharman Quinney Holdings Limited is registered in England and Wales under company number 4174227, Registered Office is Cumbria House, 16-20 Hockliffe Street, Leighton Buzzard, Bedfordshire, LU7 1GN. VAT Registration Number is 500 2481 05.

1: These particulars do not constitute part or all of an offer or contract. 2: The measurements indicated are supplied for guidance only and as such must be considered incorrect. 3: Potential buyers are advised to recheck the measurements before committing to any expense. 4: Sharman Quinney has not tested any apparatus, equipment, fixtures, fittings or services and it is the buyers interests to check the working condition of any appliances. 5: Sharman Quinney has not sought to verify the legal title of the property and buyers must obtain verification from their legal representative. 6: Intending purchasers will be asked to produce identification documentation at a later stage and we would ask your co-operation in order that there will be no delay in agreeing the sale. Ref: MRC206075 - 0004

