



Fillenham Way, Chatteris
£320,000 Freehold

**Sharman
Quinney**

Key Features



- Detached house
- 3 double bedrooms
- En-suite to master
- Beautifully presented throughout
- Landscaped garden

Entrance hall with understairs cupboard leading to:

Lounge - 3.91m x 3.54m (12'8" x 11'6") Built in media wall fitted with electric fireplace, space for television, fitted with spotlights and two built in storage cupboards. Double glazed window to front of property, radiator.

Kitchen/Diner - 5.50m x 2.83m (18'0" x 9'2") Fitted with a matching base and eye level units with quartz worktop. Integrated fridge/freezer, dishwasher, built-in double oven, built-in induction hob with extractor hood over. Doubled glazed windows overlooking rear garden with double glazed patio doors leading to the garden, radiator.

Utility - 1.83m x 1.74m (6'0" x 5'7") Base level



units with worktop space, plumbing for washing machine, potential space for tumble dryer, window to side, radiator.

WC - Fitted with two piece suite comprising, vanity wash hand basin and low-level WC, part tiled walls, radiator and LVT flooring.

Upstairs landing with two cupboards leading to:

Bedroom 1 3.24m x 3.92m (10'6" x 12'8") Built-in triple wardrobe with sliding doors, window to front, radiator

En-suite - Fitted with three piece suite, wash hand basin, shower cubicle and low-level WC, window to front, heated towel rail

Bedroom 2 - 2.90m x 2.82m (9'5" x 9'2") - Fitted double wardrobes, window to rear, radiator

Bedroom 3 - 2.91m x 2.59m (9'5" x 8'4") Window to rear, radiator

Bathroom - Fitted with three piece suite, panelled bath with shower head over, hand basin and low-level WC, window to side, heated towel rail

Outside - To the front of the property there is lawn with planted shrubs, to the side a driveway with gate into the garden. To the rear a boarder from the lawn with shrubs, patio area which is



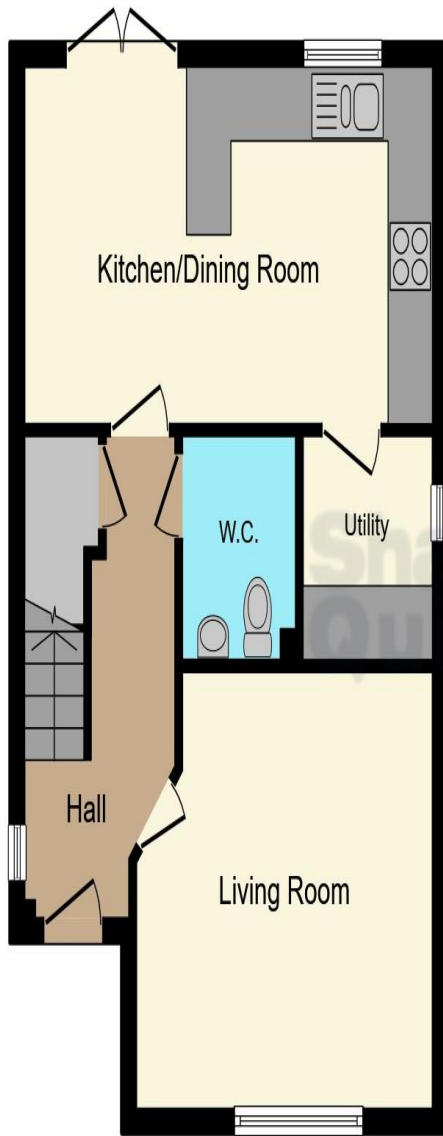

Ground Floor



First Floor

blocked paved with Indian sand stone slabs and a shed with lighting and power.

This floor plan is for illustrative purposes only. It is not drawn to scale. Any measurements, floor areas (including any total floor area), openings and orientation are approximate. No details are guaranteed, they cannot be relied upon for any purpose and they do not form part of any agreement. No liability is taken for any error, omission or misstatement. A party must rely upon its own inspection(s). Powered by www.focalagent.com

To view this property call Sharman Quinney on:
01354 661166

Selling your property?

Contact us to arrange a **FREE** home valuation.

 01354 661166

 8 Broad Street, MARCH, Cambridgeshire, PE15 8TG

 march@sharmanquinney.co.uk

 www.sharmanquinney.co.uk



 SCAN ME



Sharman Quinney Holdings Limited is registered in England and Wales under company number 4174227, Registered Office is Cumbria House, 16-20 Hockliffe Street, Leighton Buzzard, Bedfordshire, LU7 1GN. VAT Registration Number is 500 2481 05.

1: These particulars do not constitute part or all of an offer or contract. 2: The measurements indicated are supplied for guidance only and as such must be considered incorrect. 3: Potential buyers are advised to recheck the measurements before committing to any expense. 4: Sharman Quinney has not tested any apparatus, equipment, fixtures, fittings or services and it is the buyers interests to check the working condition of any appliances. 5: Sharman Quinney has not sought to verify the legal title of the property and buyers must obtain verification from their legal representative. 6: Intending purchasers will be asked to produce identification documentation at a later stage and we would ask your co-operation in order that there will be no delay in agreeing the sale. Ref: MRC206147 - 0003

