



School House March Road, Coldham Wisbech  
**OIEO £300,000 Freehold**

**Sharman  
Quinney**

# Key Features



- Beautifully Presented Throughout
- Open Plan Kitchen/Diner
- Field Views
- Large, Private Garden
- Ample Off Road Parking PLUS Garage

## Entrance Hall

Kardean flooring, door to lounge and kitchen/diner, stairs to first floor.

## Kitchen Diner 6m x 3.3m (19'08" x 11'10")

A range of base and wall units, wood flooring, integrated dish washer, porcelain butler sink, free standing oven with gas hob, chrome overhead extractor fan, under stairs pantry with internal window, windows to front and rear aspect, door to rear garden, spot lights plus feature lighting over island

## Lounge 3.3m x 3.3m (11'11" x 11'11")

Fitted carpet, gas fire and fireplace with wood effect mantel, window to front aspect and french doors to playroom



Playroom/Study 2.4m x 2m (8'00" x 6'07")  
Fitted carpet, door to rear garden, storage cupboard, spotlights, window to side aspect, door to downstairs cloakroom and radiator.

Landing  
Fitted carpet, window to rear aspect, airing cupboard, doors leading to three bedrooms and bathroom.

Bedroom One 3.6m x 3.6m (12'00" x 12'00")  
Fitted carpet, window to front and side aspect

Bedroom Two 3.6m x 3.4m (12'00" x 11'02")  
Wood flooring, window to front and side aspect

Bedroom Three 3.6m x 1.8m (12'00" x 6'11")  
Fitted carpet, window to rear aspect

Bathroom  
Laminate flooring, panel bath with electric shower overhead, low level w/c, vanity sink, exposed beams, extractor fan and chrome heated towel rail.

Outside  
To the front, open field views a paved driveway with parking for several cars, double gate leading to further parking and garage via gravelled driveway  
The rear garden is mostly laid to lawn. Large patio area perfect for entertaining.





**Ground Floor**

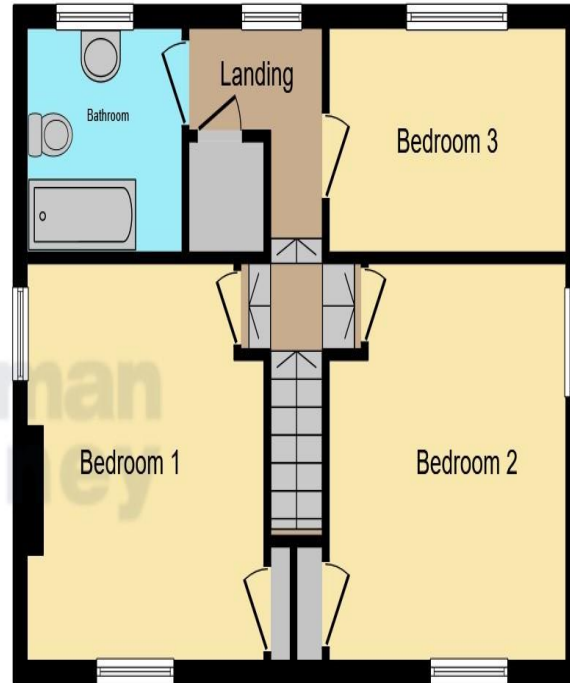

**First Floor**

This floor plan is for illustrative purposes only. It is not drawn to scale. Any measurements, floor areas (including any total floor area), openings and orientation are approximate. No details are guaranteed, they cannot be relied upon for any purpose and they do not form part of any agreement. No liability is taken for any error, omission or misstatement. A party must rely upon its own inspection(s). Powered by [www.focalagent.com](http://www.focalagent.com)

To view this property call Sharman Quinney on:  
**01354 661166**

# Selling your property?

Contact us to arrange a **FREE** home valuation.

 01354 661166

 8 Broad Street, MARCH, Cambridgeshire, PE15 8TG

 [march@sharmanquinney.co.uk](mailto:march@sharmanquinney.co.uk)

 [www.sharmanquinney.co.uk](http://www.sharmanquinney.co.uk)



 SCAN ME



Sharman Quinney Holdings Limited is registered in England and Wales under company number 4174227, Registered Office is Cumbria House, 16-20 Hockliffe Street, Leighton Buzzard, Bedfordshire, LU7 1GN. VAT Registration Number is 500 2481 05.

1: These particulars do not constitute part or all of an offer or contract. 2: The measurements indicated are supplied for guidance only and as such must be considered incorrect. 3: Potential buyers are advised to recheck the measurements before committing to any expense. 4: Sharman Quinney has not tested any apparatus, equipment, fixtures, fittings or services and it is the buyers interests to check the working condition of any appliances. 5: Sharman Quinney has not sought to verify the legal title of the property and buyers must obtain verification from their legal representative. 6: Intending purchasers will be asked to produce identification documentation at a later stage and we would ask your co-operation in order that there will be no delay in agreeing the sale. Ref: MRC205741 - 0005

