

Hall Close, LE15 8PE
Empingham
Oakham
£395,950

Hurfords



3



2



D



D

- 3 Bedroom Character Barn Conversion
- Sought After Village of Empingham
- Large Courtyard Garden
- Allocated Parking
- Large Single Garage & Workshop
- Quiet Location
- Oil Fired Central Heating

2 Hall Close Empingham Oakham LE15 8PE

'The sale of this Property is subject to Grant of Probate. Please seek an update from the Branch with regards to the potential timeframes involved.'

Sympathetically converted in to a home this former barn boasts 3 bedrooms on the first floor offering 2 double rooms as well as a single. The master bedroom features plenty of fitted storage to maximise space and boasts exposed timber beams to show off the history of the home. All 3 bedrooms share the family bathroom comprising of a D-shaped bath with floor to ceiling tiles, W/C, basin & heated towel rail. In addition on this floor is an airing cupboard.

To the ground floor there is a kitchen offering a range of base and wall units with an electric hob and a double Neff oven with views to the rear garden. Just off the kitchen is a dining room, an ideal spot for when entertaining. To the right of the property is the lounge, a generous space spanning the depth of the home with double doors opening up to the garden. Set in to the fire surround is a wood burning stove for those cooler evenings in. Additionally to the left of the home is a downstairs W/C as well as further storage.

Externally to the rear is an enclosed low maintenance courtyard garden with a range of shrubs and paving for outdoor dining and drinking. To the rear of the development there is an allocated parking space as well as a generous garage with plenty of space for vehicles as well as additional storage.

Empingham is a sought after village a short distance from Stamford and Oakham with the benefit of a village shop, pub and doctors surgery, rare in villages in this area. Viewing of this home is essential to realise its potential!



Hurfords

"DoubleClick Insert Picture"

"DoubleClick Insert Picture"

2 Hall Close, Empingham, Oakham
 Approximate Gross Internal Area
 Main House = 78 Sq M/840 Sq Ft
 Garage = 21 Sq M/226 Sq Ft
 Total = 99 Sq M/1066 Sq Ft

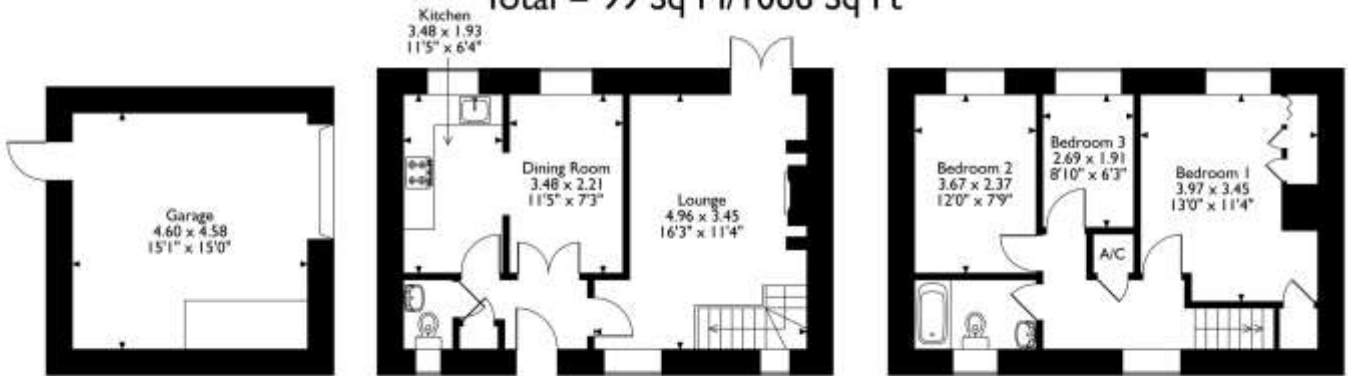

Ground Floor

First Floor

Please note that the location of doors, windows and other items are approximate and this floorplan is to be used for illustrative purposes only. Unauthorized reproduction is prohibited.



Rooms/Measurements

Lounge 16'3" x 11'4"
 Dining Room 11'5" x 7'3"
 Kitchen 11'5" x 6'4"
 Bedroom One 13'0" x 11'4"
 Bedroom Two 12'0" x 7'9"
 Bedroom Three 8'10" x 6'3"
 Garage 15'1" x 15'0"

TENURE: FREEHOLD



Hurfords



SCAN ME

Selling your property?
Contact us to arrange a FREE home valuation.

01780 752136

38 St. Mary's Street, Stamford, Lincolnshire, PE9 2DS

stamford@hurford.co.uk

www.hurfords.co.uk

Hurfords is a trading name of Sharman Quinney Holdings Limited which is registered in England and Wales under company number 4174227, Registered Office is Cumbria House, 16-20 Hockliffe Street, Leighton Buzzard, Bedfordshire, LU7 1GN. VAT Registration Number is 500 2481 05. 1: These particulars do not constitute part or all of an offer or contract. 2: The measurements indicated are supplied for guidance only and as such must be considered incorrect. 3: Potential buyers are advised to recheck the measurements before committing to any expense. 4: Hurfords has not tested any apparatus, equipment, fixtures, fittings or services and it is the buyer's interests to check the working condition of any appliances. 5: Hurfords has not sought to verify the legal title of the property and buyers must obtain verification from their legal representative. 6: Intending purchasers will be asked to produce identification documentation at a later stage and we would ask your co-operation in order that there will be no delay in agreeing the sale. Ref: SFD203836-PDAF 0003

