



Hardwick Court, Holme Peterborough
£374,995 **Freehold**

**Sharman
Quinney**

Key Features



- Modern Semi-Detached Family Home
- Village and Cul-de-Sac Location
- Four Bedrooms + En-Suite Shower Room
- L/Shaped Kitchen/Diner
- Study/Snug & Lounge

Spacious Immaculate modern Semi-Detached House in the Very popular Village of Holme in a Cul-De-Sac on a corner plot, this must be viewed family home in brief the accommodation comprises of Entrance Hall with built-in storage cupboard and stairs to the first floor landing, doors giving access to the Two Piece Downstairs Cloakroom, the well lit Lounge, double doors to the Study/Snug, the L/shaped Kitchen/Diner is perfect for entertaining and the kitchen area is fitted with a range of base and eye level units, cupboards and drawers, worktop space, one and a quarter single drainer sink unit, benefits from having built-in appliances including oven, hob, dishwasher, fridge and freezer, from the dining area there is French doors opening out to the low maintenance rear garden. Up Stairs Gallery landing has doors to the Four Bedrooms, off Bedroom 1 a door to the Three



Piece En-Suite Shower Room comprising of a walk-in shower cubicle, wash hand basin with storage under, low level wc, Family Bathroom is fitted with a Three Piece Suite comprising of a panelled bath with a shower attachment, pedestal wash hand basin and a low level wc, Outside is all well maintained, frontage is open plan, the driveway provides Off Road Parking, gated access to the low maintenance garden which has paved patio seating area, various plants and shrubs, garden shed with power connected.

Reception Hall:

Downstairs Cloakroom - 5'5"max x 3'5"max
(1.65m x 1.06m)

Lounge - 13.8max x 11'9"max (4.17m x 3.58m)

Study/Snug - 9'6" x 9' (2.90m x 2.74m)

L/Shaped Kitchen/Diner - 20'4"max 12'2"max
(6.20m x 3.71m)

Dining Area - 12'2" x 10'3" (3.71m x 3.12m)

Kitchen Area - 10'1"max x 8'1"max (3.07m x 2.46m)

First Floor Gallery - 6'8" x 6'3" (2.03m x 1.91m)
excluding stairs.

Bedroom 1 - 11'5" 10'3" (3.48m x 3.10m)



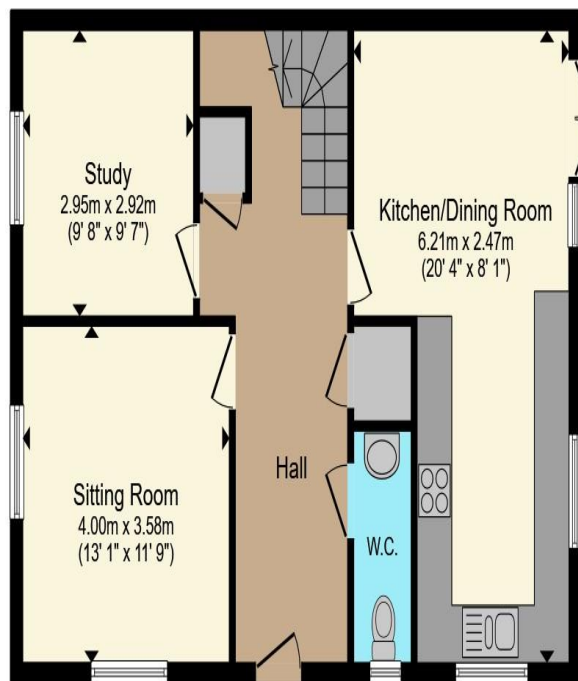

Ground Floor

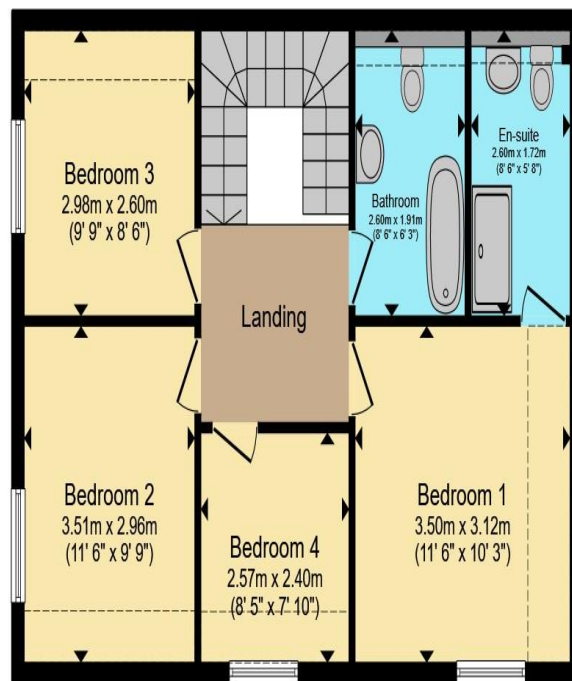

First Floor

Total floor area 124.6 m² (1,341 sq.ft.) approx

This floor plan is for illustrative purposes only. It is not drawn to scale. Any measurements, floor areas (including any total floor area), openings and orientation are approximate. No details are guaranteed, they cannot be relied upon for any purpose and they do not form part of any agreement. No liability is taken for any error, omission or misstatement. A party must rely upon its own inspection(s). Powered by www.propertybox.io

**Sharman
Quinney**

excluding door recess.

En-Suite Shower Room - 7'6"max 5'6"max (2.29m x 1.68m)

Bedroom 2 - 11'5" x 9'8" (3.48m x 2.95m)

Bedroom 3 - 9'8"max x 8'6"max (2.95m x 2.59m)

Bedroom 4 - 8'4" x 7'9" (2.54m x 2.36m)

Family Bathroom - 7'7"max x 6'2"max (2.31m x 1.83m)

To view this property call Sharman Quinney on:
01733 245400

Selling your property?

Contact us to arrange a **FREE** home valuation.

 01733 245400

 Unit 19 Maltings Square, Broadway Shopping Centre, Yaxley, Cambridgeshire, PE7 3EW

 yaxley@sharmanquinney.co.uk

 www.sharmanquinney.co.uk



 SCAN ME



Sharman Quinney Holdings Limited is registered in England and Wales under company number 4174227, Registered Office is Cumbria House, 16-20 Hockliffe Street, Leighton Buzzard, Bedfordshire, LU7 1GN. VAT Registration Number is 500 2481 05.

1: These particulars do not constitute part or all of an offer or contract. 2: The measurements indicated are supplied for guidance only and as such must be considered incorrect. 3: Potential buyers are advised to recheck the measurements before committing to any expense. 4: Sharman Quinney has not tested any apparatus, equipment, fixtures, fittings or services and it is the buyers interests to check the working condition of any appliances. 5: Sharman Quinney has not sought to verify the legal title of the property and buyers must obtain verification from their legal representative. 6: Intending purchasers will be asked to produce identification documentation at a later stage and we would ask your co-operation in order that there will be no delay in agreeing the sale. Ref: YAX203897 - 0001

