



Church Close, Stilton Peterborough
£380,000 Freehold

**Sharman
Quinney**

Key Features



- Detached Family Home
- Village Location + No-Upward Chain
- Four Bedrooms + Shower Room
- Two Reception Rooms
- Fitted Kitchen + Utility Room

Located in the popular Village of Stilton, in easy access to the A1 and to local shops, this Spacious Detached Family Home is being SOLD with No-Upward Chain and in brief the accommodation comprises of Entrance Hall which has doors giving access to, Downstairs Cloakroom, Lounge, Lounge with an opening to the Dining Area, door to the Rear Lobby with stairs to the first floor landing, doors to the UPVC double glazed Conservatory with a sliding door to the rear garden. Kitchen has a range of base and eye level units, cupboards and drawers, worktop space with a one and quarter single drainer sink unit, space for a fridge/freezer, built-in electric hob and double oven, Utility Room which has some eye level units, worktop space, plumbing for a washing machine, space for a tumble dryer. Upstairs First Floor landing has doors to the Four nice size Bedrooms and to the



three piece Shower Room which includes a walk-in shower cubicle with a hand shower attachment, wash hand basin with storage cupboard under, close couple wc, Outside frontage is open plan, driveway provides off road parking for a number of cars and leads to the 22'9" long Garage with an electric operated roller door, with light and power connected, courtesy door to the Enclosed Rear Garden which is laid mainly to lawn with a blocked paved patio seating area.

Entrance Hall - 5'7" x 5'7"

Downstairs Cloakroom - 5'7"max x 3'9"max

Lounge - 16'3" x 10'9"

Dining Area - 10'10" x 8'8"

Fitted Kitchen - 14'6" x 8'6"

Utility Room - 6'1" x 5'8"

Rear Lobby:

Conservatory - 12'2" x 8'4"

First Floor Landing:

Bedroom 1 - 13'2"max x 10'9"max (including double wardrobe)

Bedroom 2 - 13'9"max x 9'max





Ground Floor

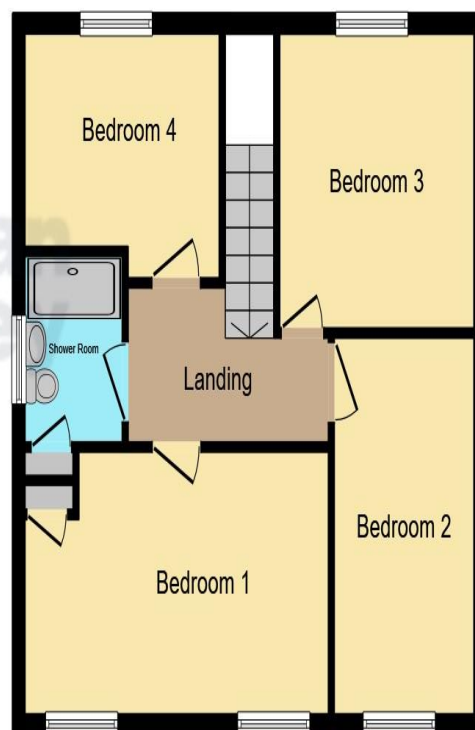

First Floor

Bedroom 3 - 11'9"max x 8'9"max

Bedroom 4 - 8'8" x 7'9" (excluding door recess)

Shower Room - 7'8"max x 4'9"max (including shower cubicle)

Garage - 22'9"max x 8'8"max

This floor plan is for illustrative purposes only. It is not drawn to scale. Any measurements, floor areas (including any total floor area), openings and orientation are approximate. No details are guaranteed, they cannot be relied upon for any purpose and they do not form part of any agreement. No liability is taken for any error, omission or misstatement. A party must rely upon its own inspection(s). Powered by www.focalagent.com

To view this property call Sharman Quinney on:
01733 245400

Selling your property?

Contact us to arrange a **FREE** home valuation.

 01733 245400

 Unit 19 Maltings Square, Broadway Shopping Centre, Yaxley, PE7 3EW

 yaxley@sharmanquinney.co.uk

 www.sharmanquinney.co.uk



 SCAN ME



Sharman Quinney Holdings Limited is registered in England and Wales under company number 4174227, Registered Office is Cumbria House, 16-20 Hockliffe Street, Leighton Buzzard, Bedfordshire, LU7 1GN. VAT Registration Number is 500 2481 05.

1: These particulars do not constitute part or all of an offer or contract. 2: The measurements indicated are supplied for guidance only and as such must be considered incorrect. 3: Potential buyers are advised to recheck the measurements before committing to any expense. 4: Sharman Quinney has not tested any apparatus, equipment, fixtures, fittings or services and it is the buyers interests to check the working condition of any appliances. 5: Sharman Quinney has not sought to verify the legal title of the property and buyers must obtain verification from their legal representative. 6: Intending purchasers will be asked to produce identification documentation at a later stage and we would ask your co-operation in order that there will be no delay in agreeing the sale. Ref: YAX203798 - 0004

