



Swallowfield, Peterborough
£250,000 Freehold

**Sharman
Quinney**

Key Features



- Three Bedrooms
- Dining Area
- Enclosed Garden
- Garage
- No Upward Chain

GROUND FLOOR

LEAN TO

ENTRANCE HALL: UPVC Double glazed entrance door. Built in cupboard. Stairs to first floor.

LOUNGE: 5.20m x 3.06m (17'08" x 10'04" plus recess) UPVC Double glazed window and French doors. Tower radiator.

DINING AREA: 2.75m x 2.46m (9'05" x 8'09") UPVC Double glazed window. Radiator. Opening to;

KITCHEN: 2.46m x 2.74m (8'08" x 9'01") UPVC Double glazed window. Fitted with a range of base and wall units. Stainless steel sink and



drainer with mixer tap. Fitted hob. Wall mounted boiler.

FIRST FLOOR

LANDING: UPVC Double glazed window. Radiator.

BEDROOM: 2.77m x 3.37m (9'10" plus recess x 11'07" max) UPVC Double glazed window. Radiator. Loft access. Built in cupboard.

BEDROOM: 3.07m x 3.07m (10'08" plus recess x 10'09" max) UPVC Double glazed window. Radiator.

BEDROOM: 2.13m x 2.15m (7'02" x 7'08") UPVC Double glazed window. Radiator.

BATHROOM: UPVC Frosted double glazed window. Low level WC. Wash hand basin with mixer tap. Bath with mixer tap and shower attachment. Heated towel rail.

OUTSIDE

FRONT: Parking.

GARAGE: Up and over door. Personal door to side.

GARDEN: Enclosed by fencing. Gate. Courtyard area. Main garden laid to lawn with shrub borders. Patio area.





Ground Floor

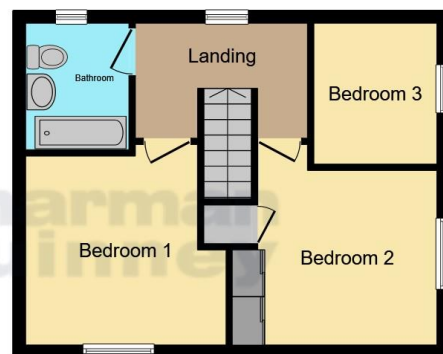

First Floor

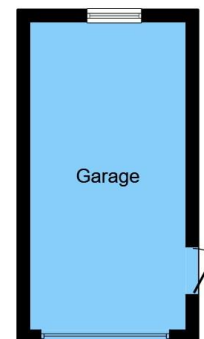

Garage

This floor plan is for illustrative purposes only. It is not drawn to scale. Any measurements, floor areas (including any total floor area), openings and orientation are approximate. No details are guaranteed, they cannot be relied upon for any purpose and they do not form part of any agreement. No liability is taken for any error, omission or misstatement. A party must rely upon its own inspection(s). Powered by www.focalagent.com

To view this property call Sharman Quinney on:
01733 575757

Selling your property?

Contact us to arrange a **FREE** home valuation.

 01733 575757

 Loxley Centre, Werrington, Peterborough,
Cambridgeshire, PE4 5BW

 werrington@sharmanquinney.co.uk

 www.sharmanquinney.co.uk



 SCAN ME



Sharman Quinney Holdings Limited is registered in England and Wales under company number 4174227, Registered Office is Cumbria House, 16-20 Hockliffe Street, Leighton Buzzard, Bedfordshire, LU7 1GN. VAT Registration Number is 500 2481 05.

1: These particulars do not constitute part or all of an offer or contract. 2: The measurements indicated are supplied for guidance only and as such must be considered incorrect. 3: Potential buyers are advised to recheck the measurements before committing to any expense. 4: Sharman Quinney has not tested any apparatus, equipment, fixtures, fittings or services and it is the buyers interests to check the working condition of any appliances. 5: Sharman Quinney has not sought to verify the legal title of the property and buyers must obtain verification from their legal representative. 6: Intending purchasers will be asked to produce identification documentation at a later stage and we would ask your co-operation in order that there will be no delay in agreeing the sale. Ref: WER205506 - 0001

