



Elm Crescent, Ginton Peterborough
£300,000 Freehold

**Sharman
Quinney**

Key Features



- Garage
- Extended Family Home
- Three Bedrooms
- Off Road Parking
- Enclosed Rear Garden
- Study

Ground Floor

PVCu double part glazed entrance door to:

Entrance Hall
Radiator, stairs, doors to:

Study
2.43m x 2.64m (8' x 8'8")

Lounge
3.68m x 5.10m (12'1" x 16'9")

Dining Room
2.74m x 3.04m (9' x 10')

Kitchen
4.92m x 2.84m (16'2" x 9'4")



First Floor

Landing
Doors to:

Bedroom 1
3.68m x 3.78m (12'1" x 12'5")

Bedroom 2
3.47m x 3.30m (11'5" x 10'10")

Bedroom 3
2.26m x 2.38m (7'5" x 7'10")

Bathroom
Fitted with three piece suite.

Outside
To the front there is a driveway and garage. The enclosed rear garden is mainly laid to lawn.



GROUND FLOOR

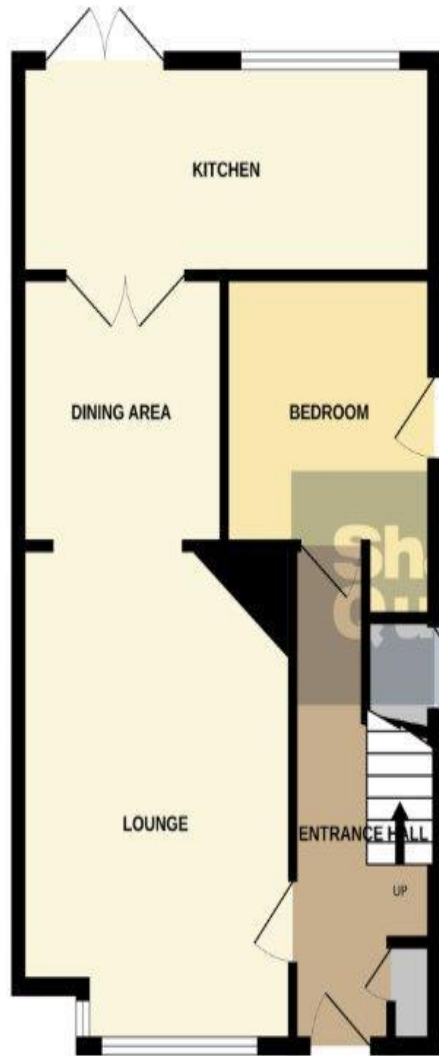

1ST FLOOR

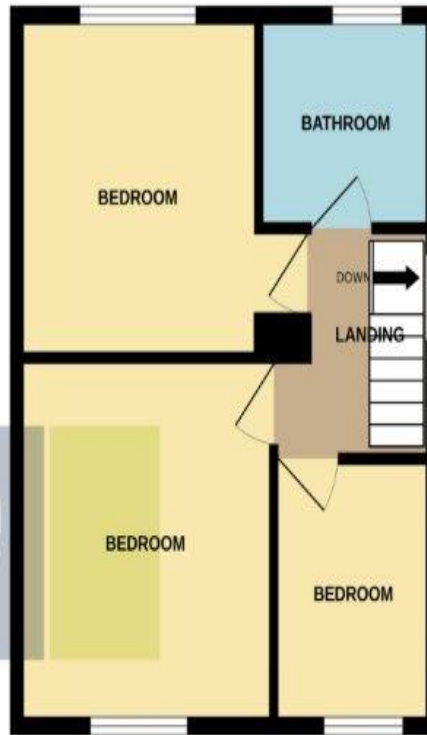

Whilst every attempt has been made to ensure the accuracy of the floorplan contained here, measurements of doors, windows, rooms and any other items are approximate and no responsibility is taken for any error, omission or mis-statement. This plan is for illustrative purposes only and should be used as such by any prospective purchaser. The services, systems and appliances shown have not been tested and no guarantee as to their operability or efficiency can be given.
Made with Metropix ©2024

To view this property call Sharman Quinney on:
01733 575757

Selling your property?

Contact us to arrange a **FREE** home valuation.

 01733 575757

 Loxley Centre, Werrington, Peterborough, Cambridgeshire, PE4 5BW

 werrington@sharmanquinney.co.uk

 www.sharmanquinney.co.uk



 SCAN ME



Sharman Quinney Holdings Limited is registered in England and Wales under company number 4174227, Registered Office is Cumbria House, 16-20 Hockliffe Street, Leighton Buzzard, Bedfordshire, LU7 1GN. VAT Registration Number is 500 2481 05.

1: These particulars do not constitute part or all of an offer or contract. 2: The measurements indicated are supplied for guidance only and as such must be considered incorrect. 3: Potential buyers are advised to recheck the measurements before committing to any expense. 4: Sharman Quinney has not tested any apparatus, equipment, fixtures, fittings or services and it is the buyers interests to check the working condition of any appliances. 5: Sharman Quinney has not sought to verify the legal title of the property and buyers must obtain verification from their legal representative. 6: Intending purchasers will be asked to produce identification documentation at a later stage and we would ask your co-operation in order that there will be no delay in agreeing the sale. Ref: WER205269 - 0005

