



Home Pasture, Werrington Peterborough
Guide Price **£190,000** **Freehold**

**Sharman
Quinney**

Key Features



- Detached Bungalow
- One Double Bedroom
- Light & Airy Open Plan Lounge Kitchen
- Corner Plot
- Off Road Parking
- Quality Shower Room

Entrance Hall

Part glazed UPVC door to entrance hall, radiator, and airing cupboard housing a gas combination boiler. Doors to:

Open Plan Lounge/Kitchen

Lounge Area 4.1m x 3.6m (13'4" x 11'8")
UPVC double glazed French doors to the garden, double radiator, TV point, door to the bedroom, and open plan into:



Kitchen Area 3.0 m x 2.5m (9'8" x 8'2")
Refitted to offer a stainless-steel circular sink unit and drainer with mixer taps over, range of fitted drawer and base units, free-standing cooker, stainless steel extractor hood, recess and plumbing for a washing machine and fridge, UPVC double glazed window to the front. Integrated wine rack, and a ceramic tiled flooring.

Bedroom 1 4.1m x 2.6m (13'5" x 8'5")
UPVC double glazed window to the rear, extensive range of free-standing wardrobes, matching chest of drawers and bedside cabinets. Loft access, and a radiator. (Bedroom furniture available by separate negotiation)

Shower Room
Refitted to offer a three-piece suite with a quadrant corner shower cubicle with a mains plumbed in shower and tiled surround. A vanity wash hand basin with mixer tap over and fitted storage cupboards under, boxed in low level WC, fully tiled walls and flooring, wall hung radiator, heated towel rack, extractor fan and a UPVC double glazed window to the front.



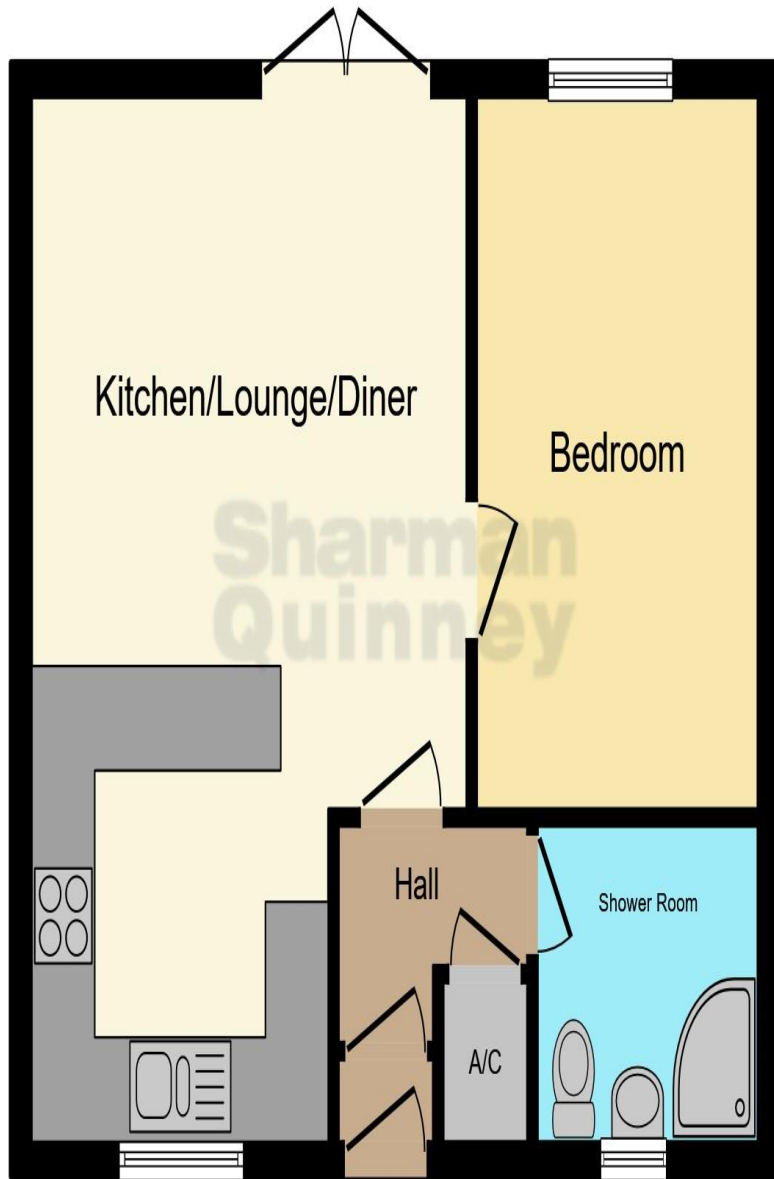

Outside

Front

An open plan frontage with off road parking.

Rear

Fully enclosed garden offering a high degree of privacy. Central lawn with patio area and established borders. A range of soft fruit trees. Timber shed. Summer House 3.04m x 1.83m (10'0" x 6'0").

This floor plan is for illustrative purposes only. It is not drawn to scale. Any measurements, floor areas (including any total floor area), openings and orientation are approximate. No details are guaranteed, they cannot be relied upon for any purpose and they do not form part of any agreement. No liability is taken for any error, omission or misstatement. A party must rely upon its own inspection(s). Powered by www.focalagent.com

To view this property call Sharman Quinney on:
01733 575757

Selling your property?

Contact us to arrange a **FREE** home valuation.

 01733 575757

 Loxley Centre, Werrington, Peterborough, Cambridgeshire, PE4 5BW

 werrington@sharmanquinney.co.uk

 www.sharmanquinney.co.uk



 SCAN ME



Sharman Quinney Holdings Limited is registered in England and Wales under company number 4174227, Registered Office is Cumbria House, 16-20 Hockliffe Street, Leighton Buzzard, Bedfordshire, LU7 1GN. VAT Registration Number is 500 2481 05.

1: These particulars do not constitute part or all of an offer or contract. 2: The measurements indicated are supplied for guidance only and as such must be considered incorrect. 3: Potential buyers are advised to recheck the measurements before committing to any expense. 4: Sharman Quinney has not tested any apparatus, equipment, fixtures, fittings or services and it is the buyers interests to check the working condition of any appliances. 5: Sharman Quinney has not sought to verify the legal title of the property and buyers must obtain verification from their legal representative. 6: Intending purchasers will be asked to produce identification documentation at a later stage and we would ask your co-operation in order that there will be no delay in agreeing the sale. Ref: WER205213 - 0002

