



Waterloo Road, Peterborough  
**£350,000** **Freehold**

**Sharman  
Quinney**



# Key Features



- Three Bedrooms
- Two Reception Rooms
- Driveway with a Detached Garage
- Extended Kitchen Diner Overlooking Large Rear Garden
- Wood Burner in Reception Area

## Planning and Development Potential

The area of the garden is approximately 631.69 m<sup>2</sup>

This property is already ahead of the curve for buyers looking to extend or add value. Full Building Control approval has been secured for a full-width dormer loft conversion, a ground floor utility and WC, and a redesigned kitchen layout with improved flow. In addition, the generous garden provides scope for further development subject to planning permission, offering significant future potential. The complete drawings will be provided to the successful buyer, allowing work to begin quickly and efficiently.

## Location

Waterloo Road is a highly desirable address in Peterborough PE1, offering the perfect balance of





peace and convenience. Residents benefit from easy access to Peterborough City Centre and the mainline train station with fast links to London, a choice of well-regarded schools and nurseries including Little Stars Nursery (Ofsted Outstanding, just a few minutes' walk), shops, parks, and green spaces within walking distance, and excellent road and public transport connections for commuters. This makes the property equally attractive to families, professionals, and investors.

#### Entrance Hall

Lounge 17' 1" x 12' 6" ( 5.21m x 3.66m 6 )

Dining Area 20' 9" 5 x 10' 0" ( 6.32m 5 x 3.05m 0 )

Reception Room 17' 9" x 12' 8" 1 ( 5.18m 9 x 3.86m 1 )

Kitchen 8' 6" 9 x 7' 4" 3 ( 2.59m 9 x 2.24m 3 )

Bedroom 1 13' 1" 4 x 12' 3" ( 3.99m 4 x 3.66m 3 )

Bedroom 2 12' 1" 0 x 11' 6" 8 ( 3.68m 0 x 3.51m 8 )

Bedroom 3 8' 9" 0 x 7' 7" 2 ( 2.67m 0 x 2.31m 2 )

Bathroom  
3 Piece Suite



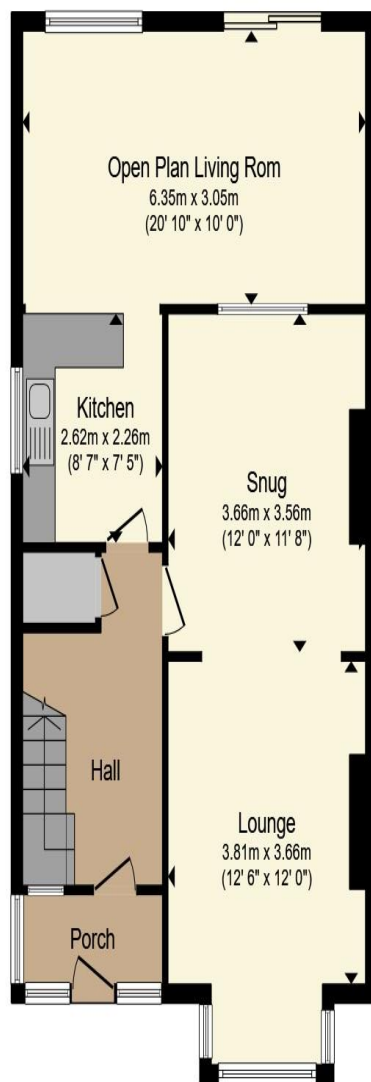

**Ground Floor**

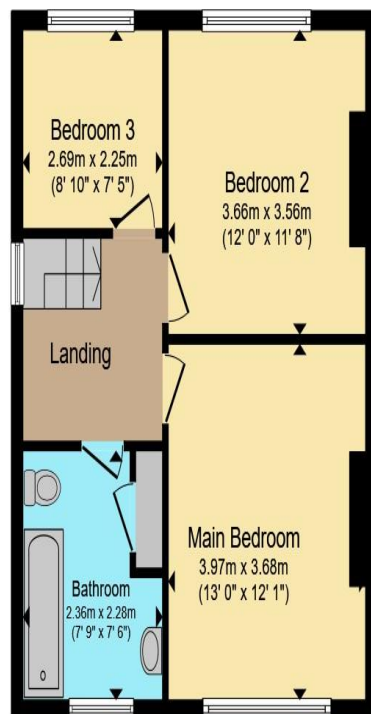

**First Floor**

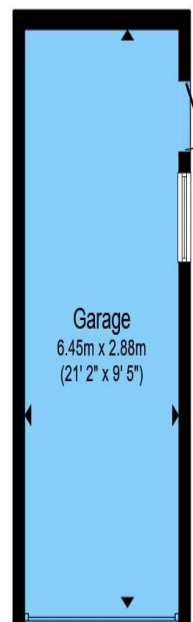

**Garage**

Total floor area 135.2 m<sup>2</sup> (1,455 sq.ft.) approx

This floor plan is for illustrative purposes only. It is not drawn to scale. Any measurements, floor areas (including any total floor area), openings and orientation are approximate. No details are guaranteed, they cannot be relied upon for any purpose and they do not form part of any agreement. No liability is taken for any error, omission or misstatement. A party must rely upon its own inspection(s). Powered by [www.propertybox.io](http://www.propertybox.io)

**Sharman  
Quinney**

To view this property call Sharman Quinney on:  
**01733 897896**

# Selling your property?

Contact us to arrange a **FREE** home valuation.

 01733 897896

 70 Albert Place, PETERBOROUGH,  
Cambridgeshire, PE1 1DD

 peterborough@sharmanquinney.co.uk

 [www.sharmanquinney.co.uk](http://www.sharmanquinney.co.uk)



 SCAN ME



Sharman Quinney Holdings Limited is registered in England and Wales under company number 4174227, Registered Office is Cumbria House, 16-20 Hockliffe Street, Leighton Buzzard, Bedfordshire, LU7 1GN. VAT Registration Number is 500 2481 05.

1: These particulars do not constitute part or all of an offer or contract. 2: The measurements indicated are supplied for guidance only and as such must be considered incorrect. 3: Potential buyers are advised to recheck the measurements before committing to any expense. 4: Sharman Quinney has not tested any apparatus, equipment, fixtures, fittings or services and it is the buyers interests to check the working condition of any appliances. 5: Sharman Quinney has not sought to verify the legal title of the property and buyers must obtain verification from their legal representative. 6: Intending purchasers will be asked to produce identification documentation at a later stage and we would ask your co-operation in order that there will be no delay in agreeing the sale. Ref: PTB207380 - 0002

