



Ellindon, Bretton Peterborough
£110,000 Leasehold

**Sharman
Quinney**

Key Features



125 Years remaining as of 09 Feb 2004

£10.00 Ground Rent pcm

Review due: Ask Agent

£250.00 Service Charge pcm

Review due: Ask Agent

- One Double Bedroom
- Spacious Lounge
- Bathroom
- Close to Local Amenities
- First Floor Maisonette

Entrance Hall

First Floor

Storage/Cupboard 9'7 x 3'5

Lounge 14'0 x 10'6



Kitchen 12'5 x 4'5

Bedroom 14'0 x 9'8

Bathroom



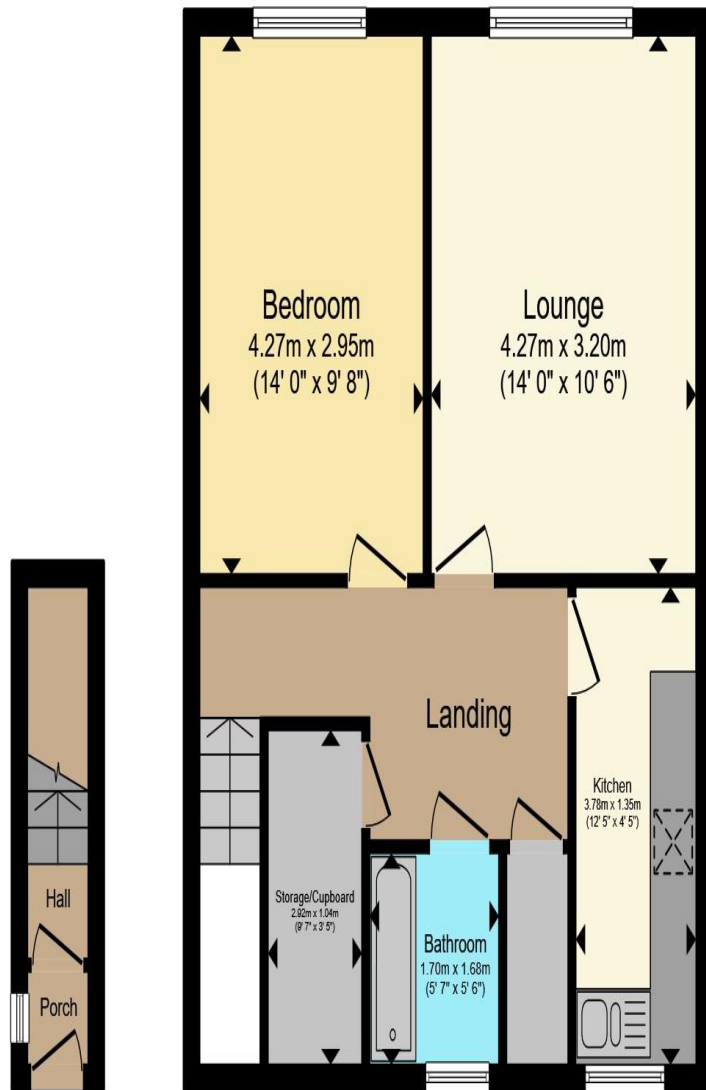

Ground Floor

First Floor

Total floor area 56.3 m² (606 sq.ft.) approx

This floor plan is for illustrative purposes only. It is not drawn to scale. Any measurements, floor areas (including any total floor area), openings and orientation are approximate. No details are guaranteed, they cannot be relied upon for any purpose and they do not form part of any agreement. No liability is taken for any error, omission or misstatement. A party must rely upon its own inspection(s). Powered by www.propertybox.io

Sharman
Quinney

To view this property call Sharman Quinney on:
01733 897896

Selling your property?

Contact us to arrange a **FREE** home valuation.

 01733 897896

 70 Albert Place, PETERBOROUGH,
Cambridgeshire, PE1 1DD

 peterborough@sharmanquinney.co.uk

 www.sharmanquinney.co.uk



 SCAN ME



Sharman Quinney Holdings Limited is registered in England and Wales under company number 4174227, Registered Office is Cumbria House, 16-20 Hockliffe Street, Leighton Buzzard, Bedfordshire, LU7 1GN. VAT Registration Number is 500 2481 05.

1: These particulars do not constitute part or all of an offer or contract. 2: The measurements indicated are supplied for guidance only and as such must be considered incorrect. 3: Potential buyers are advised to recheck the measurements before committing to any expense. 4: Sharman Quinney has not tested any apparatus, equipment, fixtures, fittings or services and it is the buyers interests to check the working condition of any appliances. 5: Sharman Quinney has not sought to verify the legal title of the property and buyers must obtain verification from their legal representative. 6: Intending purchasers will be asked to produce identification documentation at a later stage and we would ask your co-operation in order that there will be no delay in agreeing the sale. Ref: :PTB207301 - 0001