



Bath Road, Eye, Peterborough
OIEO £280,000 Freehold

**Sharman
Quinney**

Key Features



- En-suite
- Off road parking
- Separate Utility room
- Four bedrooms
- Dining room

Accommodation Includes:

Ground Floor

PVCu double part glazed entrance door to:

Entrance Hallway

Radiator, built in under stairs storage cupboard, doors to:

Lounge

3.25m x 4.62m (10'8" x 15'2" maximum).PVCu double glazed window, PVCu double glazed double doors leading out to garden, radiator.

Dining Room

3.14m x 2.71m (10'4" x 8'11" maximum).PVCu double glazed window to front, radiator.



Kitchen/Breakfast

4.36m x 2.59m (14'4" x 8'6" maximum). Fitted with a matching range of wall and base units with worktops, built in breakfast bar, stainless steel sink with mixer tap, space for fridge freezer & electric oven, four ring gas hob with extractor hood over, integrated dishwasher, tiled floor, radiator, PVCu double glazed window to front.

Utility Room

2.00m x 1.62m (6'7" x 5'4" maximum). Fitted with a matching range of wall and base units with workspace over, plumbing for washing machine and space for tumble drier, tiled flooring.

Cloakroom

Fitted two piece suite comprising low level WC, wash hand basin, PVCu double glazed window to rear, radiator

Landing

Airing cupboard, loft access.

Bedroom One

2.92m x 2.71m (9'7" x 8'11" maximum). PVCu double glazed window to front, radiator, built in double wardrobe.

En-suite (requires fittings)

New/refurbished, space and plumbing for a three piece suite, radiator, PVCu double glazed window to front.



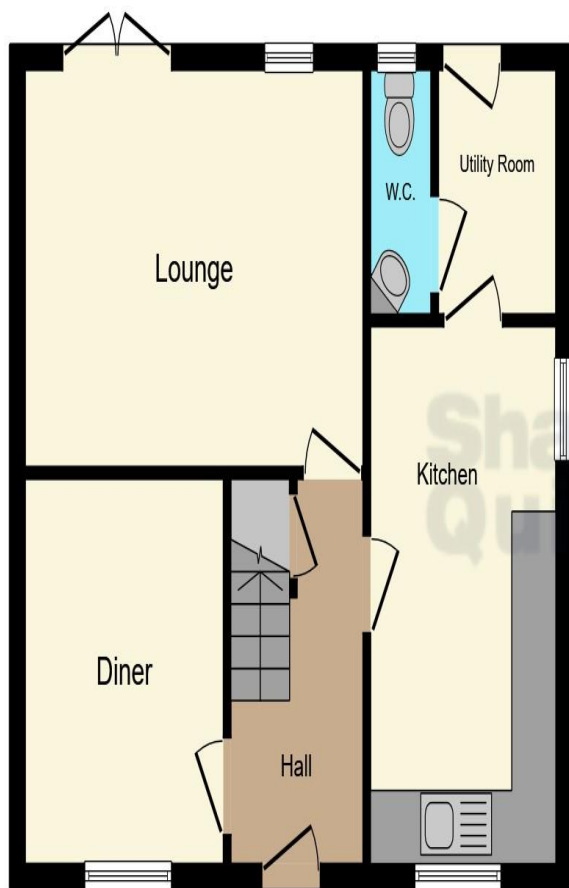

Ground Floor

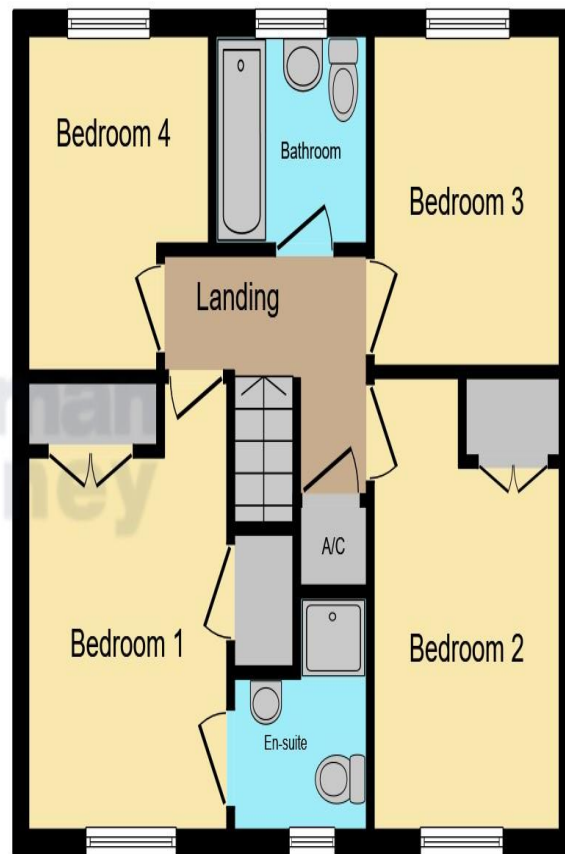

First Floor

Bedroom Two
 2.92m x 2.61m (9'7" x 8'7" into recess).PVCu double glazed window to front, radiator, built in double wardrobe.

Bedroom Three
 2.69m x 2.66m (8'10" x 8'9" maximum).PVCu double glazed window to rear, radiator.

Bedroom Four
 2.66m x 2.43m (8'9" x 8'0" maximum).PVCu double glazed window to rear, radiator.

Bathroom
 New/refurbished, fitted with a three piece suite comprising bath with shower over, pedestal wash hand basin, low level WC, PVCu double glazed window to rear, radiator.

Outside
 The rear garden is enclosed and mainly laid to lawn with a patio, off road parking to front.

This floor plan is for illustrative purposes only. It is not drawn to scale. Any measurements, floor areas (including any total floor area), openings and orientation are approximate. No details are guaranteed, they cannot be relied upon for any purpose and they do not form part of any agreement. No liability is taken for any error, omission or misstatement. A party must rely upon its own inspection(s). Powered by www.focalagent.com

To view this property call Sharman Quinney on:
01733 897896

Selling your property?

Contact us to arrange a **FREE** home valuation.

 01733 897896

 70 Albert Place, PETERBOROUGH,
Cambridgeshire, PE1 1DD

 peterborough@sharmanquinney.co.uk

 www.sharmanquinney.co.uk



 SCAN ME



Sharman Quinney Holdings Limited is registered in England and Wales under company number 4174227, Registered Office is Cumbria House, 16-20 Hockliffe Street, Leighton Buzzard, Bedfordshire, LU7 1GN. VAT Registration Number is 500 2481 05.

1: These particulars do not constitute part or all of an offer or contract. 2: The measurements indicated are supplied for guidance only and as such must be considered incorrect. 3: Potential buyers are advised to recheck the measurements before committing to any expense. 4: Sharman Quinney has not tested any apparatus, equipment, fixtures, fittings or services and it is the buyers interests to check the working condition of any appliances. 5: Sharman Quinney has not sought to verify the legal title of the property and buyers must obtain verification from their legal representative. 6: Intending purchasers will be asked to produce identification documentation at a later stage and we would ask your co-operation in order that there will be no delay in agreeing the sale. Ref: PTB206510 - 0004

